

No.	Revision	Date
10		
9		
8		
7		
6		
5		
4		
3		
2	REVISED PARKING LAYOUT	8/21/2018
1	REVISE PARKING LOCATION PER LFD	8/6/18

Scale: 1"=20'
0' 10' 20' 40'

Date: July 6, 2018

SITE PLAN DRIVE
#160 MOULTON DRIVE
BALI HAI
LYNNFIELD, MASS.

C1

ZONING TABLE		
ZONE	SINGLE RESIDENCE A	
DIMENSIONAL CONTROLS	REQUIRED/ALLOWED	PROPOSED
FRONT SETBACK TO CENTERLINE	50 ft.	150± ft.
FRONT YARD SETBACK	30 ft.	130± ft.
SIDE YARD SETBACK	15 ft.	18± ft.
REAR YARD SETBACK	20 ft.	21 ±ft.
MIN. FRONTAGE	110 ft.	259± ft.
MIN. LOT AREA	15,000 s.f.	81,000± s.f.
MAX. BUILDING HEIGHT	40 ft.	± ft.
MAX. LOT COVERAGE (bldgs.)	35%	17±%
PARKING	--	56 spaces

EXISTING IMPERVIOUS AREA = 58,534 S.F. (72%)
PROPOSED IMPERVIOUS AREA = 41,584 S.F. (51%)
CHANGE IN IMPERVIOUSNESS = -16,950 S.F.

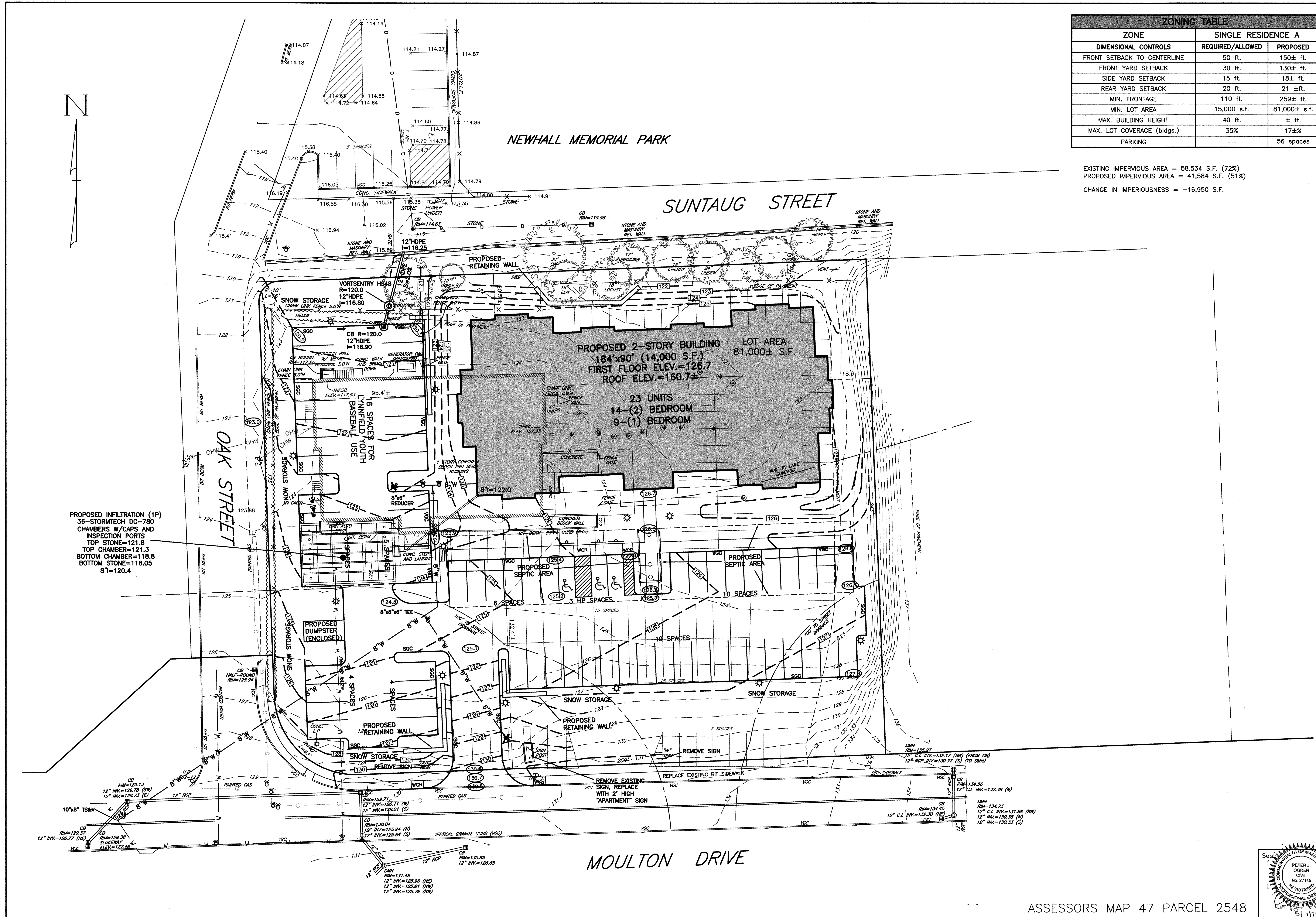

PROPOSED INFILTRATION (1P)
36-STORMTECH DC-780
CHAMBERS W/CAPS AND
INSPECTION PORTS
TOP STONE=121.8
TOP CHAMBER=121.3
BOTTOM CHAMBER=118.8
BOTTOM STONE=118.05
8'±=120.4

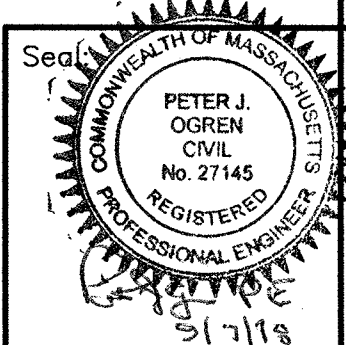

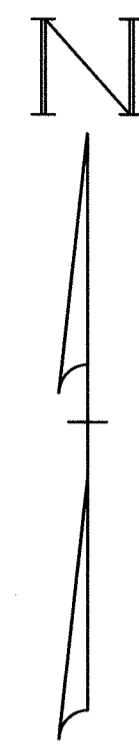

NEWHALL MEMORIAL PARK

SUNTAUG STREET

LOT AREA
81,000± S.F.

MOULTON DRIVE

NORTHERN CIRCUMFERENTIAL HIGHWAY
(ROUTE 128 - 1959 STATE HIGHWAY ALTERATION)

ZONE: SINGLE RESIDENCE A (RA)

MINIMUM SETBACKS:
FRONT = 30'
SIDE = 15'
REAR = 20'

MIN. FRONTAGE=110'
MIN. LOT AREA=15,000 S.F.

Prepared For:

Owner / Applicant
Top Tier Properties
93 Maple Street
Malden, MA 02148

Prepared By:

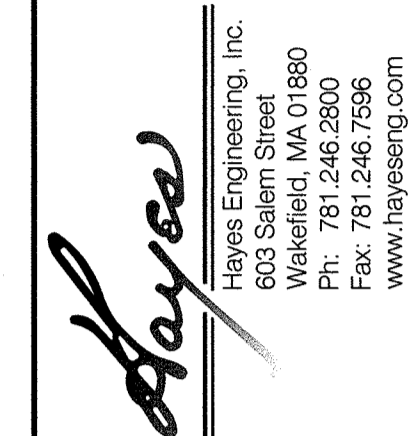

Design By: PJO
Drawn By: EBL
Checked By: PJO
Project File: LYF-0934A
Comp. No: LYF365
 Issued For Permit
 Issued For Review
 Issued For Bid
 Issued For Construction
 Not For Construction

No.	Revision	Date
10		
9		
8		
7		
6		
5		
4		
3		
2		
1		

Scale: 1"=20'
0' 10' 20' 40'
Date: July 6, 2018

Drawing Title:

EXISTING CONDITIONS PLAN
MOULTON DRIVE
LYNNFIELD, MASS.

Drawing No.:

C2

SHEET 2 OF 4

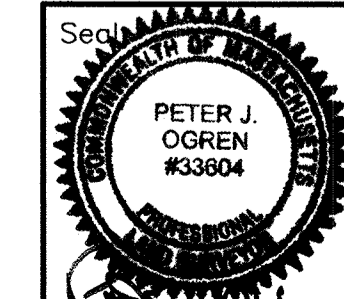

7/11/18

M:\LYF365\SP160\Moulton.dwg, 7/10/2018 8:38:27 AM, TC

Owner / Applicant
Top Tier Properties
95 Maple Street
Malden, MA 02148

Hayes Engineering, Inc.
603 Salem Street
Wakefield, MA 01880
Ph: 781.246.2800
Fax: 781.246.7596
www.hayeseng.com

Design By: PJO
Drawn By: EBL
Checked By: PJO
Project File: LYF-0934A
Comp. No: LYF365
 Issued For Permit
 Issued For Review
 Issued For Bid
 Issued For Construction
 Not For Construction

No.	Revision	Date
10		
9		
8		
7		
6		
5		
4		
3		
2		
1		

Scale: 1"=20'
0' 10' 20' 40'
Date: July 6, 2018

Drawing Title:
PHOTOMETRICS PLAN
#160 MOULTON DRIVE
BALI HAI
LYNNFIELD, MASS.

Drawing No.:
C3
SHEET 3 OF 4

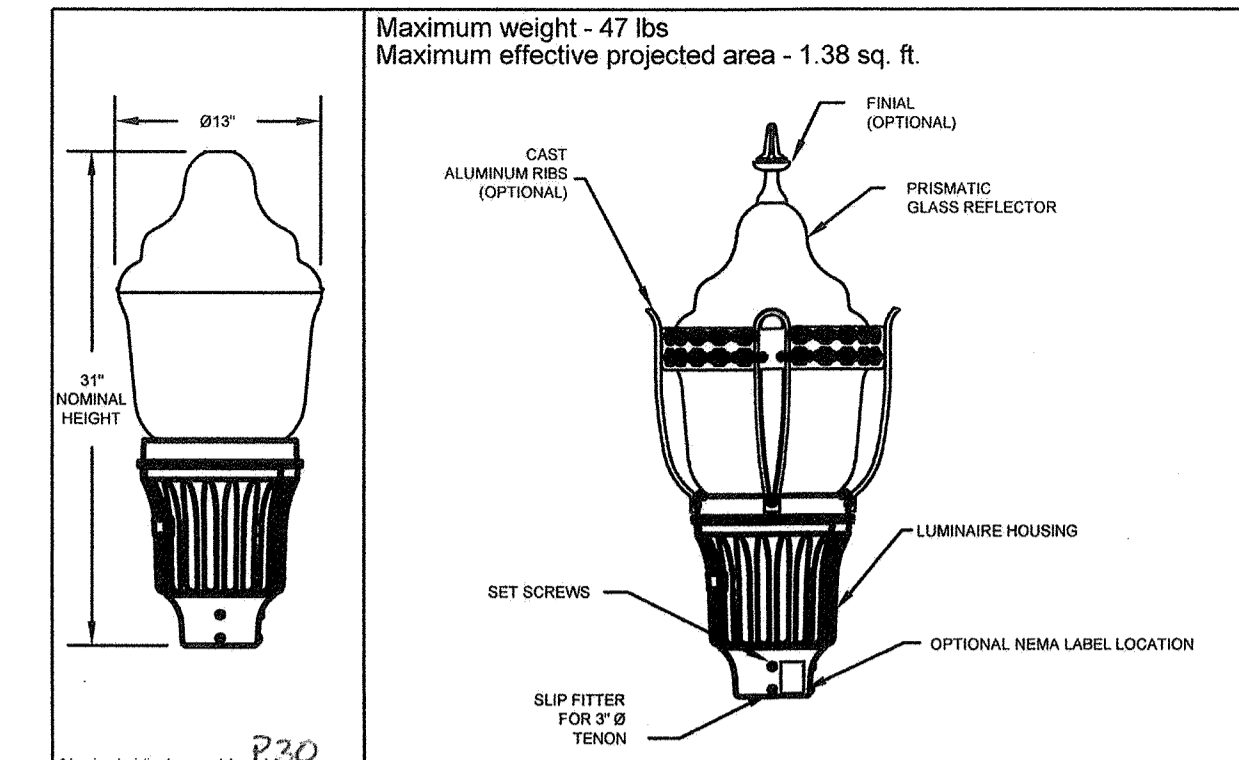
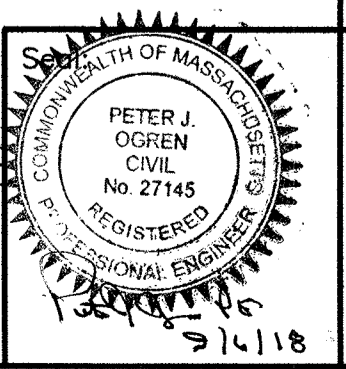

ORDERING INFORMATION:

HOUSING: GVD2 P30 30K AS M BZ 5 R S BZ

HOUSING COLORS: BZ = BRONZE, GR = GRAPHITE, WH = WHITE, TR = TRIM, etc.

OPTIONS: CONTROLS OPTIONS, ACCESSORIES, etc.

NOTES ARE LOCATED ON PAGE 3

Target Point Set
1321 points at z=0, sp 10ft by 10ft

HORIZONTAL FOOTCANDLES

Average: 2.5
Maximum: 0.3
Minimum: 0.0
Avg/Min: N/A
Max/Min: N/A
Coef Var: 1.62
UniGrad: N/A

GV1 Holophane GVD2 P30 30K AS 3 N F GVDHSS18
SCALED PHOTOMETRY test report no. ISF 33910P16

GV2 Holophane GPD2 P30 30K AS 5 N
SCALED PHOTOMETRY test report no. ISF 30285P3

NEWHALL MEMORIAL PARK

SUNTAUG STREET

OAK STREET

MOULTON DRIVE

NORTHERN CIRCUMFERENTIAL HIGHWAY
(ROUTE 128 - 1959 STATE HIGHWAY ALTERATION)

ASSASSORS MAP 47 PARCEL 2548

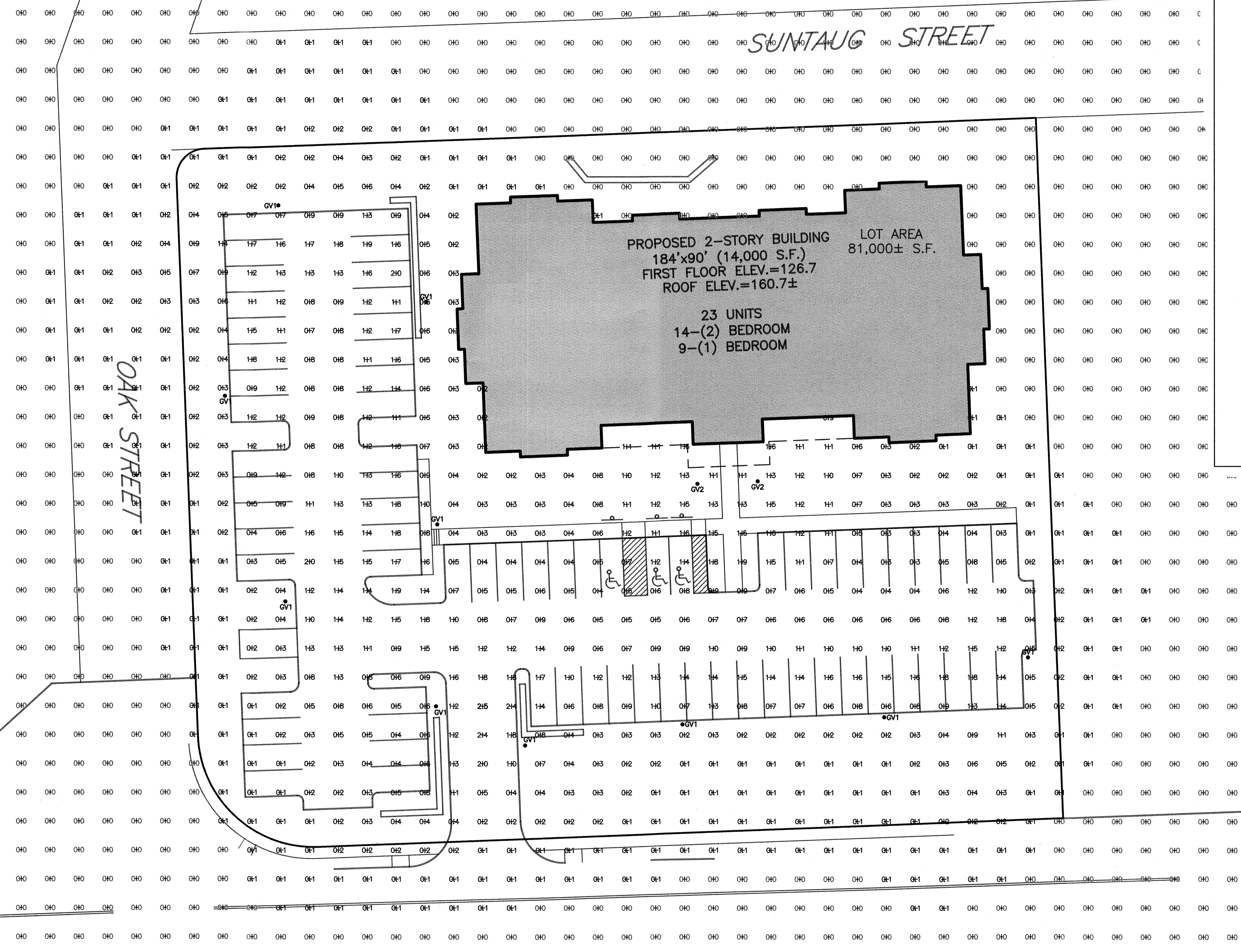
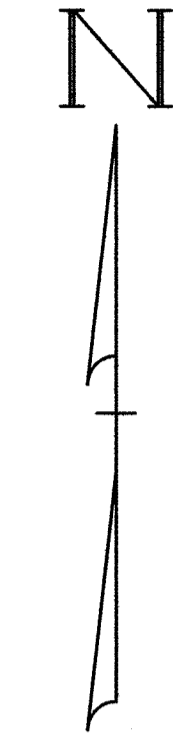

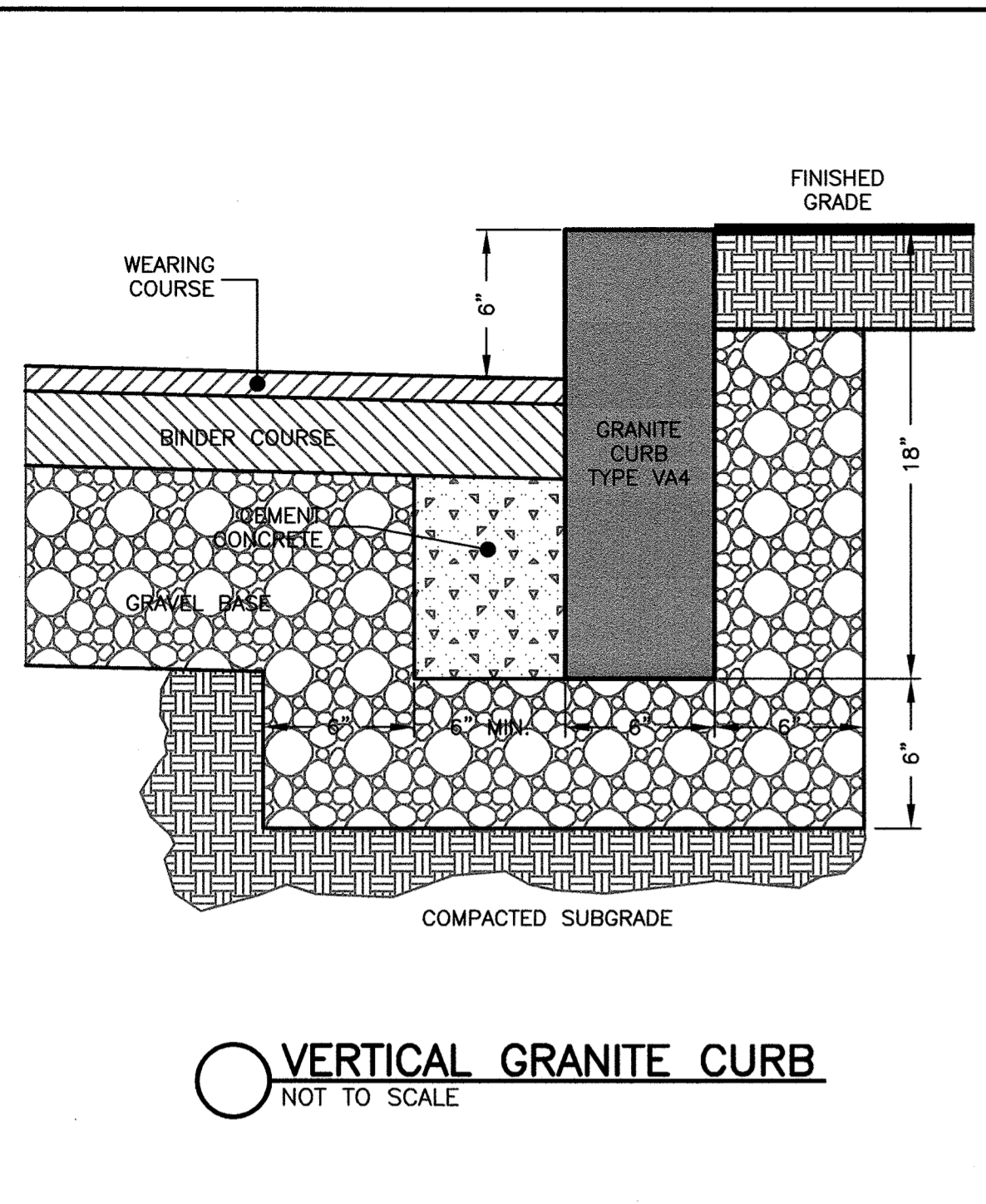

VERTICAL GRANITE CURB
NOT TO SCALE

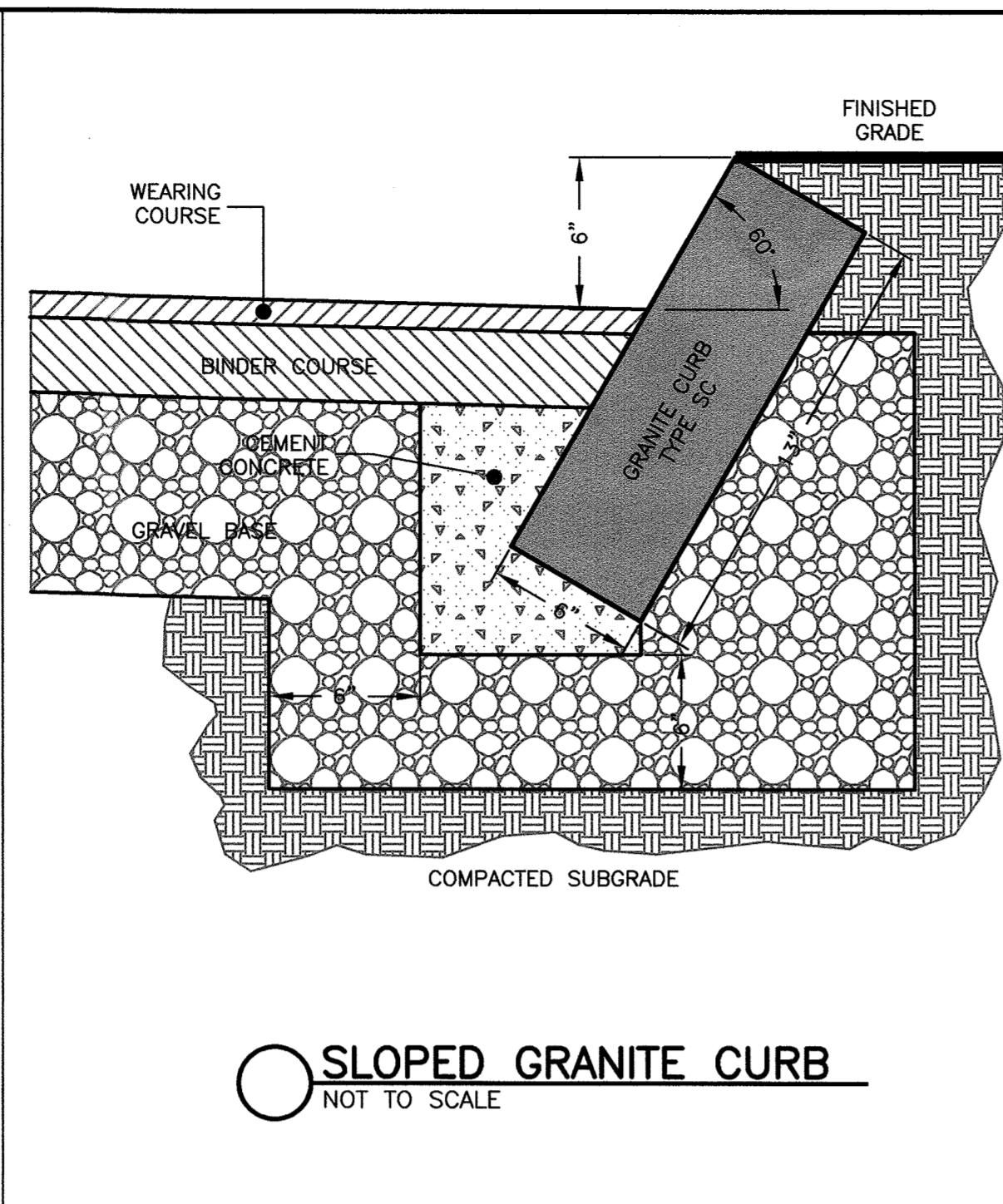

SLOPED GRANITE CURB
NOT TO SCALE

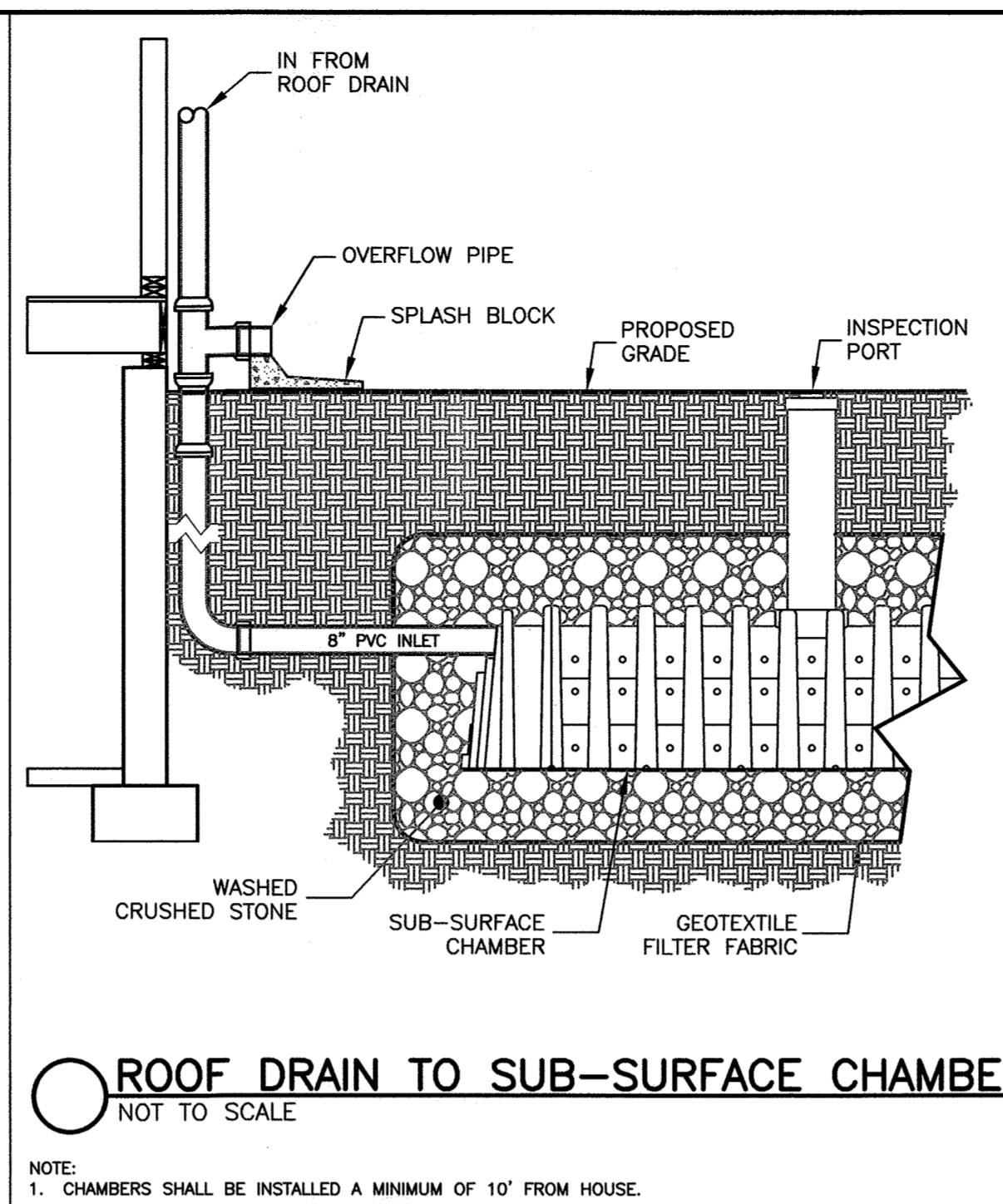

ROOF DRAIN TO SUB-SURFACE CHAMBER
NOT TO SCALE

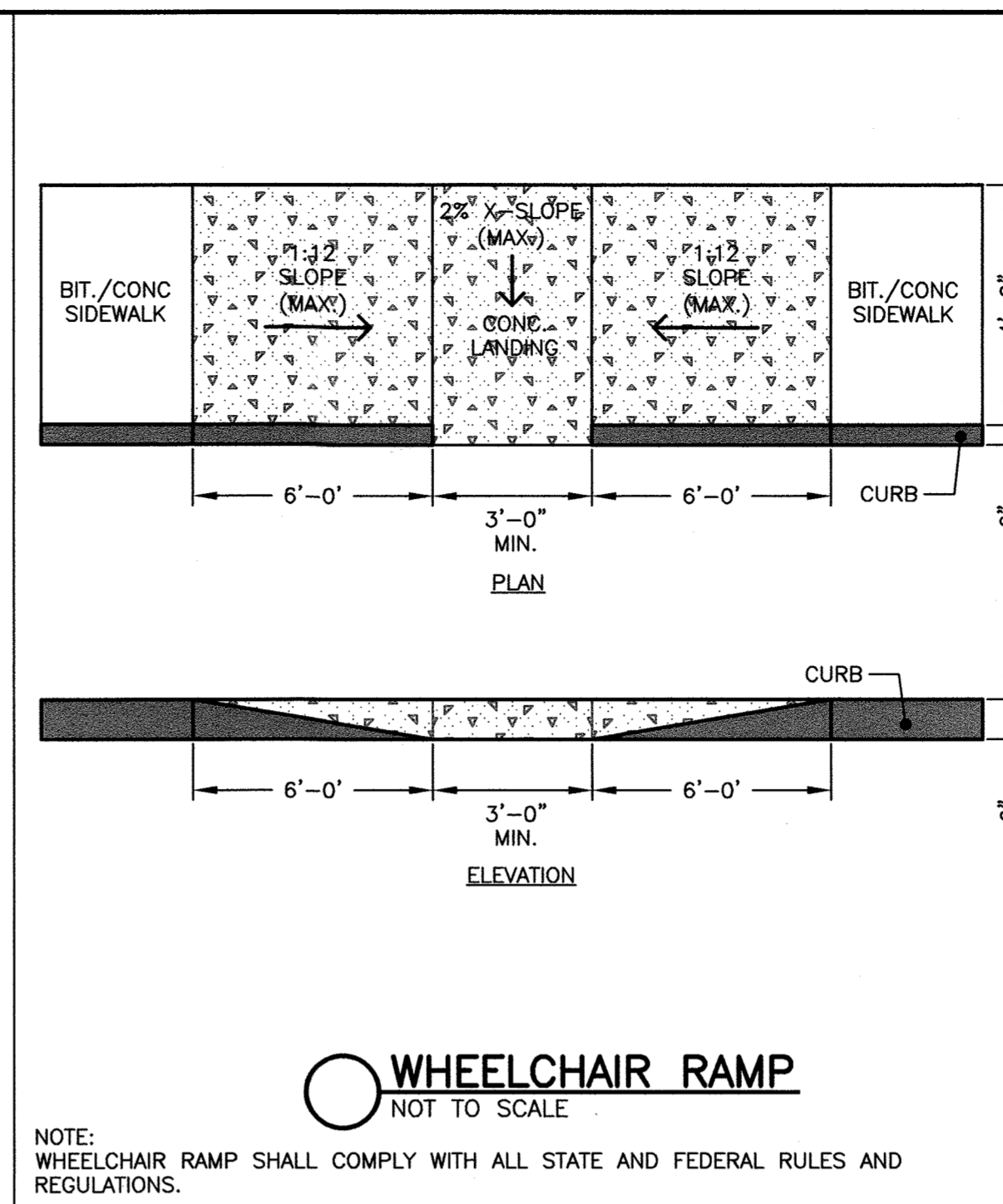

WHEELCHAIR RAMP
NOT TO SCALE

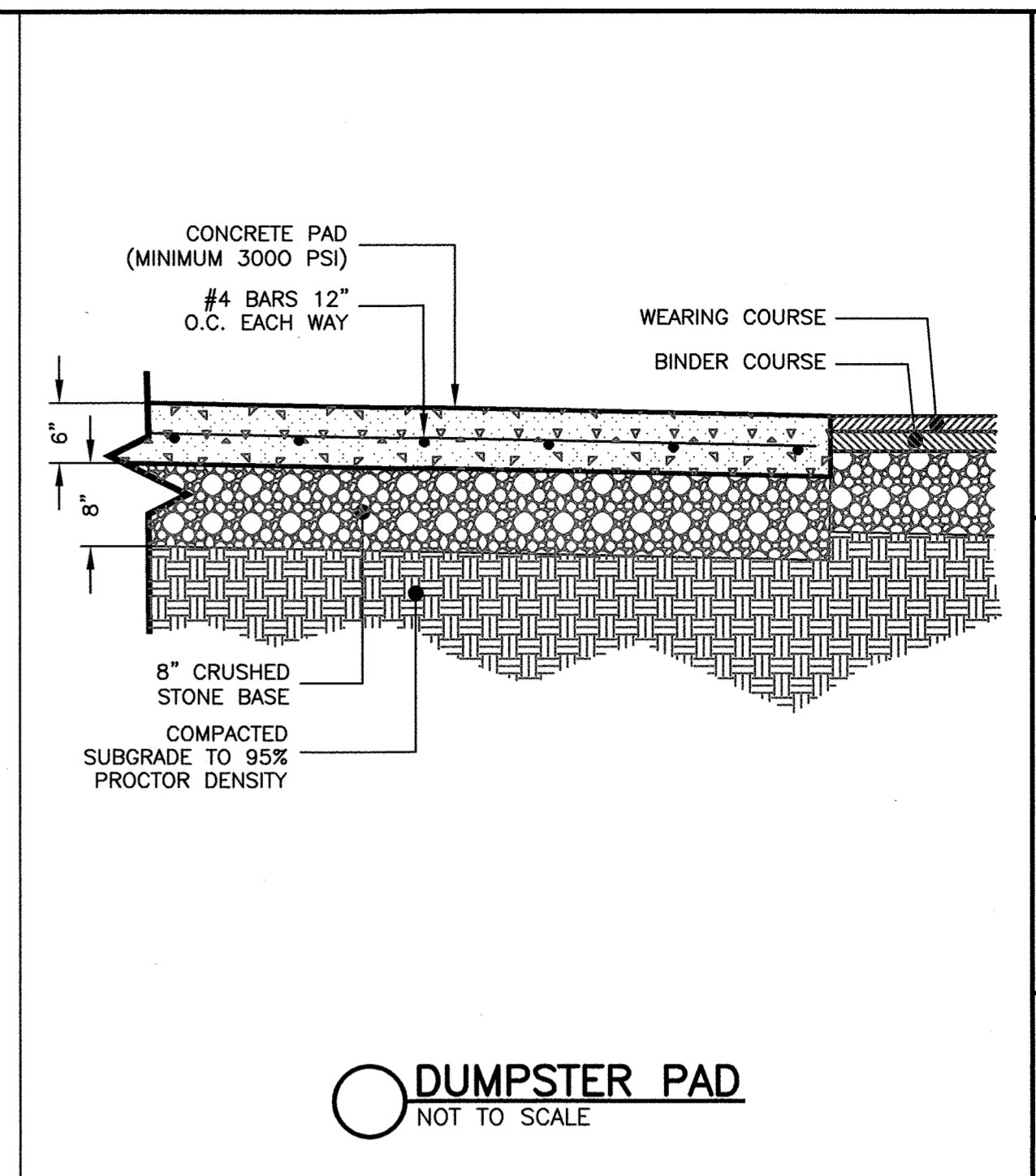

DUMPSTER PAD
NOT TO SCALE

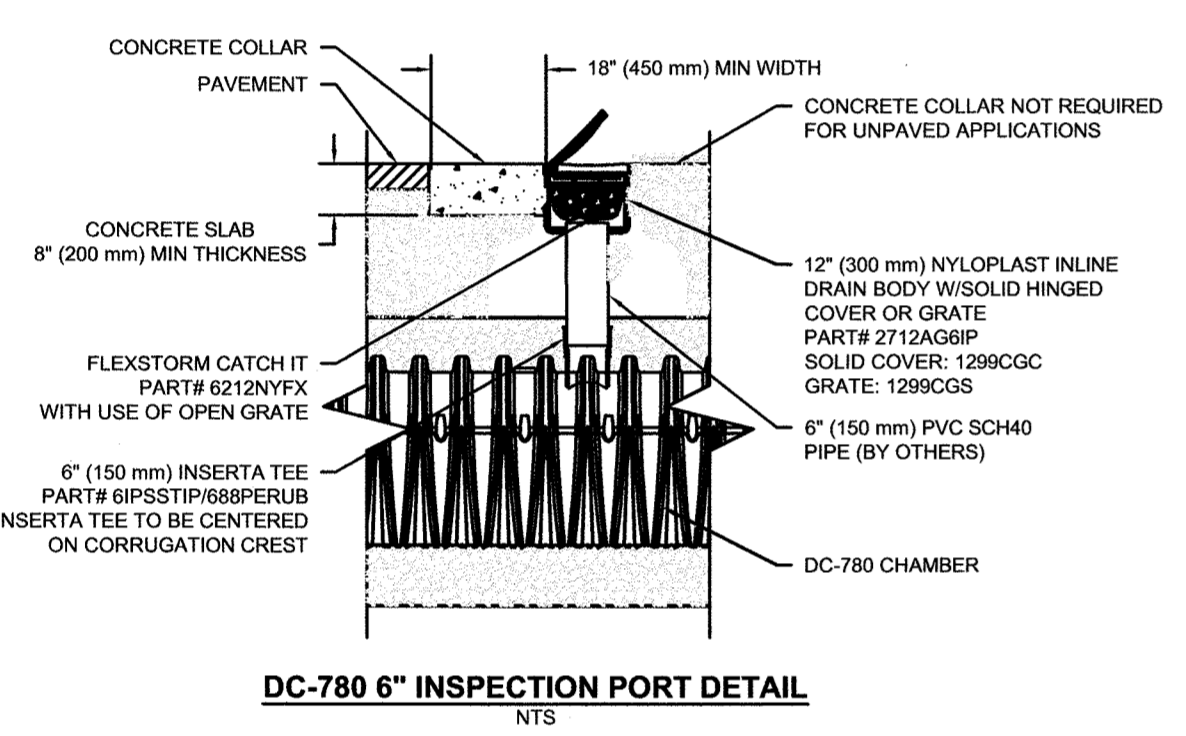

DC-780 6" INSPECTION PORT DETAIL
NOT TO SCALE

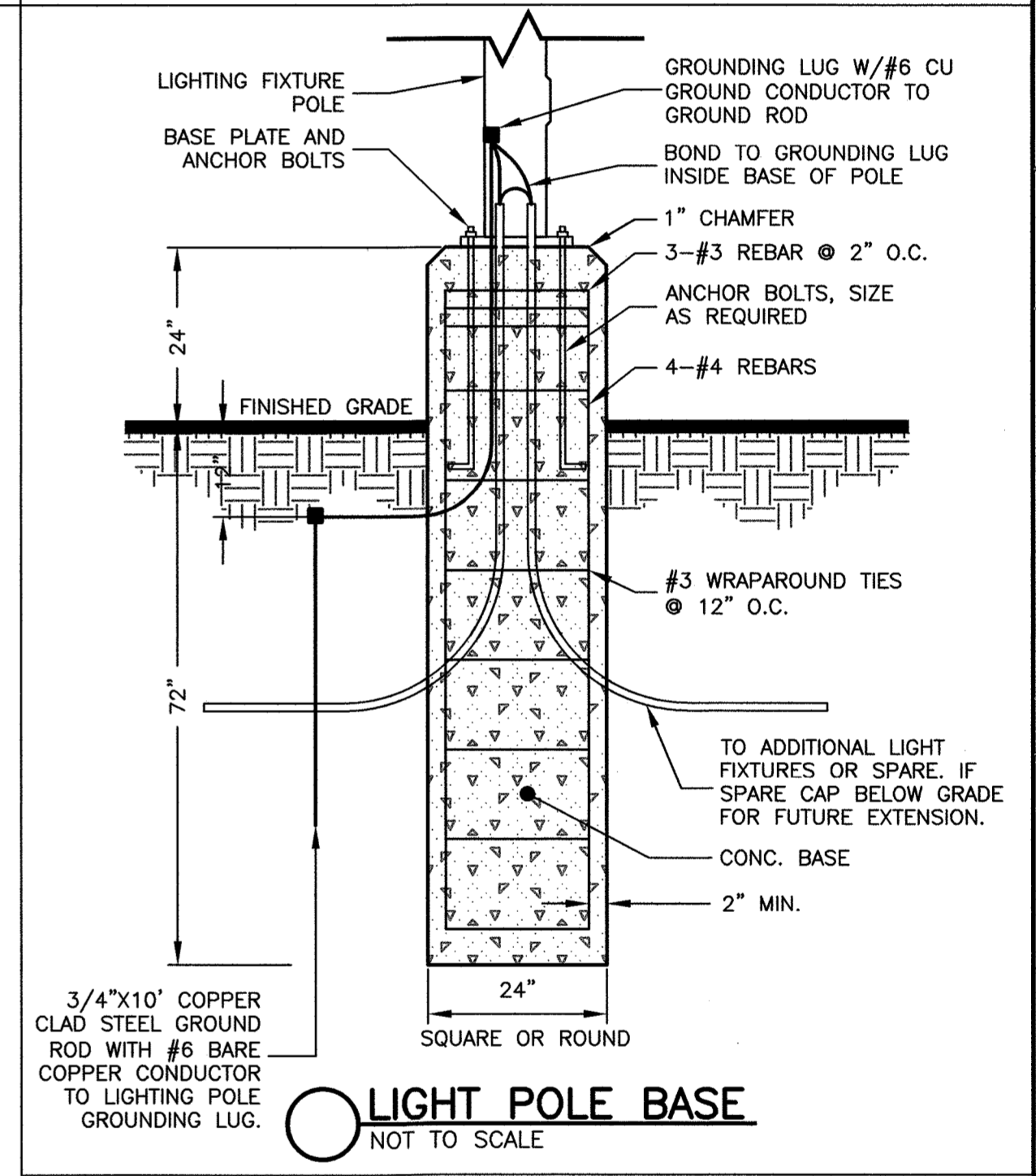

LIGHT POLE BASE
NOT TO SCALE

ACCEPTABLE FILL MATERIALS: STORMTECH DC-780 CHAMBER SYSTEMS

MATERIAL LOCATION	DESCRIPTION	AASHTO MATERIAL CLASSIFICATIONS	COMPACTION / DENSITY REQUIREMENT
D	FINAL FILL: FILL MATERIAL FOR LAYER 'D' STARTS FROM THE TOP OF THE 'C' LAYER TO THE BOTTOM OF FLEXIBLE PAVEMENT OR UNPAVED FINISHED GRADE ABOVE. NOTE THAT PAVEMENT SUBBASE MAY BE PART OF THE 'D' LAYER.	N/A	PREPARE PER SITE DESIGN ENGINEER'S PLANS. PAVED INSTALLATIONS MAY HAVE STRINGENT MATERIAL AND PREPARATION REQUIREMENTS.
C	INITIAL FILL: FILL MATERIAL FOR LAYER 'C' STARTS FROM THE TOP OF THE EMBEDMENT STONE ('B' LAYER) TO 18" (450 mm) ABOVE THE TOP OF THE CHAMBER. NOTE THAT PAVEMENT SUBBASE MAY BE A PART OF THE 'C' LAYER.	AASHTO M145 ¹ A-1, A-2.4, A-3 OR AASHTO M43 ¹ 3, 357, 4, 467, 5, 56, 57, 6, 67, 68, 7, 78, 8, 89, 9, 10	BEGIN COMPACTIONS AFTER 12" (300 mm) OF MATERIAL OVER THE CHAMBERS IS REACHED. COMPACT ADDITIONAL LAYERS IN 6" (150 mm) MAX LIFTS TO A MIN. 95% PROCTOR DENSITY FOR WELL GRADED MATERIAL AND 95% RELATIVE DENSITY FOR PROCESSED AGGREGATE MATERIALS. ROLLER GROSS VEHICLE WEIGHT NOT TO EXCEED 12,000 lbs (53 kN) DYNAMIC FORCE NOT TO EXCEED 20,000 lbs (89 kN).
B	EMBEDMENT STONE: FILL SURROUNDING THE CHAMBERS FROM THE FOUNDATION STONE ('A' LAYER) TO THE 'C' LAYER ABOVE.	AASHTO M43 ¹ 3, 357, 4, 467, 5, 56, 57	NO COMPACTION REQUIRED.
A	FOUNDATION STONE: FILL BELOW CHAMBERS FROM THE SUBGRADE UP TO THE FOOT (BOTTOM) OF THE CHAMBER.	AASHTO M43 ¹ 3, 357, 4, 467, 5, 56, 57	PLATE COMPACT OR ROLL TO ACHIEVE A FLAT SURFACE. ^{2,3}

PLEASE NOTE:
 1. THE LISTED AASHTO DESIGNATIONS ARE FOR GRADATIONS ONLY. THE STONE MUST ALSO BE CLEAN, CRUSHED, ANGULAR. FOR EXAMPLE, A SPECIFICATION FOR #4 STONE WOULD STATE: "CLEAN, CRUSHED, ANGULAR NO. 4 (AASHTO M43) STONE."
 2. STORMTECH COMPACTION REQUIREMENTS ARE MET FOR 'A' LOCATION MATERIALS WHEN PLACED AND COMPACTED IN 9" (230 mm) (MAX) LIFTS USING TWO FULL COVERAGES WITH A VIBRATORY COMPACTOR.
 3. WHERE INFILTRATION SURFACES MAY BE COMPROMISED BY COMPACTION, FOR STANDARD DESIGN LOAD CONDITIONS, A FLAT SURFACE MAY BE ACHIEVED BY RAKING OR DRAGGING WITHOUT COMPACTION EQUIPMENT. FOR SPECIAL LOAD DESIGNS, CONTACT STORMTECH FOR COMPACTION REQUIREMENTS.

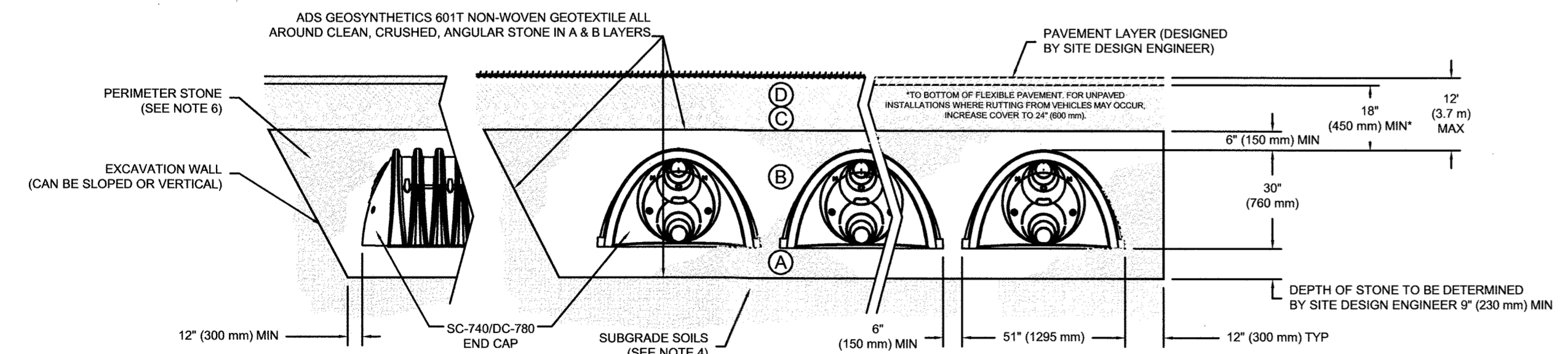

- NOTES:**
- DC-780 CHAMBERS SHALL CONFORM TO THE REQUIREMENTS OF ASTM F2418 "STANDARD SPECIFICATION FOR POLYPROPYLENE (PP) CORRUGATED WALL STORMWATER COLLECTION CHAMBERS".
 - DC-780 CHAMBERS SHALL BE DESIGNED IN ACCORDANCE WITH ASTM F2787 "STANDARD PRACTICE FOR STRUCTURAL DESIGN OF THERMOPLASTIC CORRUGATED WALL STORMWATER COLLECTION CHAMBERS".
 - "ACCEPTABLE FILL MATERIALS" TABLE ABOVE PROVIDES MATERIAL LOCATIONS, DESCRIPTIONS, GRADATIONS, AND COMPACTION REQUIREMENTS FOR FOUNDATION, EMBEDMENT, AND FILL MATERIALS.
 - THE SITE DESIGN ENGINEER IS RESPONSIBLE FOR ASSESSING THE BEARING RESISTANCE (ALLOWABLE BEARING CAPACITY) OF THE SUBGRADE SOILS AND THE DEPTH OF FOUNDATION STONE WITH CONSIDERATION FOR THE RANGE OF EXPECTED SOIL MOISTURE CONDITIONS.
 - PERIMETER STONE MUST BE EXTENDED HORIZONTALLY TO THE EXCAVATION WALL FOR BOTH VERTICAL AND SLOPED EXCAVATION WALLS.
 - ONCE LAYER 'C' IS PLACED, ANY SOIL/MATERIAL CAN BE PLACED IN LAYER 'D' UP TO THE FINISHED GRADE. MOST PAVEMENT SUBBASE SOILS CAN BE USED TO REPLACE THE MATERIAL REQUIREMENTS OF LAYER 'C' OR 'D' AT THE SITE DESIGN ENGINEER'S DISCRETION.

DC-780 STANDARD CROSS SECTION
 DRAWN: JLM
 CHECKED: JLM
 DATE: 11/18/14
 PROJECT #:
 StormTech
 4640 REGAN BLVD
 WILMINGTON, MA 01897
 1-800-733-7473
 SHEET 1 OF 1

Prepared For:
 Owner / Applicant
 Top Tier Properties
 93 Maple Street
 Malden, MA 02148

Prepared By:
 Hayes Engineering, Inc.
 1000 State Street
 Woburn, MA 01890
 Ph: 781.246.2800
 Fax: 781.246.7596
 www.hayeseng.com

Design By: PJO
 Drawn By: EBL
 Checked By: PJO
 Project File: LYF-0934A
 Comp. No: LYF365

Issued For Permit
 Issued For Review
 Issued For Bid
 Issued For Construction
 Not For Construction

No.	Revision	Date
10		
9		
8		
7		
6		
5		
4		
3		
2		
1		

Scale: 1"=N.T.S.
 Date: July 6, 2018

Drawing Title:
DETAIL SHEET
#160 MOULTON DRIVE
BALI HAI
LYNNFIELD, MASS.

Drawing No.:
C4

SHEET 4 OF 4

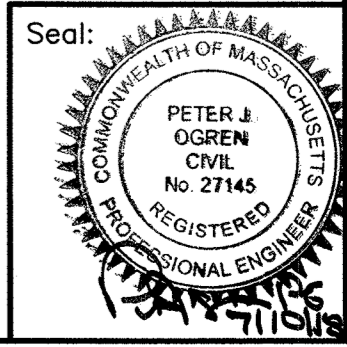

M:\LYF365\SP160\moulton.dwg, 7/10/2018 8:35:14 AM, TC