

**GRADING LEGEND**

- LIMIT OF WORK LINE
- 100 PROPOSED CONTOUR MAJOR LINE
- 112 PROPOSED CONTOUR MINOR LINE
- x (100.20) EXISTING SPOT GRADE, TO BE FIELD VERIFIED
- x 100.20 PROPOSED SPOT GRADE
- x HP/LP HIGH POINT/LOW POINT
- SINGLE CATCH BASIN
- DOUBLE CATCH BASIN
- AREA DRAIN

**GRADING NOTES**

- I. EXISTING CONDITIONS AND UTILITY INFORMATION FOR PHASE I IS REPRODUCED FROM THE AS-BUILT SURVEY PROVIDED BY GRANSHAW CONSTRUCTION OF NEWTON LOWER FALLS, MA AND IS DATED OCTOBER 17, 2003. EXISTING UTILITY INFORMATION FOR PHASE II IS REPRODUCED FROM THE AS-BUILT SURVEY PROVIDED BY GRANSHAW CONSTRUCTION OF NEWTON LOWER FALLS, MA AND IS DATED JUNE 1, 2011. EXISTING CONDITIONS MIGHT HAVE CHANGED ON SITE SINCE THE SURVEY; CONTRACTOR SHALL FIELD VERIFY CONDITIONS AND REPORT ANY DISCREPANCIES TO THE OWNER'S REPRESENTATIVE.
2. PRIOR TO THE START OF ANY EXCAVATION FOR THE PROJECT, BOTH ON AND OFF THE SITE, THE CONTRACTOR SHALL NOTIFY DIGSAFE AND BE PROVIDED WITH A DIGSAFE NUMBER INDICATING THAT ALL EXISTING UTILITIES HAVE BEEN LOCATED AND MARKED.
3. WHERE PROPOSED GRADES MEET EXISTING GRADES, CONTRACTOR SHALL BLEND GRADES TO PROVIDE A SMOOTH TRANSITION BETWEEN EXISTING AND NEW WORK. PONDING AT TRANSITION AREAS WILL NOT BE ALLOWED.
4. CONTRACTOR SHALL MAINTAIN POSITIVE DRAINAGE AWAY FROM ALL BUILDING FOUNDATIONS AND STRUCTURES.
5. MAXIMUM SLOPE IN DISTURBED AREAS SHALL NOT EXCEED 5:1, UNLESS OTHERWISE NOTED.
6. ENSURE ALL EXISTING (TO REMAIN), AND PROPOSED MANHOLE COVERS PROPERLY IDENTIFY UTILITY SERVICED.
7. CONTRACTOR SHALL VERIFY EXISTING GRADES AND NOTIFY OWNER'S REPRESENTATIVE OF ANY DISCREPANCIES.
8. ALL WALKWAYS AND HANDICAP PARKING SPACES SHALL COMPLY WITH THE MASSACHUSETTS ARCHITECTURAL ACCESS BOARD (AAB) AND THE AMERICANS WITH DISABILITIES ACT (ADA) ACCESSIBILITY GUIDELINES. IF FIELD CONDITIONS MAKE IT IMPOSSIBLE TO COMPLY WITH THESE GUIDELINES AND REGULATIONS, A WAIVER FROM THE AAB WILL BE SOUGHT.
9. BITUMINOUS CONCRETE ELEVATIONS AT CATCH BASINS TO BE 1/4 INCH ABOVE RIM ELEVATION SHOWN FOR CATCH.
10. CONTRACTOR TO ADJUST UTILITY ELEMENT HEANT TO BE FLUSH WITH GRADE (CLEAN-OUTS, UTILITY MANHOLES, CATCH BASINS, INLETS, ETC) THAT IS AFFECTED BY SITE WORK OR GRADE CHANGES, WHETHER SPECIFICALLY NOTED ON PLANS OR NOT.
- II. SCREENED IMAGES SHOW EXISTING CONDITIONS. WHERE EXISTING CONDITIONS LIE UNDER OR ARE IMPINGED UPON BY PROPOSED BUILDINGS AND/OR SITE ELEMENTS, THE EXISTING CONDITION WILL BE REMOVED, ABANDONED AND/OR CAPPED OR DEMOLISHED AS REQUIRED.

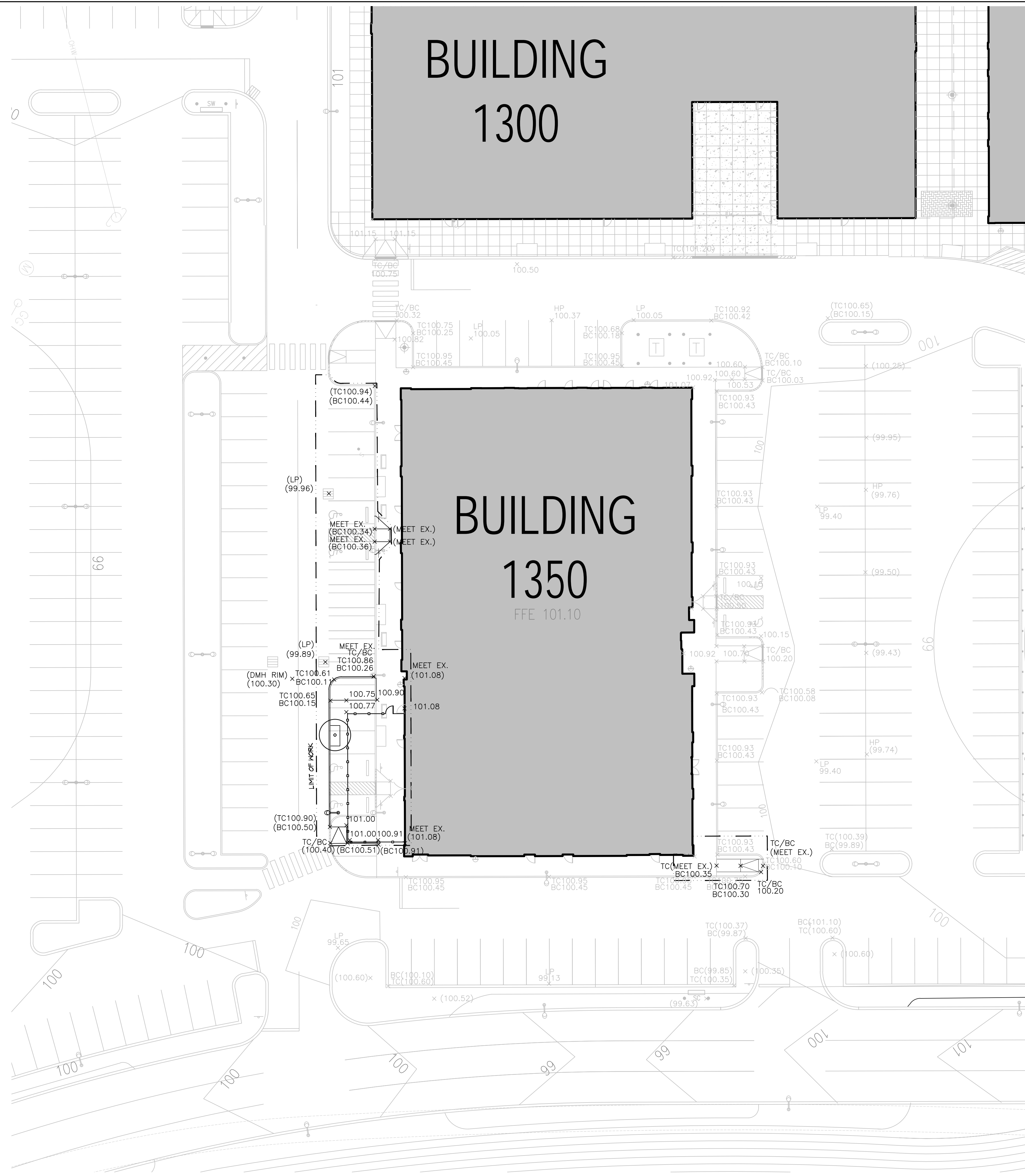

226 Causeway Street, 6th Floor  
 Boston, MA 02114  
 Tel: 617.523.8103  
 www.stantec.com

Copyright Reserved  
 The Contractor shall verify and be responsible for all dimensions. DO NOT scale the drawing - any errors or omissions shall be reported to Stantec without delay.  
 The Copyrights to all designs and drawings are the property of Stantec. Reproduction or use for any purpose other than that authorized by Stantec is forbidden.

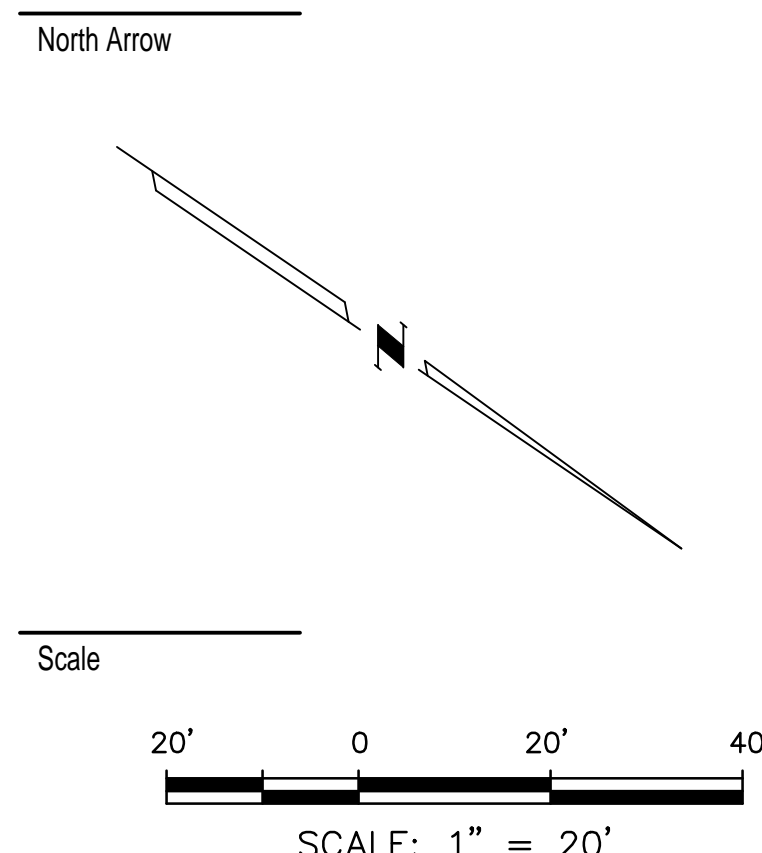

Keymap

MARKET STREET - PARKING ADJUSTMENT 02.12.21  
 Issued MM.DD.YY

File Name: 210801791-grading-parking.dwg  
 Dwn. Chkd. MM.DD.YY

Permit-Seal

Applicant/Project  
 Market Street South LLC  
 c/o National Development  
 2310 Washington Street  
 Newton Lower Falls, MA 02462  
 MARKET STREET LYNNFIELD  
 Lynnfield, MA  
 Title  
 GRADING PLAN  
 BUILDING 1350  
 PARKING ADJUSTMENT

Project No.  
 210800677

Drawing No.  
 L-200

Tuesday, February 16, 2021 8:20:20 PM \\us1239-f01\workgroup\210801791\design\drawing\current\210801791-grading-parking.dwg