



MARKETSTREET LYNNFIELD

MARKETSTREET LYNNFIELD

Lynnfield, MA

Planned Village Development District 40R Review Plans

Issued: January 18, 2008

Revised: May 2, 2008 - Approved Site Plans

Revised: February 1, 2011 - Approval of Minor Change

Revised: July 30, 2013 - Approval of Minor Change

Revised: April 28, 2014 - Approval of Minor Change

Revised: February 24, 2017 - Approval of Minor Change

Revised: July 18, 2018 - Request for Approval of Minor Change

LYNNFIELD PLANNING BOARD

DATE: _____

LIST OF DRAWINGS

	COVER SHEET	FEBRUARY 24, 2017	JULY 18, 2018
	DRAWING INDEX	FEBRUARY 24, 2017	JULY 18, 2018
LR-2.0	OVERALL LAYOUT AND MATERIALS PLAN	FEBRUARY 24, 2017	JULY 18, 2018
LR-2.1	LAYOUT AND MATERIALS PLAN	FEBRUARY 1, 2011	NO REVISION - INTENTIONALLY OMITTED
LR-2.2	LAYOUT AND MATERIALS PLAN	FEBRUARY 24, 2017	JULY 18, 2018
LR-2.3	LAYOUT AND MATERIALS PLAN	MAY 2, 2008	NO REVISION - INTENTIONALLY OMITTED
LR-2.4	LAYOUT AND MATERIALS PLAN	MAY 2, 2008	NO REVISION - INTENTIONALLY OMITTED
LR-2.5	LAYOUT AND MATERIALS PLAN	APRIL 28, 2014	NO REVISION - INTENTIONALLY OMITTED
LR-2.6	LAYOUT AND MATERIALS PLAN	FEBRUARY 1, 2011	NO REVISION - INTENTIONALLY OMITTED
LR-2.7	LAYOUT AND MATERIALS PLAN	MAY 2, 2008	NO REVISION - INTENTIONALLY OMITTED
LR-2.8	LAYOUT AND MATERIALS PLAN	FEBRUARY 1, 2011	NO REVISION - INTENTIONALLY OMITTED
LR-2.9	LAYOUT AND MATERIALS PLAN	MAY 2, 2008	INTENTIONALLY OMITTED WAKEFIELD HOTEL PARCEL
LR-2.10	LAYOUT AND MATERIALS PLAN	APRIL 28, 2014	NO REVISION - INTENTIONALLY OMITTED
LR-5.0A	OVERALL PLANTING PLAN	FEBRUARY 24, 2017	JULY 18, 2018
LR-5.0B	PLANTING PLAN NOTES AND LEGEND	FEBRUARY 1, 2011	NO REVISION - INTENTIONALLY OMITTED
LR-5.1	PLANTING PLAN	FEBRUARY 1, 2011	NO REVISION - INTENTIONALLY OMITTED
LR-5.2	PLANTING PLAN	FEBRUARY 24, 2017	JULY 18, 2018
LR-5.3	PLANTING PLAN	MAY 2, 2008	NO REVISION - INTENTIONALLY OMITTED
LR-5.4	PLANTING PLAN	MAY 2, 2008	NO REVISION - INTENTIONALLY OMITTED
LR-5.5	PLANTING PLAN	APRIL 28, 2014	NO REVISION - INTENTIONALLY OMITTED
LR-5.6	PLANTING PLAN	FEBRUARY 1, 2011	NO REVISION - INTENTIONALLY OMITTED
LR-5.7	PLANTING PLAN	MAY 2, 2008	NO REVISION - INTENTIONALLY OMITTED
LR-5.8	PLANTING PLAN	FEBRUARY 1, 2011	NO REVISION - INTENTIONALLY OMITTED
LR-5.9	PLANTING PLAN	MAY 2, 2008	INTENTIONALLY OMITTED WAKEFIELD HOTEL PARCEL
LR-5.10	PLANTING PLAN	APRIL 28, 2014	NO REVISION - INTENTIONALLY OMITTED
LR-6.0	SWALE ENLARGEMENT PLAN	FEBRUARY 1, 2011	NO REVISION - INTENTIONALLY OMITTED
LR-6.3	MAIN STREET SECTIONS	FEBRUARY 1, 2011	NO REVISION - INTENTIONALLY OMITTED
LR-8.0	OVERALL PHOTOMETRICS PLAN	FEBRUARY 1, 2011	INTENTIONALLY OMITTED
LR-8.1	PHOTOMETRICS PLAN	FEBRUARY 1, 2011	INTENTIONALLY OMITTED
LR-8.2	PHOTOMETRICS PLAN	FEBRUARY 24, 2017	JULY 18, 2018
LR-8.3	PHOTOMETRICS PLAN	FEBRUARY 1, 2011	INTENTIONALLY OMITTED
LR-8.4	PHOTOMETRICS PLAN	FEBRUARY 1, 2011	INTENTIONALLY OMITTED
LR-8.5	PHOTOMETRICS PLAN	FEBRUARY 1, 2011	INTENTIONALLY OMITTED
LR-9.0	INTERNAL TRAFFIC CONTROL PLAN	FEBRUARY 24, 2017	JULY 18, 2018
LR-10.0	SIGNAGE PLAN	APRIL 28, 2014	NO REVISION - INTENTIONALLY OMITTED
LR-11.0	PARKING SUMMARY PLAN	FEBRUARY 24, 2017	JULY 18, 2018
LR-12.0	REDLINED OVERALL LAYOUT & MATERIALS PLAN	FEBRUARY 24, 2017	JULY 18, 2018
LR-12.1	REDLINED MAIN STREET SECTIONS	FEBRUARY 1, 2011	NO REVISION - INTENTIONALLY OMITTED
A1.01	OVERALL SITE PLAN	APRIL 28, 2014	INTENTIONALLY OMITTED
A1.01A	PARTIAL SITE PLAN / SOUTH	FEBRUARY 1, 2011	NO REVISION - INTENTIONALLY OMITTED
A1.01B	PARTIAL SITE PLAN	APRIL 28, 2014	INTENTIONALLY OMITTED
A1.02	OFFICE LEVEL PLAN	FEBRUARY 1, 2011	INTENTIONALLY OMITTED
A1.03	ROOF PLANS	APRIL 28, 2014	INTENTIONALLY OMITTED
A1.03A	PARTIAL ROOF PLAN/ SOUTH	FEBRUARY 1, 2011	NO REVISION - INTENTIONALLY OMITTED
A1.03B	PARTIAL ROOF PLAN / NORTH	FEBRUARY 1, 2011	INTENTIONALLY OMITTED
A2.01	BUILDING 100 ELEVATIONS	FEBRUARY 1, 2011	NO REVISION - INTENTIONALLY OMITTED
A2.02	BUILDING 300 ELEVATIONS	FEBRUARY 1, 2011	NO REVISION - INTENTIONALLY OMITTED
A2.03	BUILDING 500 ELEVATIONS	FEBRUARY 1, 2011	NO REVISION - INTENTIONALLY OMITTED
A2.04	BUILDING 1200 ELEVATIONS	FEBRUARY 1, 2011	NO REVISION - INTENTIONALLY OMITTED
A2.05	BUILDING 400 ELEVATIONS	FEBRUARY 1, 2011	NO REVISION - INTENTIONALLY OMITTED
A2.06	BUILDING 200 ELEVATIONS	FEBRUARY 1, 2011	NO REVISION - INTENTIONALLY OMITTED
A9-3.1	BUILDING 900 ELEVATIONS	APRIL 28, 2014	NO REVISION - INTENTIONALLY OMITTED
A2.08	BUILDING 1100 ELEVATIONS	JULY 30, 2013	NO REVISION - INTENTIONALLY OMITTED
A2.09	BUILDING 1100 ELEVATIONS	JULY 30, 2013	NO REVISION - INTENTIONALLY OMITTED
A2.10	BUILDING 1300 ELEVATIONS	MAY 02, 2008	NO REVISION - INTENTIONALLY OMITTED
A2.10	BUILDING 1350 ELEVATIONS	FEBRUARY 24, 2017	NO REVISION - INTENTIONALLY OMITTED
A15-2.1	BUILDING 1500 ELEVATIONS	APRIL 28, 2014	NO REVISION - INTENTIONALLY OMITTED
A6-3.1	BUILDING 600 ELEVATIONS	APRIL 28, 2014	NO REVISION - INTENTIONALLY OMITTED
A6-4.1	BUILDING 600 ELEVATIONS	APRIL 28, 2014	NO REVISION - INTENTIONALLY OMITTED
A2.14	BUILDING 1200 ELEVATIONS	MAY 02, 2008	NO REVISION - INTENTIONALLY OMITTED
A2.15	BUILDING 1200 ELEVATIONS	MAY 02, 2008	NO REVISION - INTENTIONALLY OMITTED
A2.16	BUILDING 400 ELEVATIONS	MAY 02, 2008	NO REVISION - INTENTIONALLY OMITTED
A2.17	BUILDING 200 ELEVATIONS	MAY 02, 2008	NO REVISION - INTENTIONALLY OMITTED
A2.18	BUILDING 200 ELEVATIONS	MAY 02, 2008	NO REVISION - INTENTIONALLY OMITTED
A3.1	EXTERIOR ELEVATIONS BUILDING 1000	MAY 02, 2008	NO REVISION - INTENTIONALLY OMITTED
A3.2	EXTERIOR ELEVATIONS BUILDING 1000	MAY 02, 2008	NO REVISION - INTENTIONALLY OMITTED
A3.3	EXTERIOR ELEVATIONS BUILDING 1000	MAY 02, 2008	NO REVISION - INTENTIONALLY OMITTED
A3.4	EXTERIOR ELEVATIONS BUILDING 2000	MAY 02, 2008	NO REVISION - INTENTIONALLY OMITTED
A3.5	EXTERIOR ELEVATIONS BUILDING 2000	MAY 02, 2008	NO REVISION - INTENTIONALLY OMITTED
A3.6	EXTERIOR ELEVATIONS BUILDING 2000	MAY 02, 2008	NO REVISION - INTENTIONALLY OMITTED
A3.7	EXTERIOR ELEVATIONS BUILDING 3000	MAY 02, 2008	NO REVISION - INTENTIONALLY OMITTED
A3.8	EXTERIOR ELEVATIONS BUILDING 3000	MAY 02, 2008	NO REVISION - INTENTIONALLY OMITTED
A3.9	EXTERIOR ELEVATIONS BUILDING 3000	MAY 02, 2008	NO REVISION - INTENTIONALLY OMITTED
A3.10	EXTERIOR ELEVATIONS BUILDING CLUBHOUSE	MAY 02, 2008	NO REVISION - INTENTIONALLY OMITTED

OWNER / APPLICANT

Market Street at Lynnfield Development LLC
c/o National Development
2310 Washington Street
Newton Lower Falls, Massachusetts 02462

SITE PLANNING

Stantec Planning and Landscape Architecture, PC.
226 Causeway Street
Boston, Massachusetts 02114

ARCHITECTS

Prellwitz / Chilinski Associates Inc.
221 Hampshire Street
Cambridge, Massachusetts 02139

Cube 3 Studio
360 Merrimack Street
Building 5, Floor 3
Lawrence, Massachusetts 01843

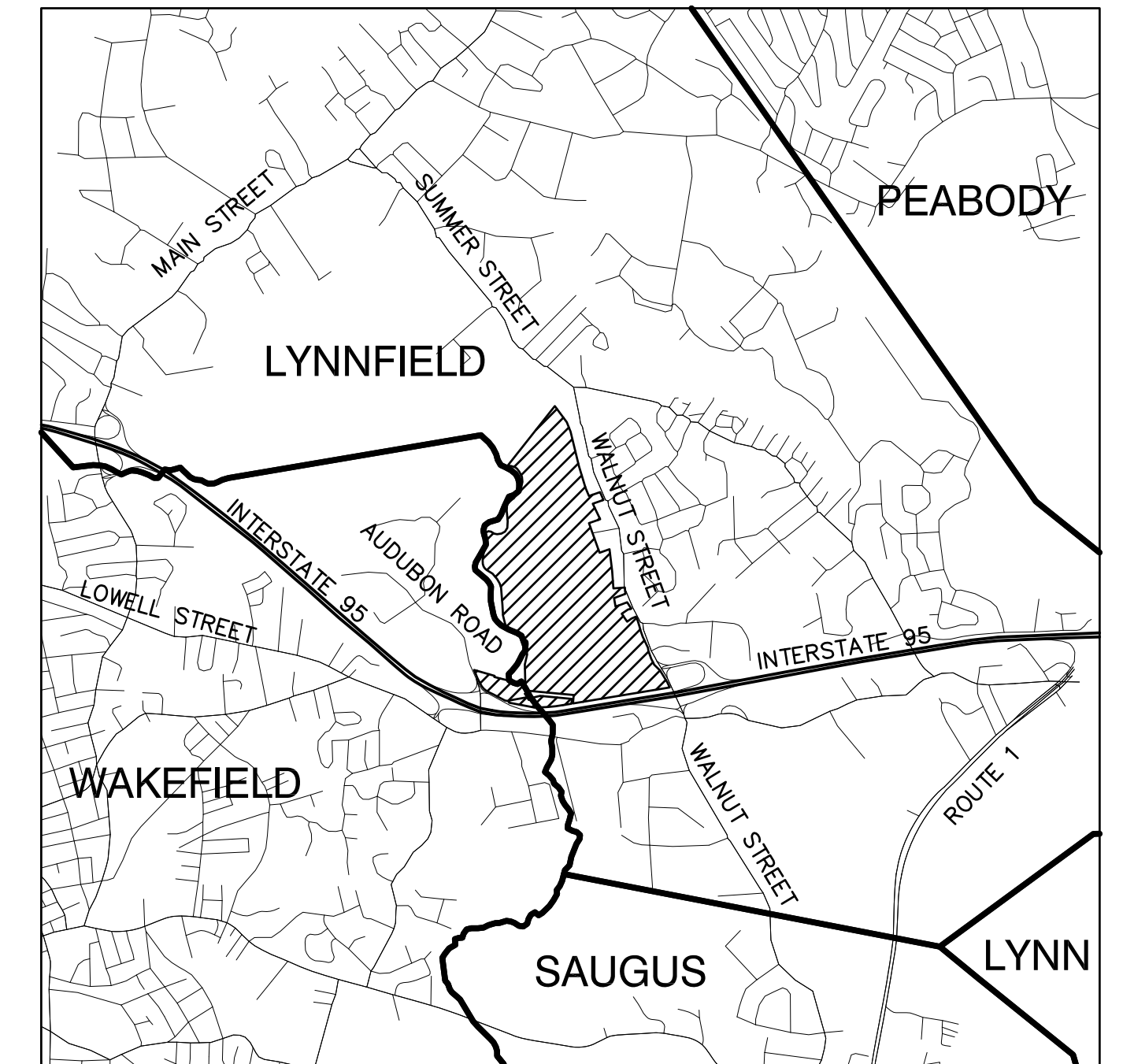

VICINITY MAP
NOT TO SCALE

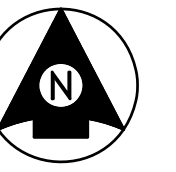

LYNNFIELD PLANNING BOARD

LAYOUT AND MATERIAL NOTES

- EXISTING CONDITIONS INFORMATION IS REPRODUCED FROM THE SURVEY PREPARED BY NITSCH ENGINEERING OF BOSTON, MA AND IS DATED SEPTEMBER 15, 2006 LAST REVISED MAY 01, 2008.
- THE LOCATIONS OF UNDERGROUND UTILITIES SHOWN ARE BASED ON THE SURVEY REFERENCED ABOVE. THE CONTRACTOR SHALL NOTIFY DIGSAFE AND THE PROPER LOCAL AUTHORITIES OR RESPECTIVE UTILITY COMPANIES TO CONFIRM THE LOCATION OF ALL EXISTING UTILITIES BEFORE COMMENCING WORK. ANY DAMAGE DUE TO FAILURE OF THE CONTRACTOR TO CONTACT THE PROPER AUTHORITIES SHALL BE BORNE BY THE CONTRACTOR.
- CONTRACTOR(S) SHALL THOROUGHLY FAMILIARIZE THEMSELVES WITH ALL CONSTRUCTION DOCUMENTS, SPECIFICATIONS, AND SITE CONDITIONS PRIOR TO BIDDING AND PRIOR TO CONSTRUCTION.
- ANY DISCREPANCIES BETWEEN DRAWINGS, SPECIFICATIONS, AND SITE CONDITIONS SHALL BE REPORTED IMMEDIATELY TO THE OWNER'S REPRESENTATIVE FOR CLARIFICATION AND RESOLUTION PRIOR TO BIDDING OR CONSTRUCTION.
- ALL WORK CONDUCTED WITHIN PUBLIC RIGHT-OF-WAYS SHALL CONFORM TO THE REQUIREMENTS AND SPECIFICATIONS OF THE TOWNS OF LYNNFIELD AND WAKEFIELD, AND THE MASSACHUSETTS HIGHWAY DEPARTMENT.
- SEE ARCHITECTURAL DRAWINGS FOR EXACT BUILDING DIMENSIONS AND ALL DETAILS CONTIGUOUS TO THE BUILDING, INCLUDING SIDEWALKS, RAMPS, UTILITY ENTRANCE LOCATIONS, WALL PACKS, CONCRETE DOOR PADS, ROOF DRAINS, ETC.
- ACCESSIBLE CURB RAMPS SHALL BE PER THE MASSACHUSETTS ARCHITECTURAL ACCESS BOARD (AAB) AND THE AMERICANS WITH DISABILITIES ACT (ADA) ACCESSIBILITY GUIDELINES, WHICHEVER IS MORE STRINGENT.
- ALL WALKWAYS AND HANDICAP PARKING SPACES SHALL COMPLY WITH THE MASSACHUSETTS ARCHITECTURAL ACCESS BOARD (AAB) AND THE AMERICANS WITH DISABILITIES ACT (ADA) ACCESSIBILITY GUIDELINES. IF FIELD CONDITIONS MAKE IT IMPOSSIBLE TO COMPLY WITH THESE GUIDELINES AND REGULATIONS, A WAIVER FROM THE AAB WILL BE SOUGHT.
- THE FOLLOWING LAYOUT CRITERIA SHALL CONTROL UNLESS OTHERWISE NOTED ON THE PLAN:
ALL DIMENSIONS ARE TO OUTSIDE FACE OF BUILDING.
ALL DIMENSIONS ARE TO FACE OF CURB AT OUTER LINE.
ALL DIMENSIONS ARE TO CENTER OF PAVEMENT MARKINGS.
ALL TIES TO PROPERTY LINES ARE PERPENDICULAR TO THE PROPERTY LINE UNLESS OTHERWISE NOTED.
- FOR LAYOUT AND DIMENSIONING OF BUILDINGS, SEE ARCHITECTURAL DRAWINGS.
- SCREENED IMAGES SHOW EXISTING CONDITIONS. WHERE EXISTING CONDITIONS LIE UNDER OR ARE IMPINGED UPON BY PROPOSED BUILDINGS AND/OR SITE ELEMENTS, THE EXISTING CONDITION WILL BE REMOVED, ABANDONED AND/OR GAPPED OR DEMOLISHED AS REQUIRED.
- ALL RADIAL VERTICAL GRANITE CURBING IN PARKING AREAS SHALL BE 5' RADIUS UNLESS OTHERWISE NOTED.
- ALL PARKING SPACES ARE 9' WIDE UNLESS OTHERWISE NOTED. STRIPING SHALL BE EVENLY SPACED WITHIN TRAYS.

LAYOUT AND MATERIAL LEGEND

- PROPERTY LINE
- LIMIT OF WORK LINE
- LIGHT POLES - SHALL BE FLUSH UNLESS:
• SET BELOW BRICK WHEN LOCATED IN PAVERS
• RAISED WHEN LOCATED DIRECTLY IN BITUMINOUS CONCRETE PARKING AREAS
- UNIT PAVERS
- CEMENT CONCRETE PAVEMENT
- PAINTED PEDESTRIAN CROSSWALK
- VERTICAL GRANITE CURB
- SLOPED GRANITE CURB
- FLUSH GRANITE CURB
- MOUNTABLE GRANITE CURB
- BITUMINOUS CONCRETE CURB
- INTEGRAL CONCRETE CURB
- EDGE OF PAVEMENT
- TRANSITION VERTICAL GRANITE CURB TO SLOPED GRANITE CURB
- TRANSITION VERTICAL GRANITE CURB TO CAPE COD BERM
- WOOD GUARDRAIL
- STEEL GUARDRAIL
- SITE SIGNAGE
- BENCH
- BIKE RACK
- TRASH RECEPTACLE
- TRAFFIC ARROWS / STOP LINE / PAVEMENT MARKINGS
- FILTERMITT EROSION CONTROL LINE
- TRANSFORMER (COORDINATE WITH UTILITY COMPANIES)
- SECTIONALIZING CABINET (COORDINATE WITH UTILITY COMPANIES)
- SECTIONALIZING CABINET WITH PAD MOUNTED SWITCH (COORDINATE WITH UTILITY COMPANIES)

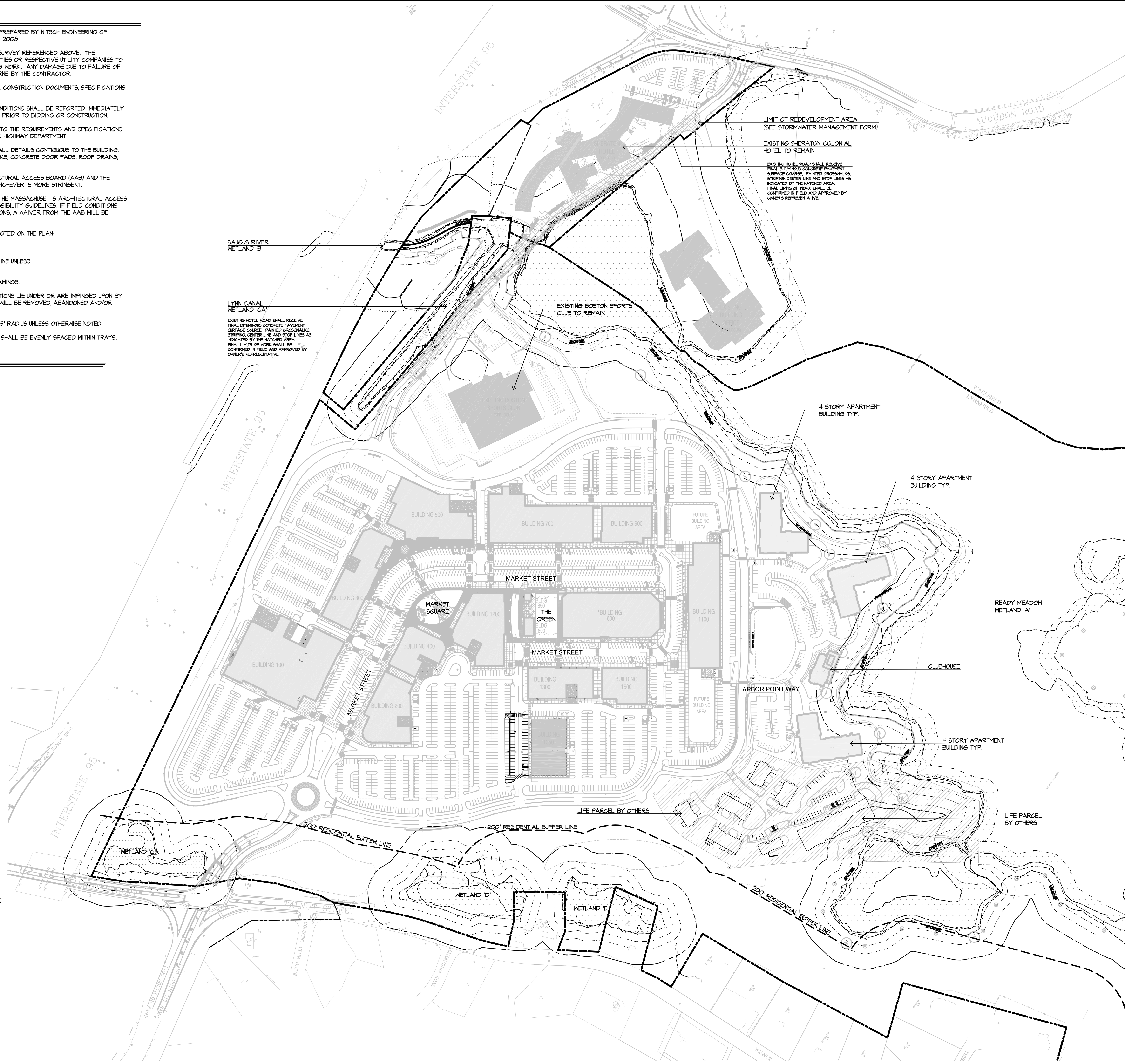

226 Causeway Street, 6th Floor
Boston, MA 02114
Tel. 617.523.8103
www.stantec.com

Copyright Reserved
The Contractor shall verify and be responsible for all dimensions. DO NOT scale the drawing - any errors or omissions shall be reported to Stantec without delay. The Copyrights to all design and drawings are the property of Stantec. Reproduction or use for any purpose other than that authorized by Stantec is forbidden.

North Arrow

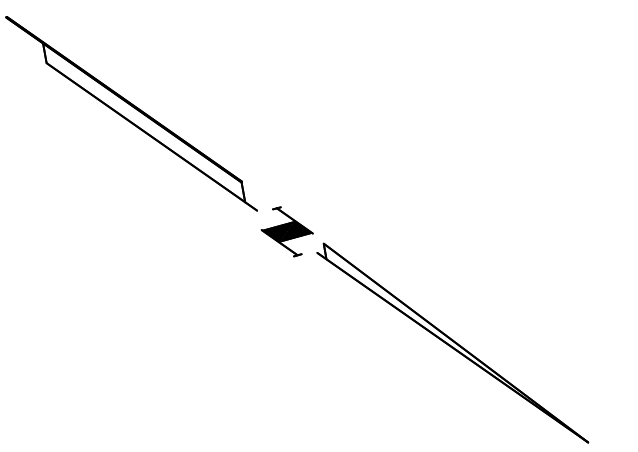

Scale

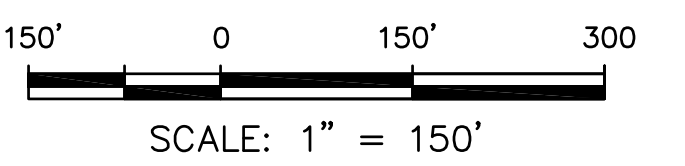

Keymap

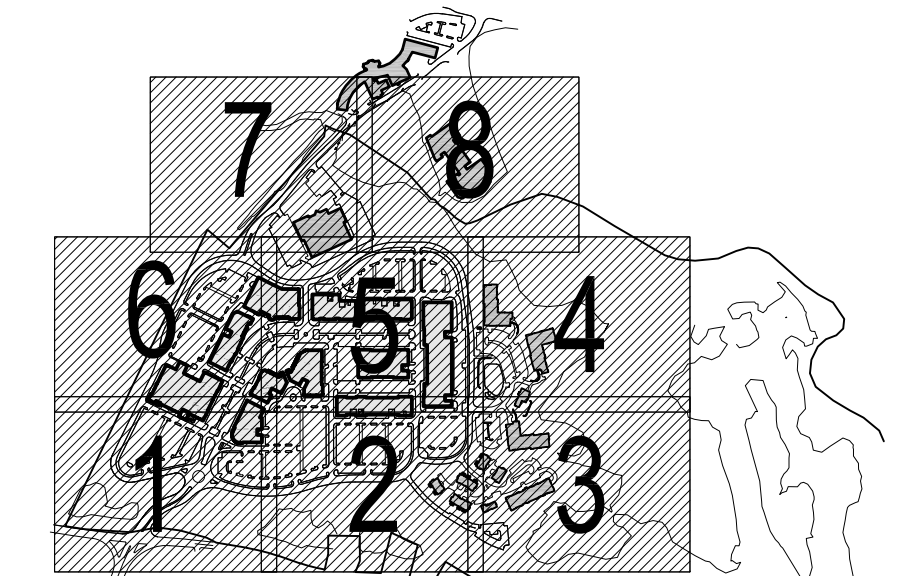

Various revisions	07.18.18
Various revisions	02.24.17
Various revisions	04.28.14
Various revisions	07.30.13
Various revisions	02.01.11
Various revisions	05.02.08
Response to Comments from Crowe	04.04.08
Planned Village Development District Application	01.18.08
Notice of Intent	01.10.08
Issued	MM.DD.YY

File Name: 00677-LM-PB.dwg
Dwn. Chkd. MM.DD.YY

Permit-Seal



Applicant/Project

Market Street South LLC
c/o National Development
2310 Washington Street
Newton Lower Falls, MA 02462
MARKETSTREET LYNNFIELD
Lynnfield, MA

Title
**OVERALL LAYOUT
AND MATERIALS PLAN**

Project No.
210800677

Drawing No.

LR-2.0

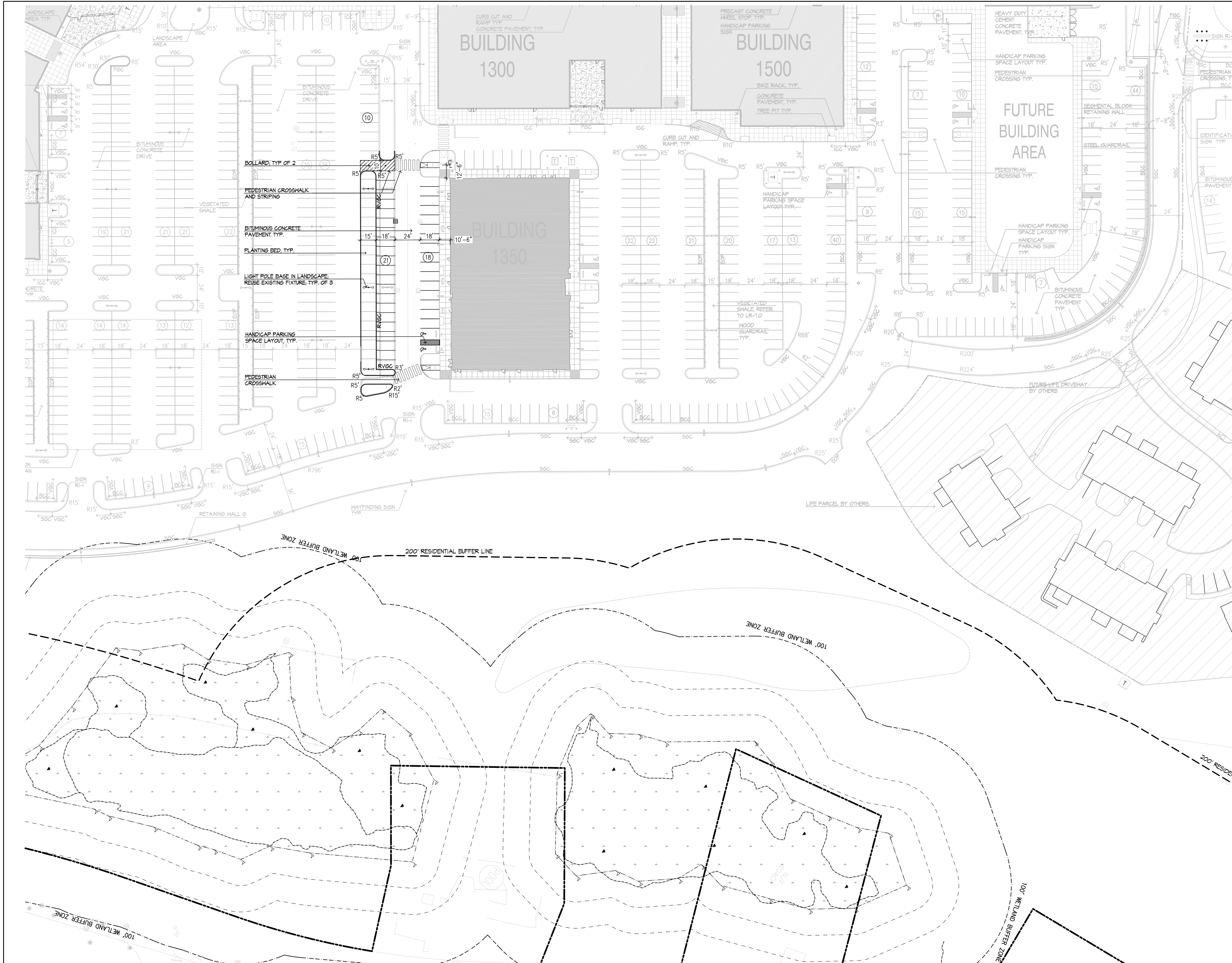
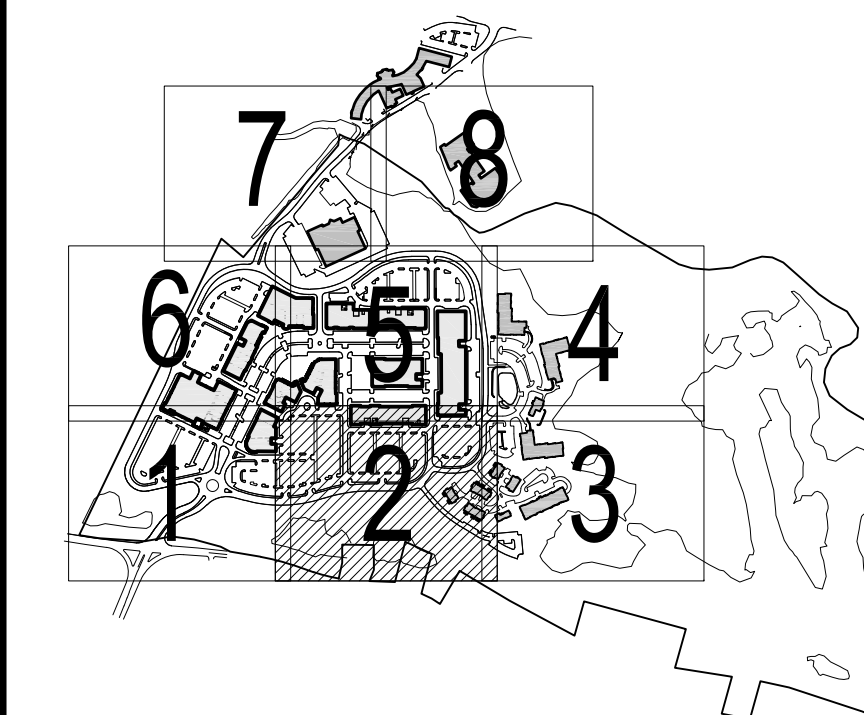
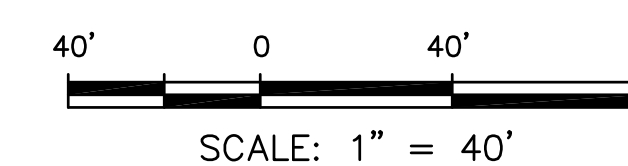
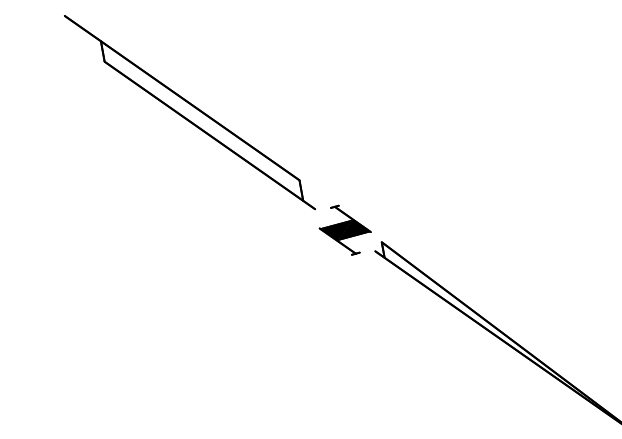

Various revisions	07.18.18
Various revisions	02.24.17
Various revisions	04.28.14
Various revisions	07.30.13
Various revisions	02.01.11
Various revisions	05.02.08
Response to Comments from Crowe	04.04.08
Planned Village Development District Application	01.18.08
Notice of Intent	01.10.08
Issued	MM.DD.YY

File Name: 00677-LM-PB.dwg
 Dwn. Chkd. MM.DD.YY

Permit-Seal

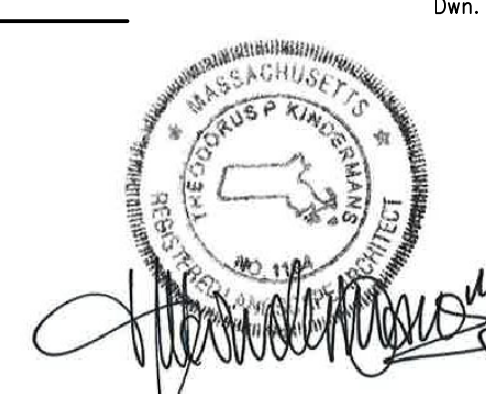

Applicant/Project
 Market Street South LLC
 c/o National Development
 2310 Washington Street
 Newton Lower Falls, MA 02462
 MARKETSTREET LYNNFIELD
 Lynnfield, MA

Title
 LAYOUT AND MATERIALS PLAN

Project No.
 210800677

Drawing No.
 LR-2.2

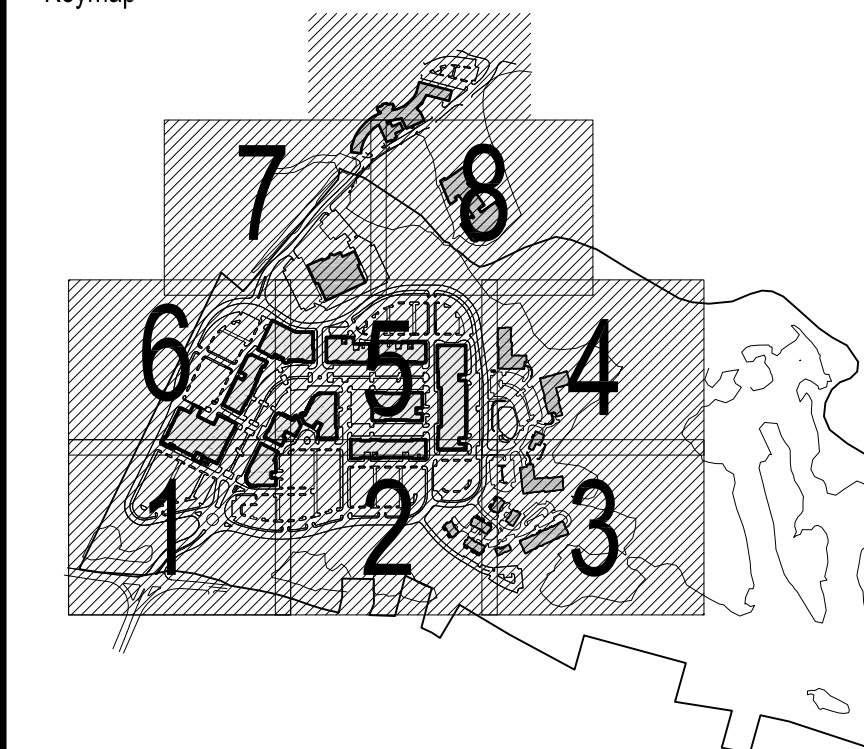
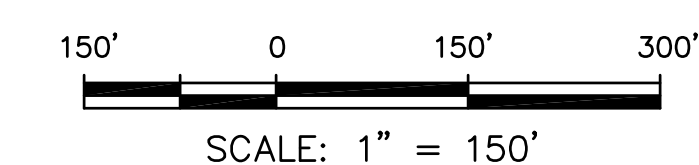

Various revisions	07.18.18
Various revisions	02.24.17
Various revisions	04.28.14
Various revisions	07.30.13
Various revisions	02.01.11
Various revisions	05.02.08
Response to Comments from Crowe	04.04.08
Planned Village Development District Application	01.18.08
Notice of Intent	01.10.08
Issued	MM.DD.YY

File Name: 00677-P-PB.dwg
 Dwn. Chkd. MM.DD.YY

Permit-Seal

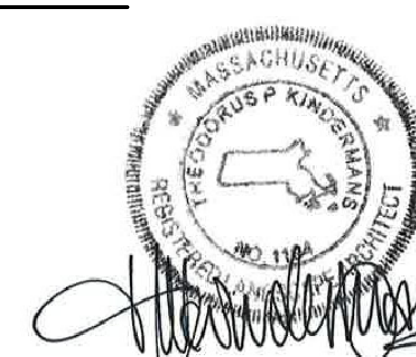

Applicant/Project
 Market Street South LLC
 c/o National Development
 2310 Washington Street
 Newton Lower Falls, MA 02462
 MARKETSTREET LYNNFIELD
 Lynnfield, MA

Title
 OVERALL PLANTING PLAN

Project No.
 210800677

Drawing No.
 LR-5.0A

RECOMMENDED PLANT LIST

SYMBOL	BOTANICAL NAME	COMMON NAME	SIZE	COMMENT
DECIDUOUS TREES				
AR	ACER RUBRUM 'OCTOBER GLORY'	OCTOBER GLORY RED MAPLE	2 1/2" CAL.	
AS	LIRIODENDRON TULIPIFERA	TULIP POPLAR	2 1/2" CAL.	
FP	FRAXINUS PENNSYLVANICA 'PATMORE'	PATMORE GREEN ASH	2 1/2" CAL.	
GTS	GLEDITSIA TRIACANTHOS var. INERMIS 'SKYLINE'	SKYLINE HONEYLOCUST	2 1/2" CAL.	
NS	NYSSA SYLVATICA	BLACK TUPELO	2 1/2" CAL.	
PXA	PLATANUS x ACERIFOLIA 'BLOODGOOD'	BLOODGOOD LONDON PLANETREE	2 1/2" CAL.	
PAB	PLATANUS x ACERIFOLIA 'BLOODGOOD'	BLOODGOOD LONDON PLANETREE	7" CAL.	
QA	QUERCUS ALBA	WHITE OAK	2 1/2" CAL.	
QB	QUERCUS BICOLOR	WHITE SWAMP OAK	1 1/2" CAL.	
Q	QUERCUS IMBRICARIA	SHINGLE OAK	2 1/2" CAL.	
QP	QUERCUS PALUSTRIS	PIN OAK	1 1/2" CAL.	
QR	QUERCUS RUBRA	RED OAK	2 1/2" CAL.	
SA	SALIX ALBA 'TRISTIS'	NIOBE WEeping WILLOW	2 1/2" CAL.	
TC	TILIA CORDATA 'GREENSPIRE'	GREENSPIRE LINDEN	2 1/2" CAL.	
UP	ULMUS PARVIFOLIA 'EMER II'	ALLEE LACEBARK ELM	2 1/2" CAL.	
ORNAMENTAL TREES				
AL	AMELANCHIER LAEVIS	SERVICEBERRY	8' HT.	
BN	BETULA NIGRA 'DURAHEAT'	DURAHEAT RIVER BIRCH	7' HT.	MULTISTEM CLUMP
CO	CELTIS OCCIDENTALIS	COMMON HACKBERRY	1 1/2" CAL.	
HV	HAMAMELUS VERNALIS	VERNAL WITCHHAZEL	4'-5' HT.	MULTISTEM / B&B
PO	PRUNUS x 'OKAME'	OKAME CHERRY	2" CAL.	SINGLE STEM / B&B
CONIFEROUS TREES				
PA	PICEA ABIES	NORWAY SPRUCE	6'-8' HT.	* FIELD LOCATE
PA	PICEA ABIES	NORWAY SPRUCE	10' HT.	
PP	PICEA PUNGENS 'BAKERI'	BAKERI COLORADO SPRUCE	6'-8' HT.	
PS	PINUS STROBUS	WHITE PINE	6'-8' HT.	* FIELD LOCATE
PS	PINUS STROBUS	WHITE PINE	10' HT.	
TP	THUJA PLICATA	GIANT ARBORVITAE	6'-8' HT.	* FIELD LOCATE
TP	THUJA PLICATA	GIANT ARBORVITAE	10' HT.	
SHRUBS				
CA	CLETHR A ALNIFOLIA 'SIXTEEN CANDLES'	SIXTEEN CANDLES SUMMERSWEET	2' HT.	
CR	CORNUS RACEMOSA	GRAYWIG DOGWOOD	2' HT.	
CS	CORNUS SERCIA 'ARTIC FIRE'	TARTARIAN DOGWOOD	2' HT.	
FL	FORSYTHIA OVATA x EUROPAEA 'MEADOWLARK'	MEADOWLARK FORSYTHIA	2' HT.	
IL	ILEX VERTICILLATA 'RED SPRITE'	RED SPRITE WINTERBERRY	2' HT.	
IV	ITEA VIRGINICA 'HENRY'S GARNET'	HENRY'S GARNET SWEETSPIRE	2' HT.	
LB	LINDERA BENZON	SPICEBUSH	2' HT.	
MP	MYRICA PENNSYLVANICA	NORTHERN BAYBERRY	2' HT.	
RC	RHOODODENDRON 'CUNNINGHAM'S WHITE'	CUNNINGHAM'S WHITE RHODO.	2' HT.	
SC	SAMBUCUS CANADENSIS	ELDERBERRY	18"-24" HT.	
SP	SPIREA JAPONICA 'NEON FLASH'	NEON FLASH JAPANESE SPIREA	#5 POT	
VP	VIBURNUM Plicatum var. TOMENTOSUM	DOUBLEFILE VIBURNUM	2' HT.	
VL	VIBURNUM LENTAGO	NANNYBERRY VIBURNUM	36"-48" HT.	
PERENNIALS / GROUNDCOVER				
AB	ARONIA ARBUTIFOLIA	RED CHOKEBERRY	18"-24" HT.	
CK	CALAMAGROSTIS x 'KARL FOERSTER'	FEATHER REED GRASS	#3 POT	
EH	ECHINACEA PURPUREA 'FRAGRANT ANGEL'	WHITE CONEFLOWER	#2 POT	
HM	HAKONECHLOA MACRA 'AUREOLA'	HAKONE GRASS	#2 POT	
LR	LUPINUS 'RUSSELL HYBRID PINK'	LUPINE	#2 POT	
MS	MISCANTHUS SINENSIS 'MORNING LIGHT'	JAPANESE SILVER GRASS	#3 POT	
PV	PANICUM VIRGATUM 'SHENANDOAH'	SHENANDOAH SWITCH GRASS	#3 POT	
PH	PENNISETUM ALOPECUROIDES 'HAMELN'	HAMELN FOUNTAIN GRASS	#2 POT	
PK	PENNISETUM ORIENTALE 'KARLEY ROSE'	KARLEY ROSE FOUNTAIN GRASS	#3 POT	
PE	PEROVSKIA ATRIPLIOFOLIA	RUSSIAN SAGE	#2 POT	
SE	SEDUM x 'AUTUMN JOY'	STONECROP	#2 POT	
SS	SCHIZACHYRIUM SCOPARIUM 'THE BLUES'	LITTLE BLUESTEM	#1.5 POT	
	ECHINACEA PURPUREA 'FRAGRANT ANGEL'	WHITE CONEFLOWER	#1.5 POT	
	EUPATORIUM X HYBRID 'PHANTOM'	PHANTOM JOE-PYE-WEED	#1.5 POT	
	IRIS SIBIRICA 'BLUE KING'	BLUE KING SIBERIAN IRIS	#1.5 POT	
	LUPINUS 'RUSSELL HYBRID PINK'	LUPINE	#1.5 POT	
	RUDBECKIA 'TAKAO'	BLACK-EYED SUSAN	#1.5 POT	
	TANACETUM COCCINEUM 'JAMES KELWAY'	PAINTED DAISY	#1.5 POT	
RT	RUDBECKIA 'TAKAO'	BLACK-EYED SUSAN	#2 POT	

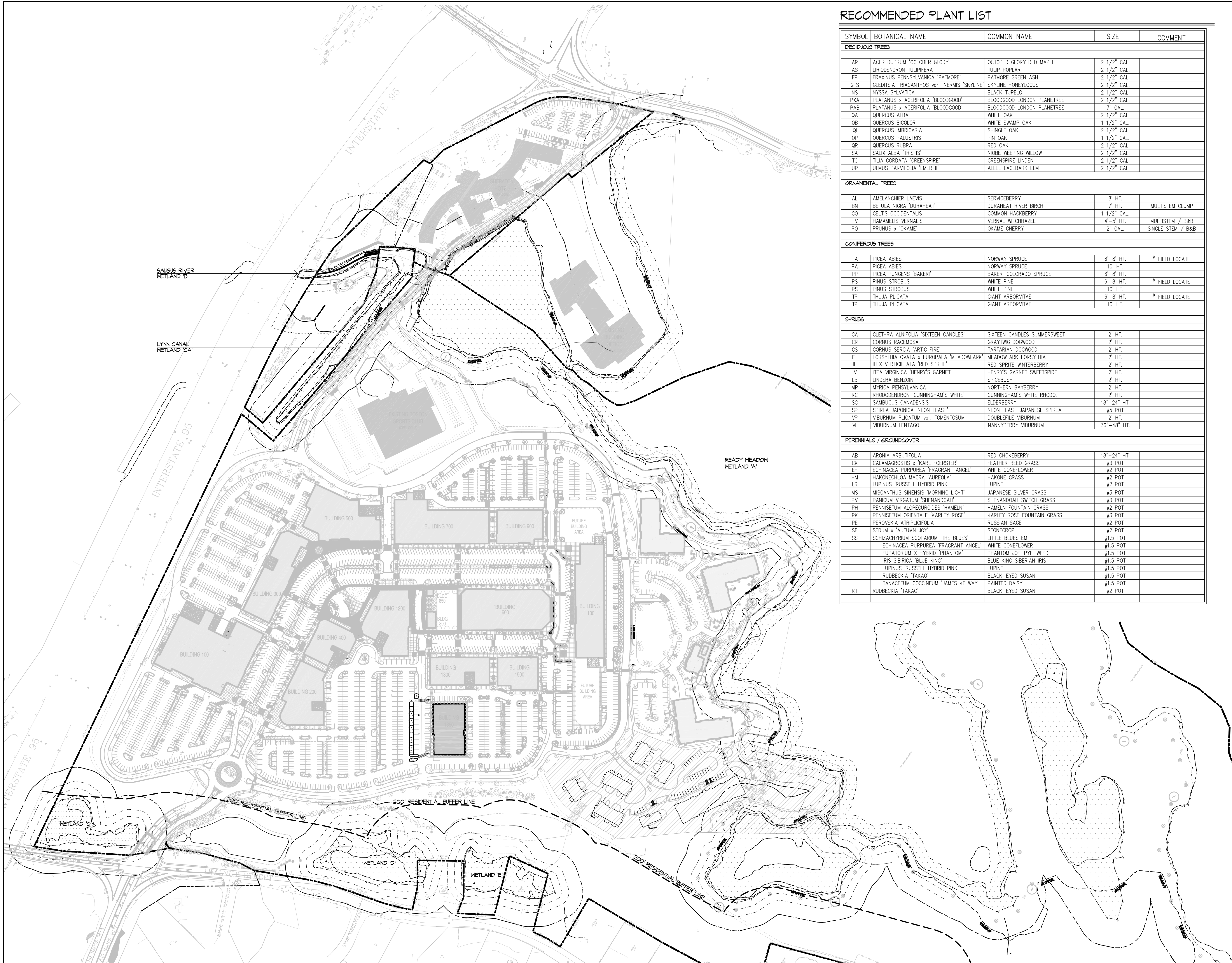

North Arrow

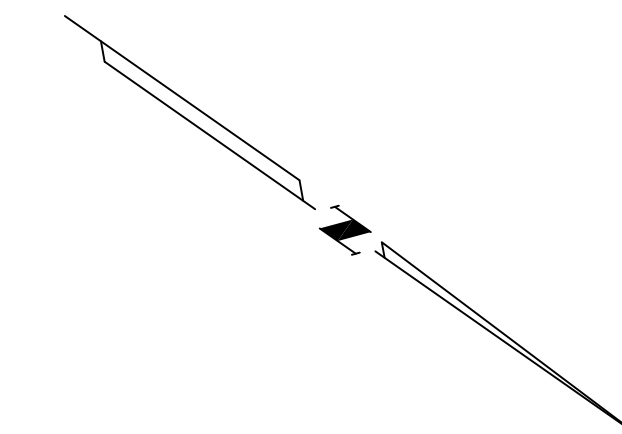

Scale

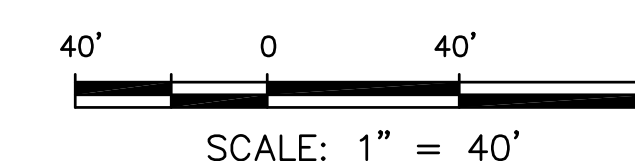

Keymap

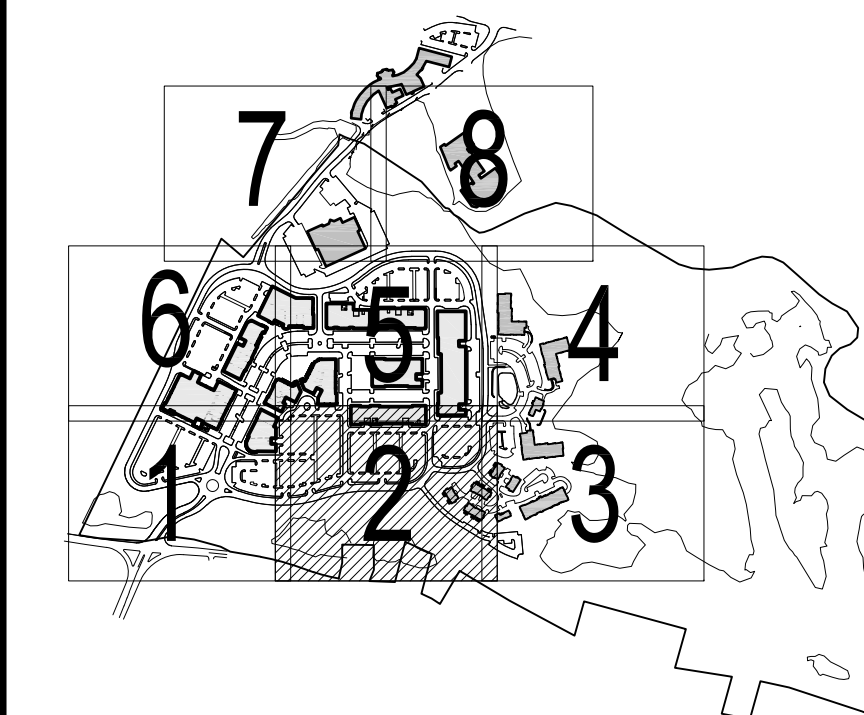

Various revisions	07.18.18
Various revisions	02.24.17
Various revisions	04.28.14
Various revisions	07.30.13
Various revisions	02.01.11
Various revisions	05.02.08
Response to Comments from Crowe	04.04.08
Planned Village Development District Application	01.18.08
Notice of Intent	01.10.08
Issued	MM.DD.YY

File Name: 00677-P-PB.dwg
 Dwn. Chkd. MM.DD.YY

Permit-Seal



Applicant/Project
 Market Street South LLC
 c/o National Development
 2310 Washington Street
 Newton Lower Falls, MA 02462
 MARKETSTREET LYNNFIELD
 Lynnfield, MA

Title
 PLANTING PLAN

Project No.
 210800677

Drawing No.
 LR-5.2

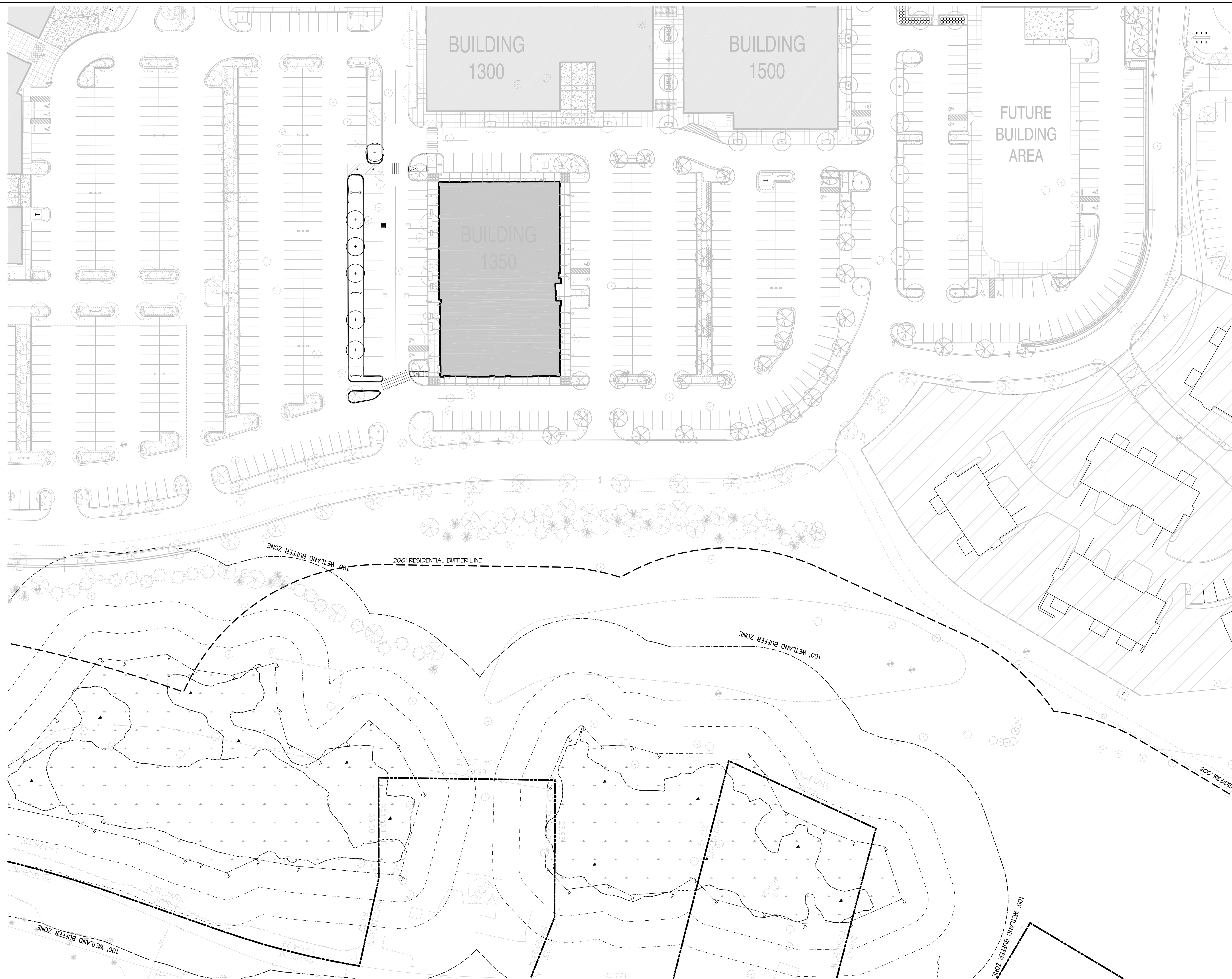

P.O. Box 659A
 Kennebunkport, ME 04046
 207-967-5223
 jmlight2@roadrunner.com

North Arrow

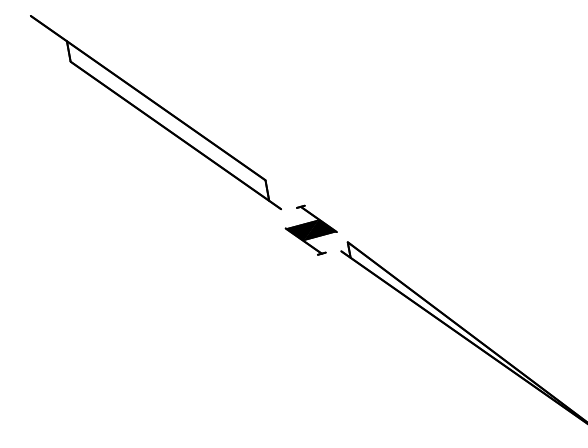

Scale

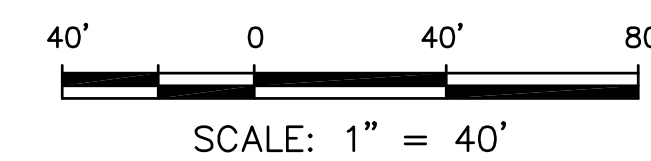

Keymap

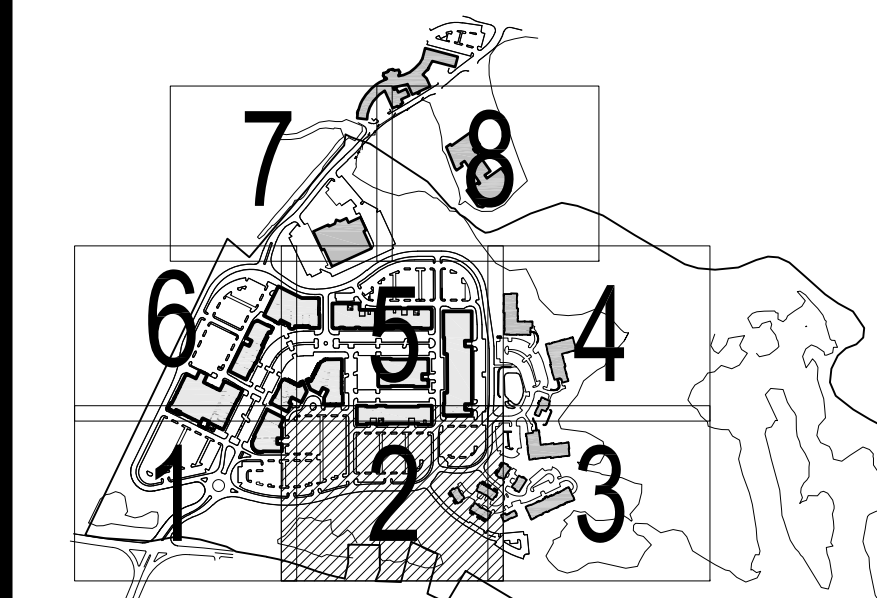

Various revisions	07.18.18
Various revisions	02.24.17
Various revisions	01.19.17
Various revisions	07.30.13
Various revisions	02.01.11
Various revisions	05.02.08
Response to Comments from Crowe	04.04.08
Planned Village Development District Application	01.18.08
Notice of Intent	01.10.08
Issued	MM.DD.YY

File Name: 00677-Photometric-PB.dwg
 Dwn. Chkd. MM.DD.YY

Permit-Seal

Applicant/Project
 Market Street South LLC
 c/o National Development
 2310 Washington Street
 Newton Lower Falls, MA 02462
 MARKETSTREET LYNNFIELD
 Lynnfield, MA

Title
 PHOTOMETRICS PLAN

Project No.
 210800677

Drawing No.

LR-8.2

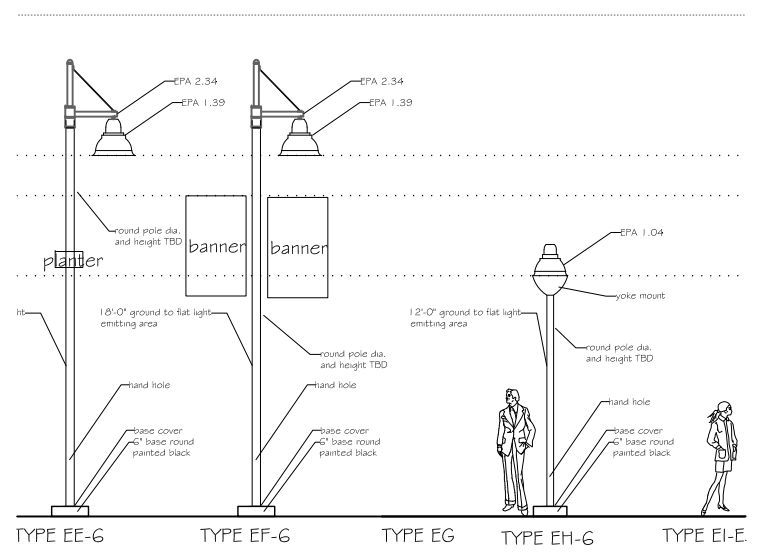
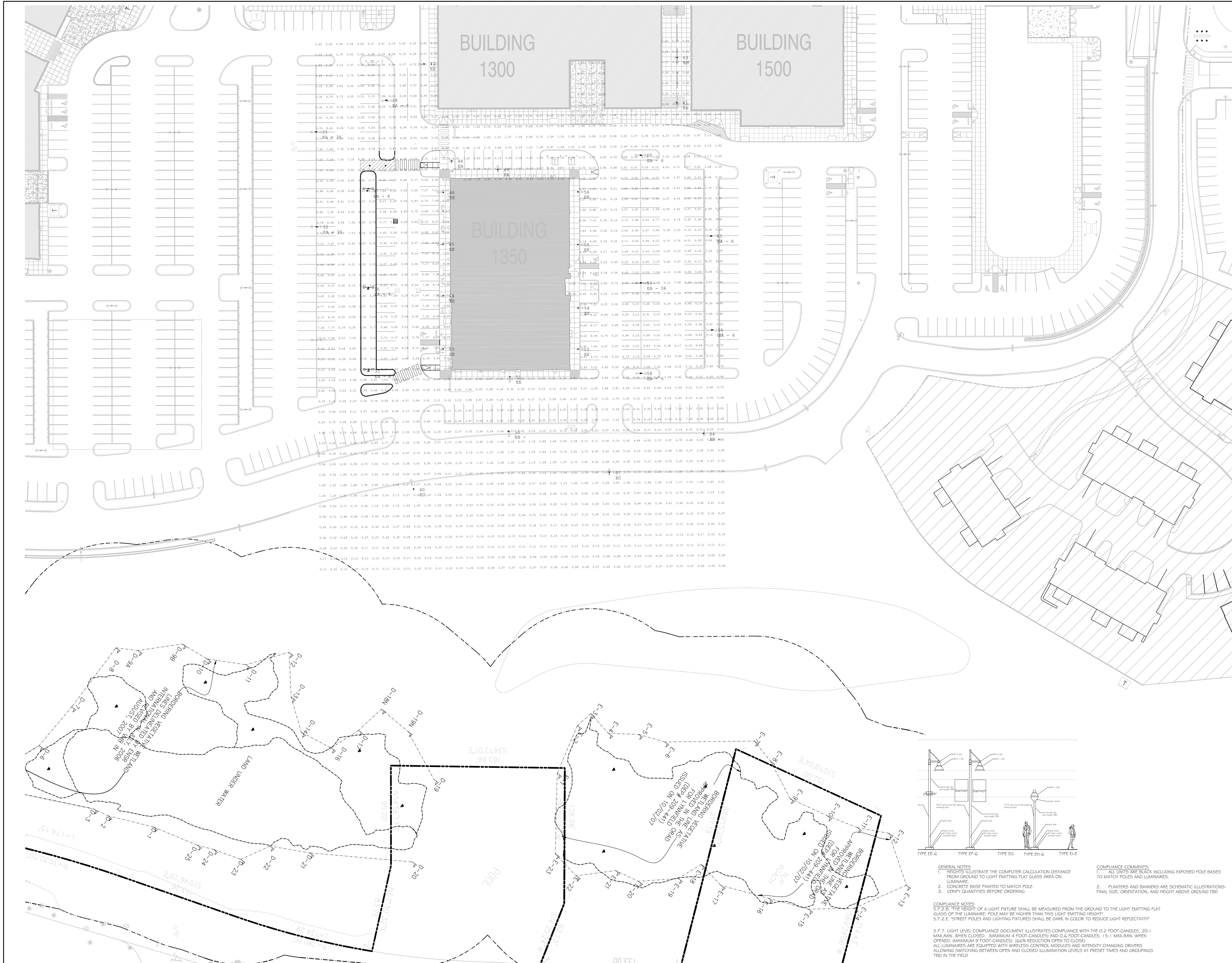

GENERAL NOTES:
 1. HEIGHTS ILLUSTRATE THE COMPUTER CALCULATION DISTANCE FROM GROUND TO LIGHT EMITTING FLAT GLASS AREA ON LUMINAIRE.
 2. CONCRETE BASE PAINTED TO MATCH POLE.
 3. VERIFY QUANTITIES BEFORE ORDERING.

COMPLIANCE NOTES:
 5.F.2.B. THE HEIGHT OF A LIGHT FIXTURE SHALL BE MEASURED FROM THE GROUND TO THE LIGHT EMITTING FLAT GLASS OF THE LUMINAIRE. POLE MAY BE HIGHER THAN THIS LIGHT EMITTING HEIGHT.
 5.F.2.E. "STREET POLES AND LIGHTING FIXTURES SHALL BE DARK IN COLOR TO REDUCE LIGHT REFLECTIVITY"

COMPLIANCE COMMENTS:
 1. ALL DRIPS ARE BLACK, INCLUDING EXPOSED POLE BASES TO MATCH POLES AND LUMINAIRES.
 2. PLANTERS AND BANNERS ARE SCHEMATIC ILLUSTRATIONS. FINAL SIZE, ORIENTATION, AND HEIGHT ABOVE GROUND TBD.

5.F.7. LIGHT LEVEL COMPLIANCE DOCUMENT ILLUSTRATES COMPLIANCE WITH THE 0.2 FOOT-CANDELS, 20:1 MAX./MIN. WHEN CLOSED, (MAXIMUM 4 FOOT-CANDELS) AND 0.6 FOOT-CANDELS, 15:1 MAX./MIN. WHEN OPENED, (MAXIMUM 9 FOOT-CANDELS). (60% REDUCTION OPEN TO CLOSED)
 ALL LUMINAIRES ARE EQUIPPED WITH WIRELESS CONTROL MODULES AND INTENSITY CHANGING DRIVERS ALLOWING SWITCHING BETWEEN OPEN AND CLOSED ILLUMINATION LEVELS AT PRESET TIMES AND GROUPINGS TBD IN THE FIELD.

North Arrow

Scale

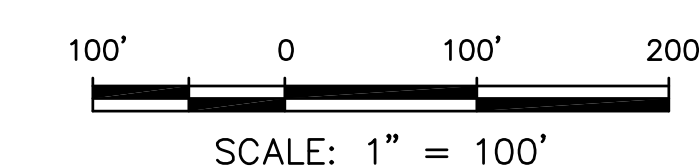

Keymap

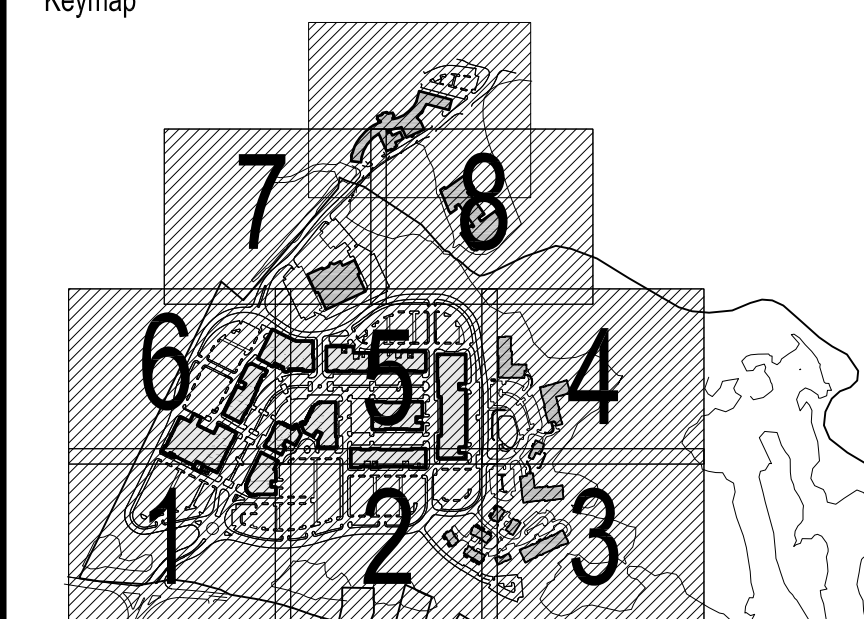

Various revisions	07.18.18
Various revisions	02.24.17
Various revisions	04.28.14
Various revisions	07.30.13
Various revisions	02.01.11
Various revisions	05.02.08
Response to Comments from Crowe	04.04.08
Planned Village Development District Application	01.18.08
Notice of Intent	01.10.08
Issued	MM.DD.YY

File Name: 00677-Internal Traffic.dwg

Permit-Seal



Applicant/Project

Market Street South LLC
 c/o National Development
 2310 Washington Street
 Newton Lower Falls, MA 02462

MARKETSTREET LYNNFIELD
 Lynnfield, MA

Title

INTERNAL TRAFFIC
 CONTROL PLAN

Project No.
 210800677

1" = 100'-0"

Drawing No.

LR-9.0

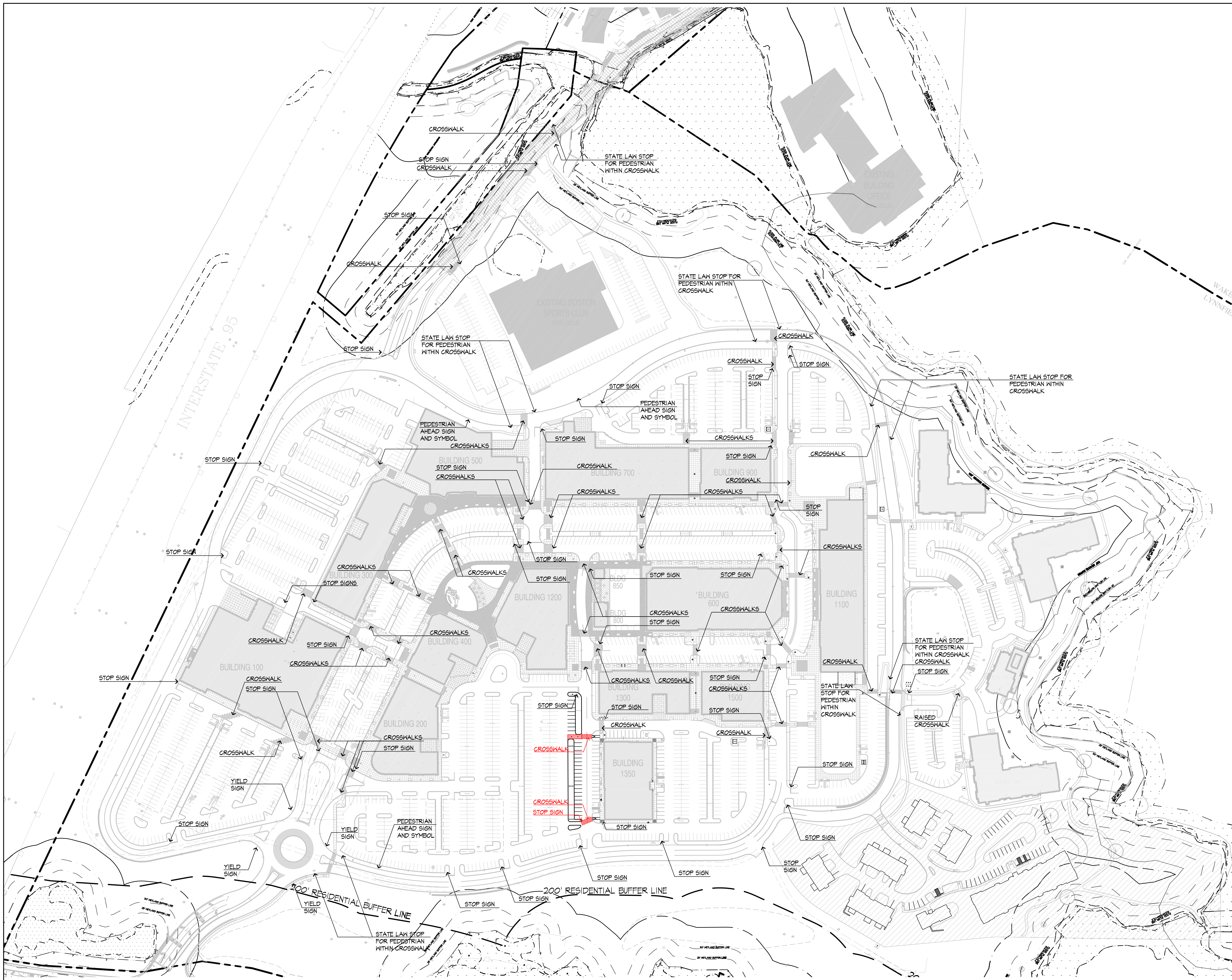

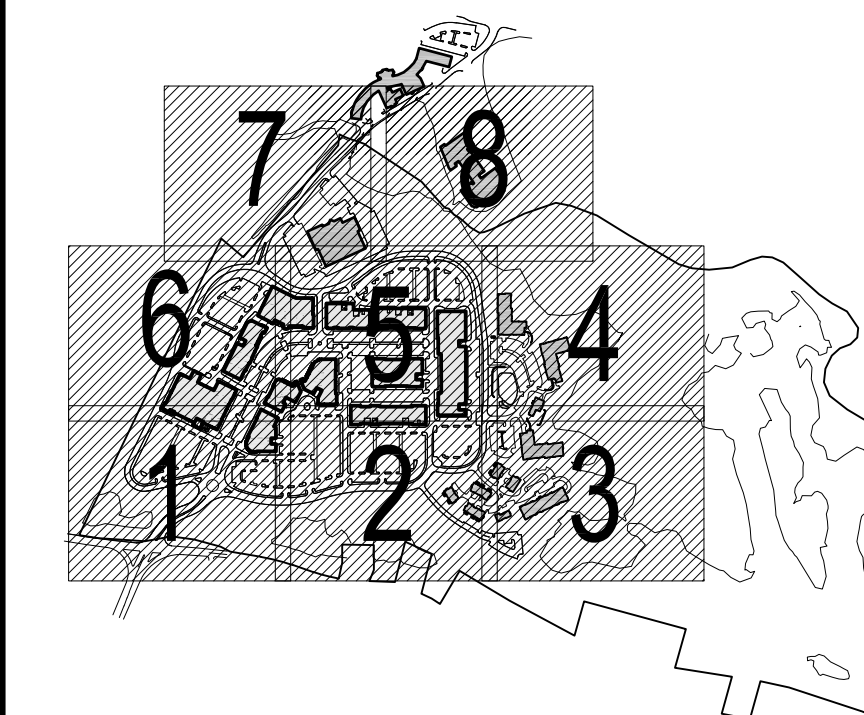
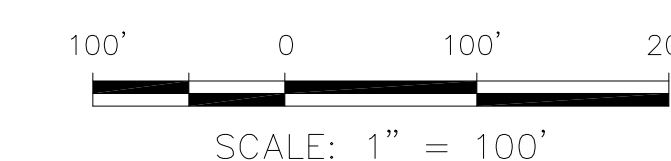

Various revisions	07.18.18
Various revisions	02.24.17
Various revisions	04.28.14
Various revisions	07.30.13
Various revisions	02.01.11
Various revisions	05.02.08
Response to Comments from Crowe	04.04.08
Planned Village Development District Application	01.18.08
Notice of Intent	01.18.08
Issued	MM.DD.YY

File Name: 00677--Parking Areas.dwg
 Dwn. Chkd. MM.DD.YY

Permit-Seal



Applicant/Project
 Market Street South LLC
 c/o National Development
 2310 Washington Street
 Newton Lower Falls, MA 02462
 MARKETSTREET LYNNFIELD
 Lynnfield, MA

Title
 PARKING SUMMARY PLAN

Project No.
 210800677 1"=100'-0"

Drawing No.
 LR- 11.0

RETAIL: 214,639 SF REQUIRED PARKING SPACES: 1 SPACE/250 SF = 1,099 SPACES
RESTAURANT: 97,143 SF REQUIRED PARKING SPACES: 1 SPACE / 200 SF = 490 SPACES
OFFICE: 12,743 SF REQUIRED PARKING SPACES: 1 SPACE / 333 SF = 38 SPACES
MEDICAL OFFICE: 2 SUITES & 26 DOCTORS (25,420 SF) REQUIRED PARKING SPACES: 3 SPACES / SUITE + 26 DOCTORS x 3 = 84 SPACES
TOTAL REQUIRED PARKING SPACES = 1,711
TOTAL PROVIDED PARKING SPACES = 2,224
TOTAL EXCESS PARKING SPACES = 513
HC SPACES REQUIRED: 29 REGULAR + 5 VAN SPACES HC SPACES PROVIDED: 31 REGULAR + 19 VAN SPACES

NOTE:
 1. THE ALLOCATION OF USES IS FOR ESTIMATING PURPOSES ONLY. ACTUAL USES WILL VARY BASED UPON LEASING. PARKING SPACES PROVIDED SHALL BE EQUAL TO OR GREATER THAN THOSE REQUIRED PER THE BY-LAW.
 2. TOTAL RETAIL AND RESTAURANT SPACE IS 364,902 SF.
 3. TOTAL OFFICE SPACE IS 12,743 SF.
 4. TOTAL MEDICAL OFFICE SPACE IS 41,500 SF.

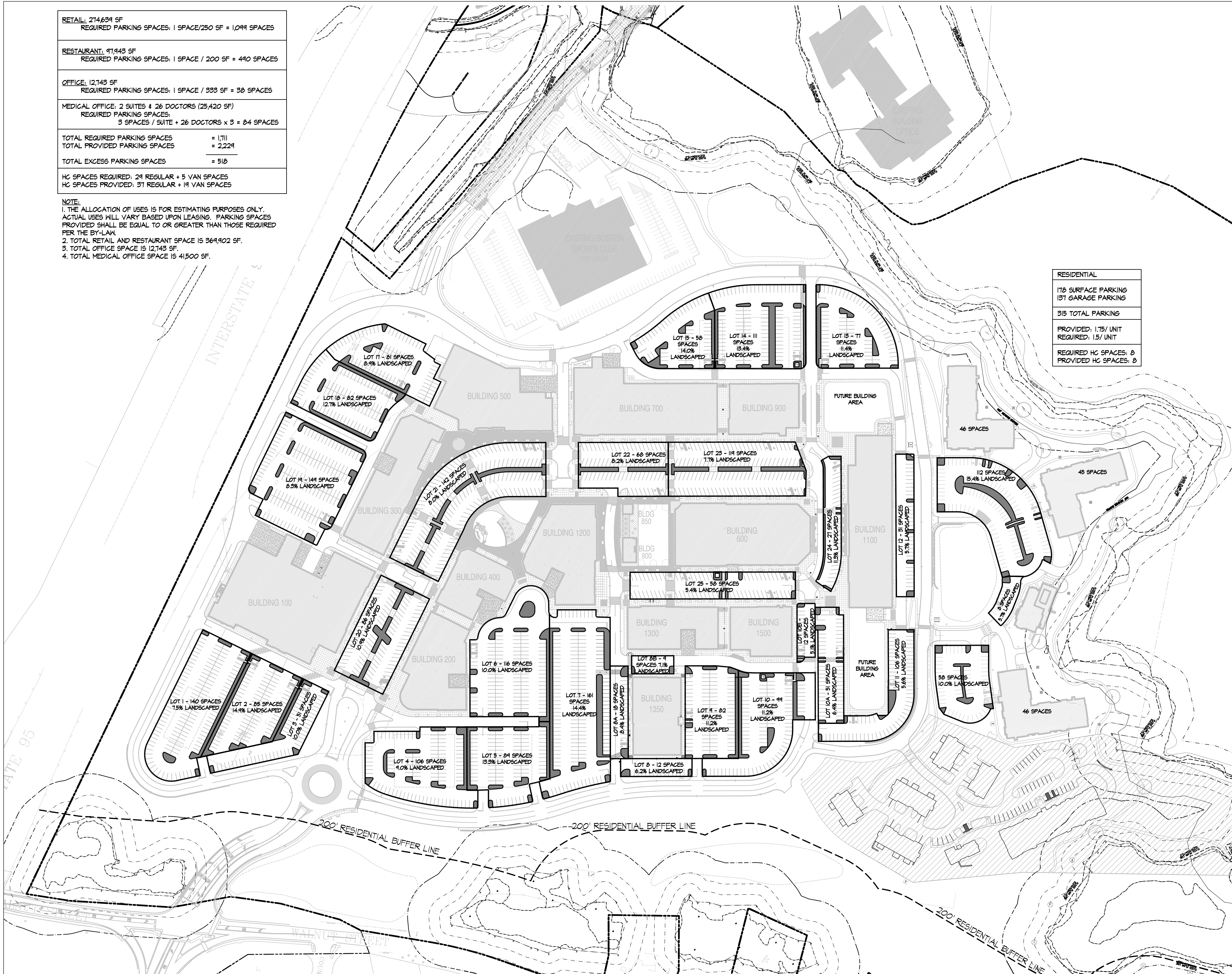

RESIDENTIAL
178 SURFACE PARKING 131 GARAGE PARKING
315 TOTAL PARKING
PROVIDED: 1.75/ UNIT REQUIRED: 1.5/ UNIT
REQUIRED HC SPACES: 8 PROVIDED HC SPACES: 8

LEGEND

 APPROVED DRAWINGS LINEWORK

North Arrow

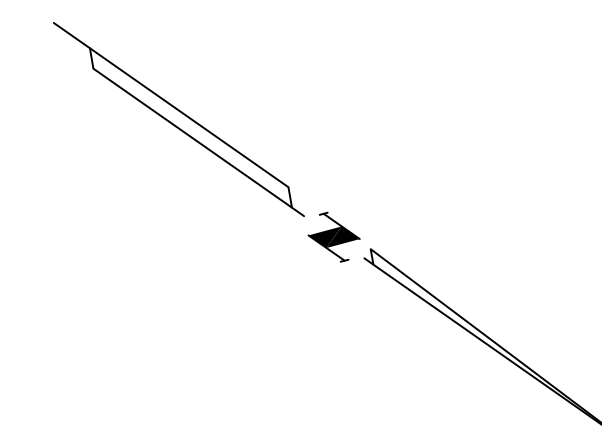

Scale

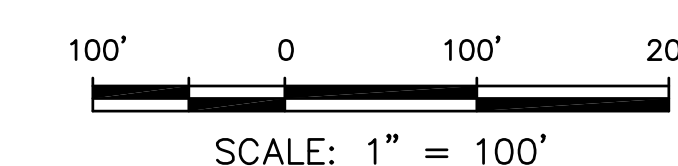

Keymap

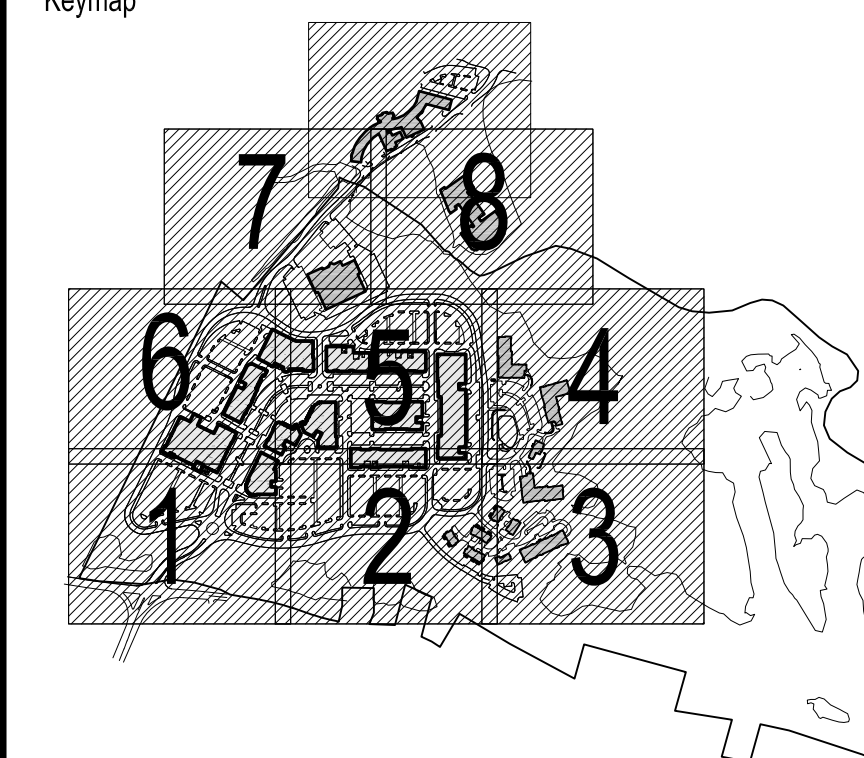

Various revisions	07.18.18
Various revisions	02.24.17
Various revisions	04.28.14
Various revisions	07.30.13
Various revisions	02.01.11
Various revisions	05.02.08
Response to Comments from Crowe	04.04.08
Planned Village Development District Application	01.18.08
Notice of Intent	01.10.08
Issued	MM.DD.YY

File Name: 00677-Redlined_base_plan.dwg
 Dwn. Chkd. MM.DD.YY

Permit-Seal



Applicant/Project

Market Street South LLC
 c/o National Development
 2310 Washington Street
 Newton Lower Falls, MA 02462

MARKETSTREET LYNNFIELD
 Lynnfield, MA

Title

REDLINED OVERALL LAYOUT AND
 MATERIALS PLAN

Project No.
 210800677

1" = 100'-0"

Drawing No.

LR-12.0

