



Massachusetts Department of Environmental Protection
Bureau of Water Resources - Wetlands

WPA Form 1- Request for Determination of Applicability lynnfield
Massachusetts Wetlands Protection Act M.G.L. c. 131, §40 Municipality

A. General Information

Important:
When filling out forms on the computer, use only the tab key to move your cursor - do not use the return key.

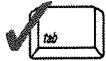

1. Applicant:
mike butter
First Name Last Name
5 timberhill lane
Address
lynnfield ma 01940
City/Town State Zip Code
9783615030 mbutter909@yahoo.com
Phone Number Email Address

2. Property Owner (if different from Applicant):

First Name Last Name

Address

City/Town State Zip Code

Phone Number Email Address (if known)

3. Representative (if any)
jon whyman
First Name Last Name
j whyman
Company Name
451 broadway
Address
lynnfield ma 01940
City/Town State Zip Code
7813342323 jonwhyman@icloud.com
Phone Number Email Address (if known)

B. Project Description

1. a. Project Location (use maps and plans to identify the location of the area subject to this request):
5 timberhill lane lynnfield
Street Address City/Town
2012.15000 10.29.00000
Latitude (Decimal Degrees Format with 5 digits after decimal Longitude (Decimal Degrees Format with 5 digits after decimal e.g. -XX.XXXXX)
e.g. XX.XXXXX)
46 1195
Assessors' Map Number Assessors' Lot/Parcel Number

[How to find Latitude and Longitude](#)

[and how to convert to decimal degrees](#)

b. Area Description (use additional paper, if necessary):
driveway

c. Plan and/or Map Reference(s): (use additional paper if necessary)
plan by serwatka / also linden drain repair plan on file 3/19/24
Title Date

Title Date



B. Project Description (cont.)

2. a. Activity/Work Description (use additional paper and/or provide plan(s) of Activity, if necessary):

dig out peat below driveway and rebuild w rip rap in existing footprint of existing driveway (lower area)

- b. Identify provisions of the Wetlands Protection Act or regulations which may exempt the applicant from having to file a Notice of Intent for all or part of the described work (use additional paper, if necessary).

under area of sq ft disturbance

3. a. If this application is a Request for Determination of Scope of Alternatives for work in the Riverfront Area, indicate the one classification below that best describes the project.

- Single family house on a lot recorded on or before 8/1/96
- Single family house on a lot recorded after 8/1/96
- Expansion of an existing structure on a lot recorded after 8/1/96
- Project, other than a single-family house or public project, where the applicant owned the lot before 8/7/96
- New agriculture or aquaculture project
- Public project where funds were appropriated prior to 8/7/96
- Project on a lot shown on an approved, definitive subdivision plan where there is a recorded deed restriction limiting total alteration of the Riverfront Area for the entire subdivision
- Residential subdivision; institutional, industrial, or commercial project
- Municipal project
- District, county, state, or federal government project
- Project required to evaluate off-site alternatives in more than one municipality in an Environmental Impact Report under MEPA or in an alternatives analysis pursuant to an application for a 404 permit from the U.S. Army Corps of Engineers or 401 Water Quality Certification from the Department of Environmental Protection.

- b. Provide evidence (e.g., record of date subdivision lot was recorded) supporting the classification above (use additional paper and/or attach appropriate documents, if necessary.)

lower area driveway



Massachusetts Department of Environmental Protection
Bureau of Water Resources - Wetlands

WPA Form 1- Request for Determination of Applicability lynnfield
Massachusetts Wetlands Protection Act M.G.L. c. 131, §40 Municipality

C. Determinations

1. I request the lynnfield Conservation Commission make the following determination(s). Check any that apply:

- a. whether the **area** depicted on plan(s) and/or map(s) referenced above is an area subject to jurisdiction of the Wetlands Protection Act.
- b. whether the **boundaries** of resource area(s) depicted on plan(s) and/or map(s) referenced above are accurately delineated.
- c. whether the **Activities** depicted on plan(s) referenced above is subject to the Wetlands Protection Act and its regulations.
- d. whether the area and/or Activities depicted on plan(s) referenced above is subject to the jurisdiction of any **municipal wetlands' ordinance or bylaw** of:

Name of Municipality

- e. whether the following **scope of alternatives** is adequate for Activities in the Riverfront Area as depicted on referenced plan(s).
- _____

D. Signatures and Submittal Requirements

I hereby certify under the penalties of perjury that the foregoing Request for Determination of Applicability and accompanying plans, documents, and supporting data are true and complete to the best of my knowledge.

I further certify that the property owner, if different from the applicant, and the appropriate DEP Regional Office were sent a complete copy of this Request (including all appropriate documentation) simultaneously with the submittal of this Request to the Conservation Commission.

Failure by the applicant to send copies in a timely manner may result in dismissal of the Request for Determination of Applicability.

Signatures:

I also understand that notification of this Request will be placed in a local newspaper at my expense in accordance with Section 10.05(3)(b)(1) of the Wetlands Protection Act regulations.

mike butter

Signature of Applicant

3/19/24

Date

jon whyman

Signature of Representative (if any)

3/19/24

Date

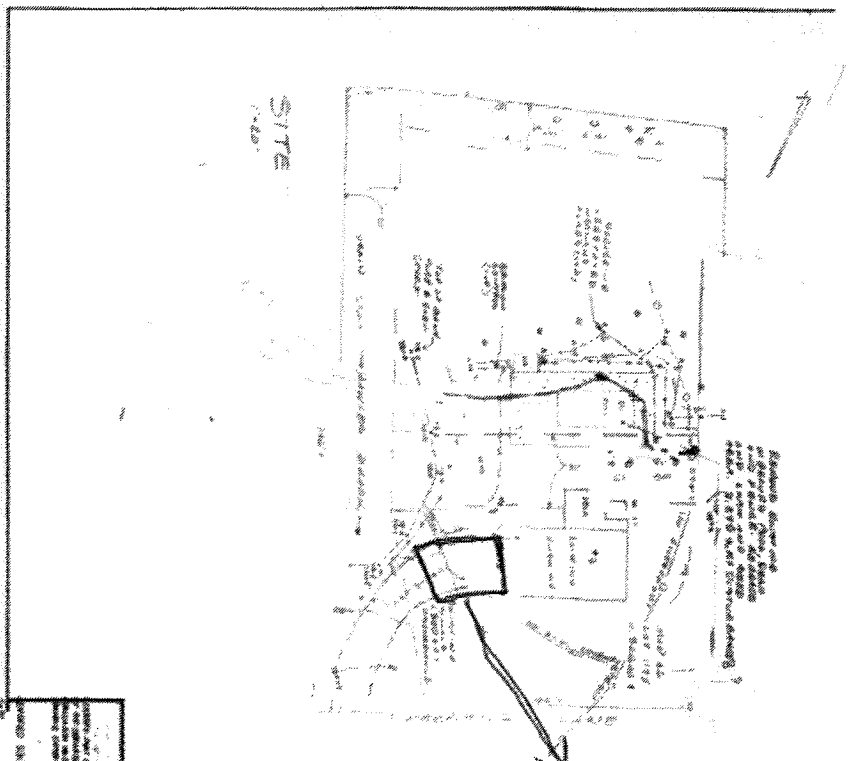

R/R lower portion of existing driveway. Dig out past below driveway and rebuild with rip rap in existing footprint.

R/R existing retaining wall

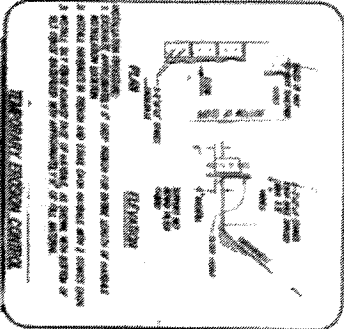

NO. 1	NO. 2	NO. 3	NO. 4	NO. 5	NO. 6	NO. 7	NO. 8	NO. 9	NO. 10	NO. 11	NO. 12	NO. 13	NO. 14	NO. 15	NO. 16	NO. 17	NO. 18	NO. 19	NO. 20	NO. 21	NO. 22	NO. 23	NO. 24	NO. 25	NO. 26	NO. 27	NO. 28	NO. 29	NO. 30	NO. 31	NO. 32	NO. 33	NO. 34	NO. 35	NO. 36	NO. 37	NO. 38	NO. 39	NO. 40	NO. 41	NO. 42	NO. 43	NO. 44	NO. 45	NO. 46	NO. 47	NO. 48	NO. 49	NO. 50
-------	-------	-------	-------	-------	-------	-------	-------	-------	--------	--------	--------	--------	--------	--------	--------	--------	--------	--------	--------	--------	--------	--------	--------	--------	--------	--------	--------	--------	--------	--------	--------	--------	--------	--------	--------	--------	--------	--------	--------	--------	--------	--------	--------	--------	--------	--------	--------	--------	--------

PLAN TO ACCOMPANY A NOTICE OF INTEREST FOR STAMENHILL LAKE (SH-46, SH-1280) LINNAPPELLA, VA



James L. [Name], P.E.
 License No. 12345
 State of Virginia, 12/31/2024

NOT TO SCALE
 THIS DRAWING IS THE PROPERTY OF THE ENGINEER AND IS NOT TO BE REPRODUCED OR TRANSMITTED IN ANY FORM OR BY ANY MEANS, ELECTRONIC OR MECHANICAL, INCLUDING PHOTOCOPYING, RECORDING, OR BY ANY INFORMATION STORAGE AND RETRIEVAL SYSTEM, WITHOUT THE WRITTEN PERMISSION OF THE ENGINEER.

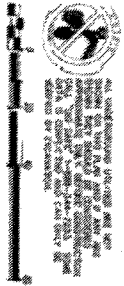

NO.	DATE	DESCRIPTION
1	01/01/2010	ISSUED FOR PERMIT
2	01/01/2010	ISSUED FOR PERMIT
3	01/01/2010	ISSUED FOR PERMIT
4	01/01/2010	ISSUED FOR PERMIT
5	01/01/2010	ISSUED FOR PERMIT

BLINDEN ENGINEERING PARTNERS LLC
 100 Washington St., 10th Fl.
 Boston, MA 02108-1000
 TEL: (617) 552-3211 FAX: (617) 552-3212
 www.blinden.com

PREPARED FOR:
TOWN OF LYNNFIELD, MA
 DEPARTMENT OF PUBLIC WORKS
 TOWN HALL, 55 SUMNER STREET
 LYNNFIELD, MASSACHUSETTS 01940
 TEL: (978) 344-6800

PROPOSED IMPROVEMENTS PLAN - **TIMBERHILL LANE**
 ROADWAY IMPROVEMENT PROJECT
 FLETCHER ROAD AND **TIMBERHILL LANE**
 LYNNFIELD, MASSACHUSETTS

TIMBERHILL LANE
 R/R lower portion of existing driveway. Dig out peat below driveway and rebuild with rip rap in existing footprint.
 R/R existing retaining wall

NEW DRAINAGE CONSTRUCTION NOTES:
 1. ALL DRAINAGE CONSTRUCTION SHALL BE IN ACCORDANCE WITH THE LATEST EDITIONS OF THE MASSACHUSETTS DEPARTMENT OF TRANSPORTATION AND CONSTRUCTION (MASC) STANDARD SPECIFICATIONS FOR HIGHWAYS AND BRIDGES, AND THE MASSACHUSETTS DEPARTMENT OF ENVIRONMENTAL AFFAIRS (DEA) REGULATIONS FOR WETLANDS AND RIVERFRONT AREAS.
 2. ALL DRAINAGE CONSTRUCTION SHALL BE DESIGNED BY THE FIELD ENGINEER OF THE TOWN OF LYNNFIELD.

