







LEGEND OF SYMBOLS

- PROPOSED WATERSHED BOUNDARY 
- EXISTING SOIL BOUNDARY 
- TIME OF CONCENTRATION FLOW PATH 
- SUBCATCHMENT DESIGNATION 
- HYDROLOGIC SOIL GROUP 
- COMPARISON BOUNDARY DESIGNATION 

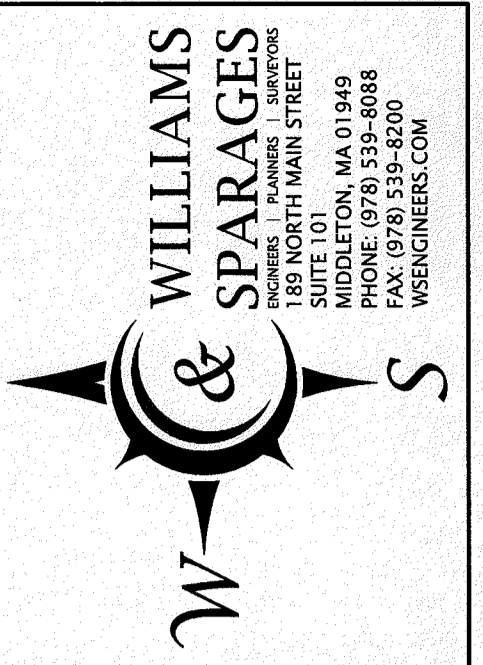
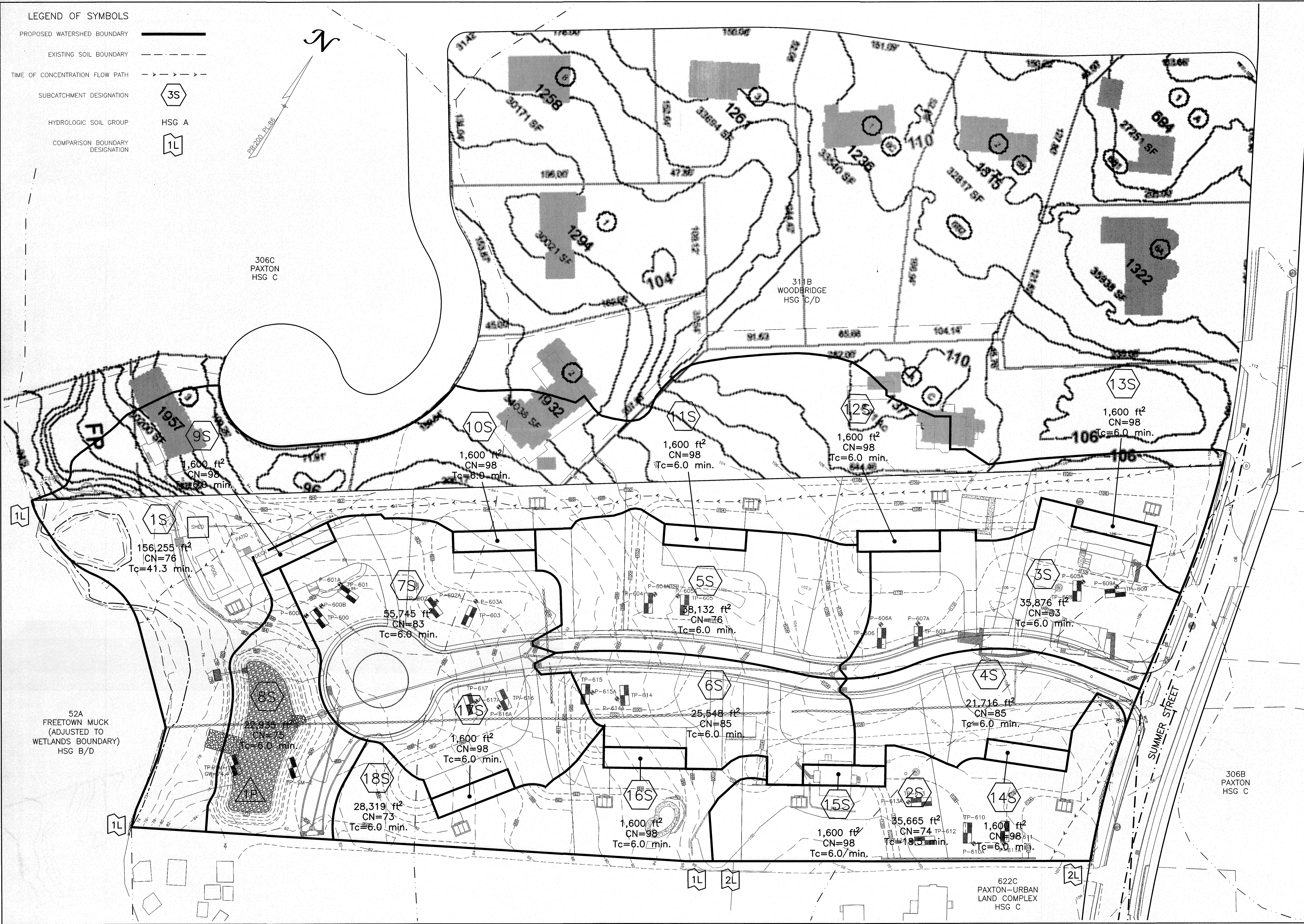
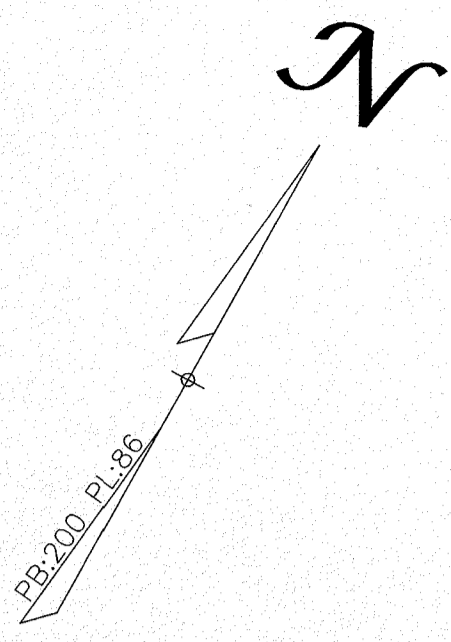

Owner: See Subdivision Plan Sheet Set
 Applicant: HDI, LLC
 23 Stiles Road, Suite 104
 Salem, NH 03079

Designed By: MEM
 Drawn By: MEM
 Reviewed By: CPS
 Project Manager: CPS
 Job File Number: LYNF-0100
 Drawing File Folder: LYNF100

Drawing Issued for Review Only
 Drawing Issued for Permit
 Drawing Issued for Construction

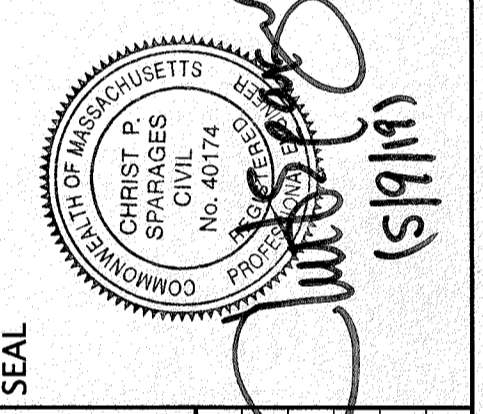

PROPOSED CONDITION WATERSHED MAP
ROAD A
 #333, 339 & 357 SUMMER STREET, LYNNFIELD, MA

DRAWING: W2
 SHEET 1 OF 1

NOVEMBER 21, 2018

SCALE: 1"=40'

TOWN COMMENTS/PEER REVIEW

6	5	4	3	2	1
					5/9/2019

PLANNING-01-000339 & 340 Summer Street (Hatch Drawing) (Drawing#233826) 02.dwg, 5/10/2019 9:15:59 AM, CPS