







LEGEND OF SYMBOLS

- EXISTING WATERSHED BOUNDARY 
- EXISTING SOIL BOUNDARY 
- TIME OF CONCENTRATION FLOW PATH 
- SUBCATCHMENT DESIGNATION 
- HYDROLOGIC SOIL GROUP HSG C 
- COMPARISON BOUNDARY DESIGNATION 

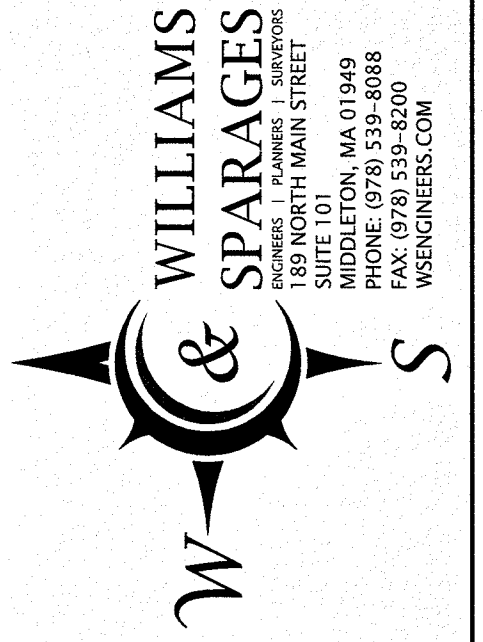
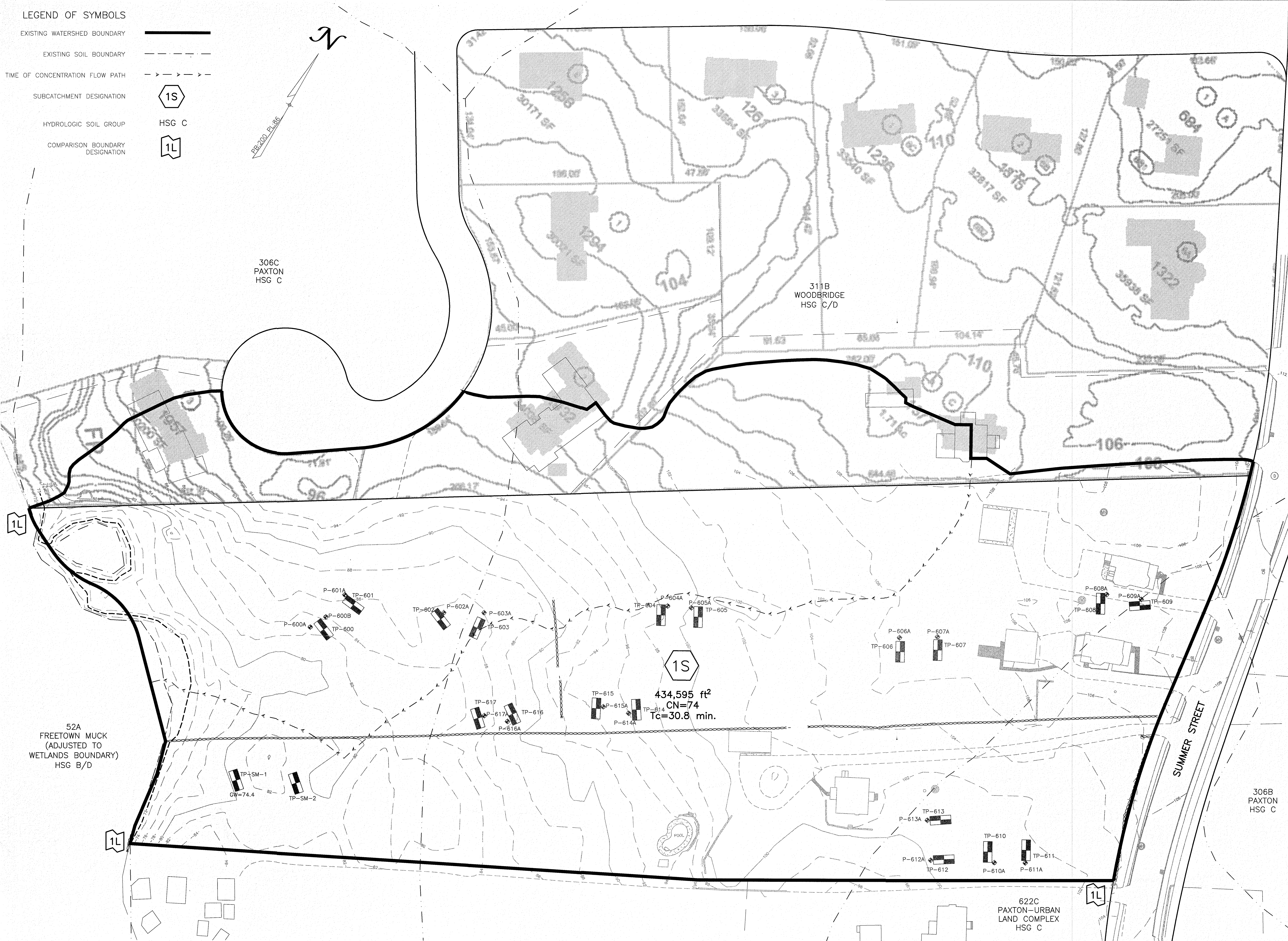
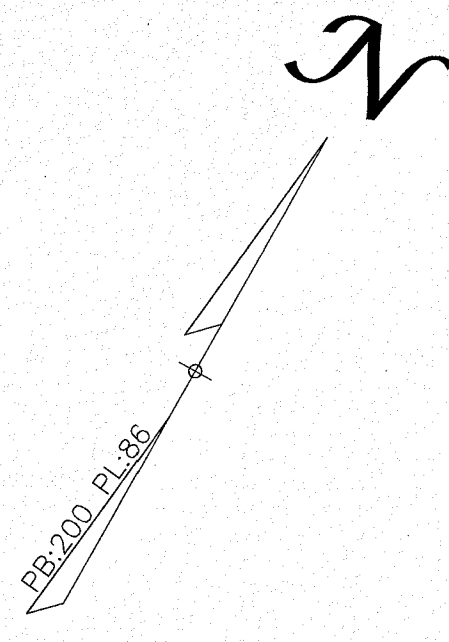

Owner:
See Subdivision Plan Sheet Set

Applicator:
HDI, LLC
23 Stries Road, Suite 104
Salem, NH 03079

Designed By: MEM
Drawn By: MEM
Reviewed By: CPS
Project Manager: CPS
Job File Number: LYNF-0100
Drawing File Folder: LYNF100

Drawing Issued for Review Only
 Drawing Issued for Permit
 Drawing Issued for Construction

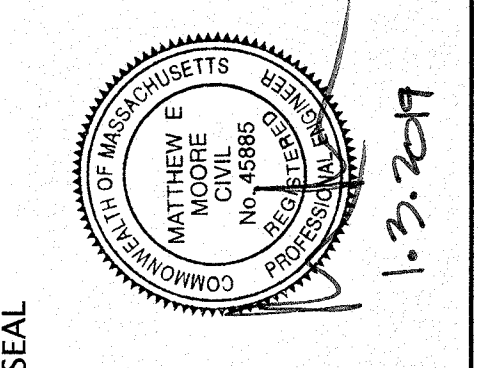

SEAL

EXISTING CONDITION WATERSHED MAP
ROAD A
#333, 339 & 357 SUMMER STREET, LYNNFIELD, MA

DRAWING: W1







SHEET 1 OF 1

SCALE: 1"=40'

NOVEMBER 21, 2018

PLN: 11/10/2018 8:45 AM Summer Street\Drawings\333306.dwg 11/21/2018 6:03:24 AM 1421

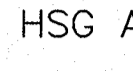
LEGEND OF SYMBOLS

- PROPOSED WATERSHED BOUNDARY 
- EXISTING SOIL BOUNDARY 
- TIME OF CONCENTRATION FLOW PATH 
- SUBCATCHMENT DESIGNATION 
- HYDROLOGIC SOIL GROUP 
- COMPARISON BOUNDARY DESIGNATION 

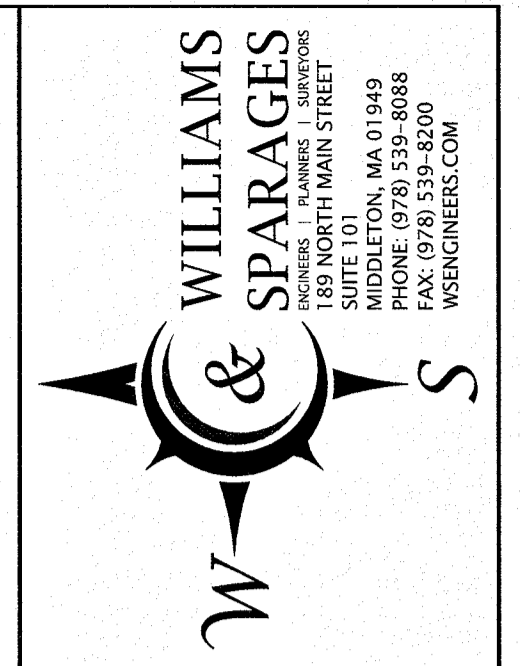
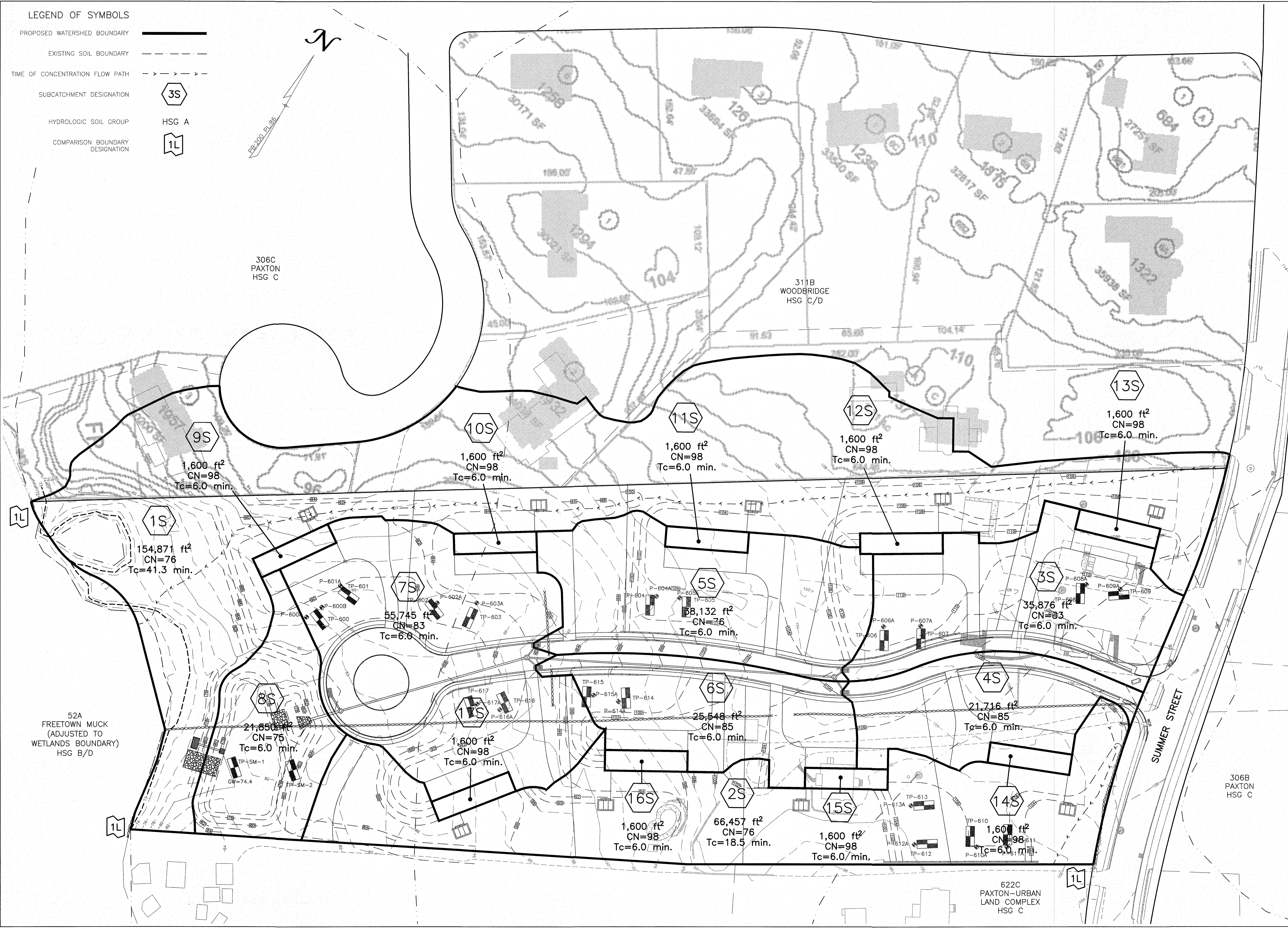
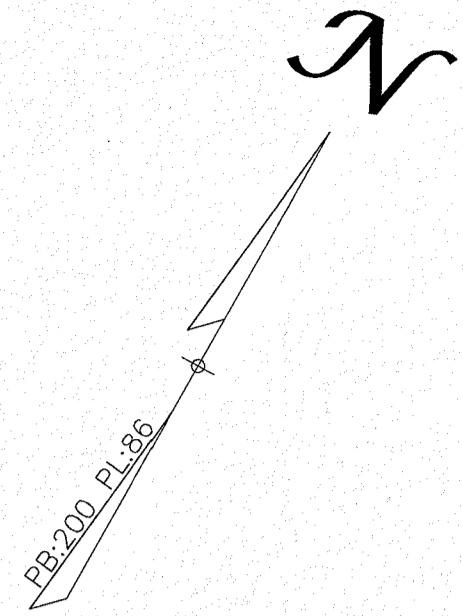

Owner: See Subdivision Plan Sheet Set
 Applicant: HDI, LLC
 23 Stiles Road, Suite 104
 Salem, NH 03079

Designed By: MEM
 Drawn By: MEM
 Project Manager: CPS
 Job File Number: LYNF-0100
 Drawing File Folder: LYNF100

Drawing Issued for Permit Only
 Drawing Issued for Review
 Drawing Issued for Construction

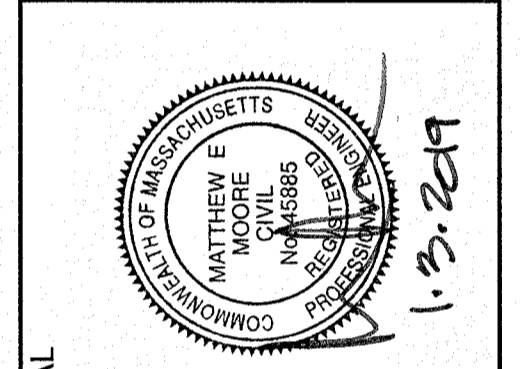

PROPOSED CONDITION WATERSHED MAP
 ROAD A

#333, 339 & 357 SUMMER STREET, LYNNFIELD, MA

0' 20' 40' 80'
 SCALE: 1"=40'
 NOVEMBER 21, 2018

DRAWING: W2
 SHEET 1 OF 1

P:\V\0100338 & 348 Summer Street\Drawings\Drawings\333348.dwg, 12/07/18 6:11:45 AM, MEM

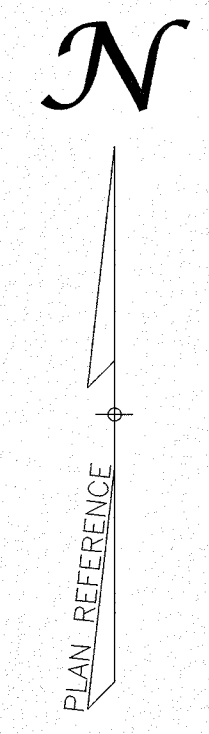
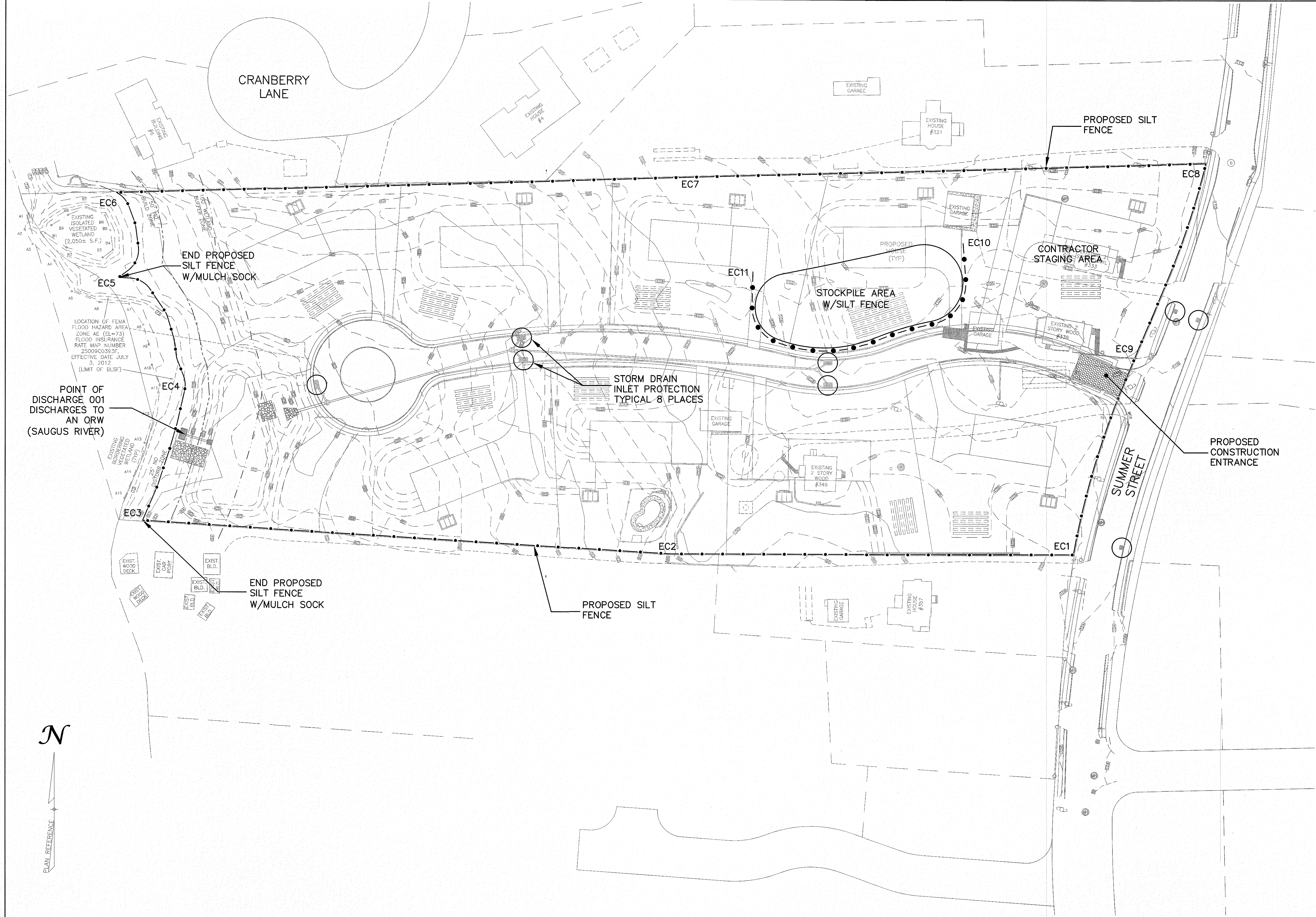

WILLIAMS & SPARAGES
 ENGINEERS
 189 NORTH MAIN STREET
 SALEM, NH 03079
 PHONE (603) 883-8200
 FAX (603) 883-8201
 WWW.WSPE.COM

Owner: See subdivision plan set
 Applicant: HPI, LLC
 23 Stiles Road, Suite 104
 Salem, NH 03079

Designed By: MEM
 Drawn By: MEM
 Project Manager: CPS
 Job File Number: LYBF-0100
 Drawing File Folder: LYNF100

Drawing issued for Review Only
 Drawing issued for Permit
 Drawing issued for Construction

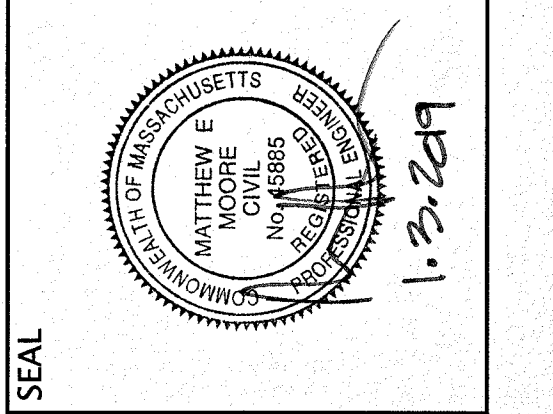

STORMWATER POLLUTION PREVENTION PLAN SITE MAP
ROAD A
 333, 339 & 349 SUMMER STREET, LYNNFIELD, MA

DRAWING: E1.1
 SHEET 1 OF 2

SCALE: 1"=40'
 NOVEMBER 21, 2018

P:\NF\0100391 & 349 Summer St\DWG\SWPPP\sumpp\sumpp.dwg, 1/21/2018 6:25:11 AM, MEM

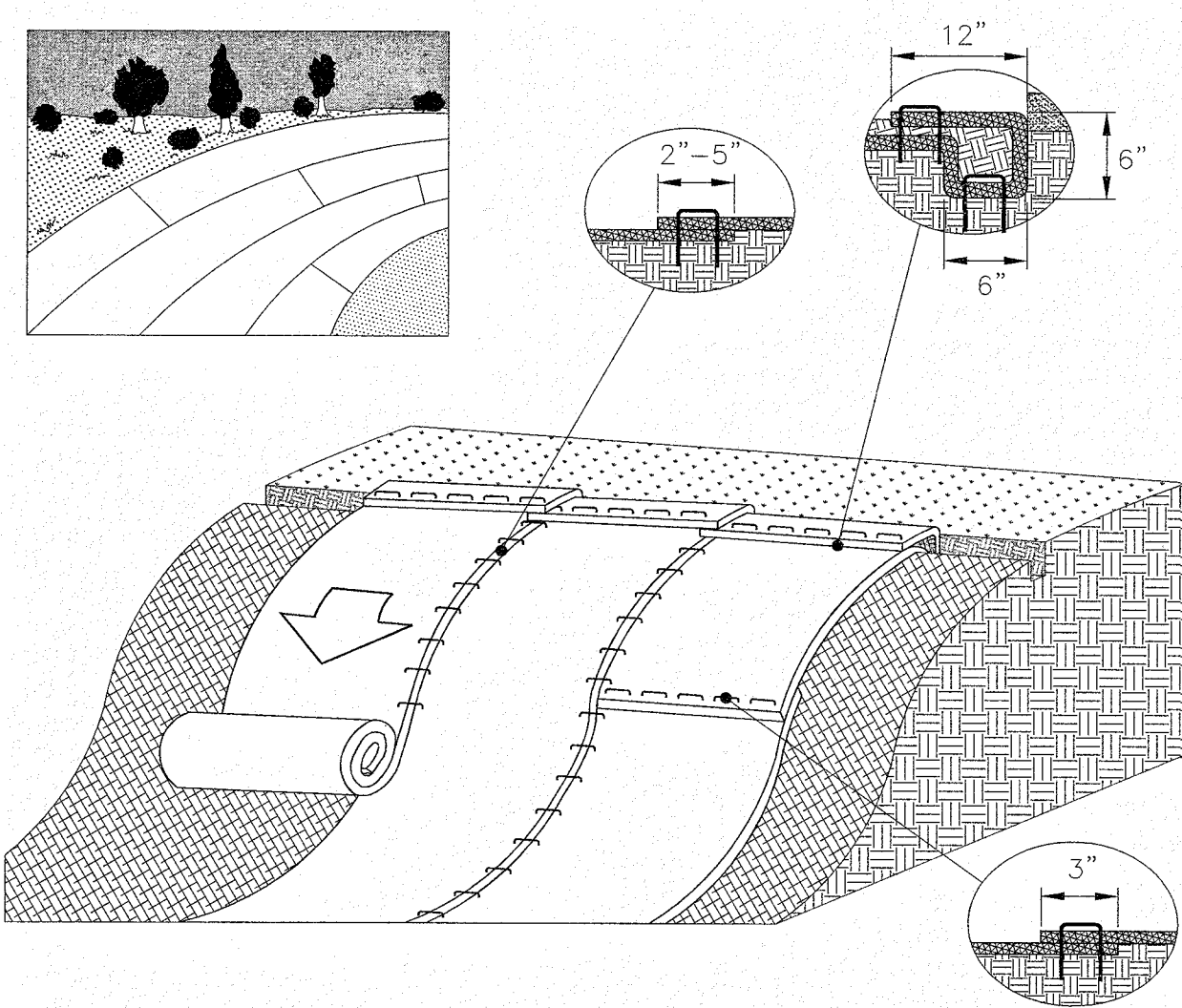
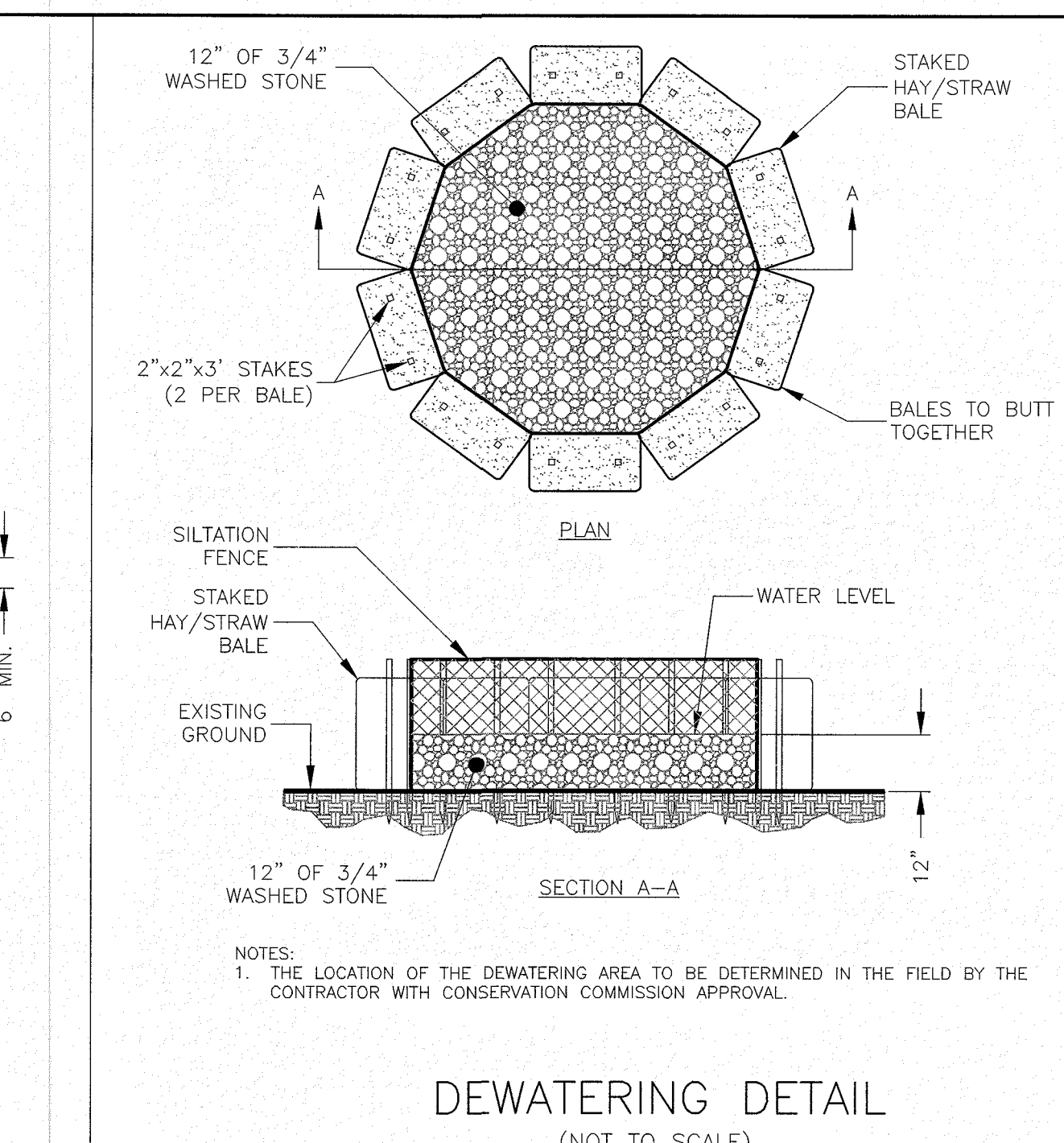
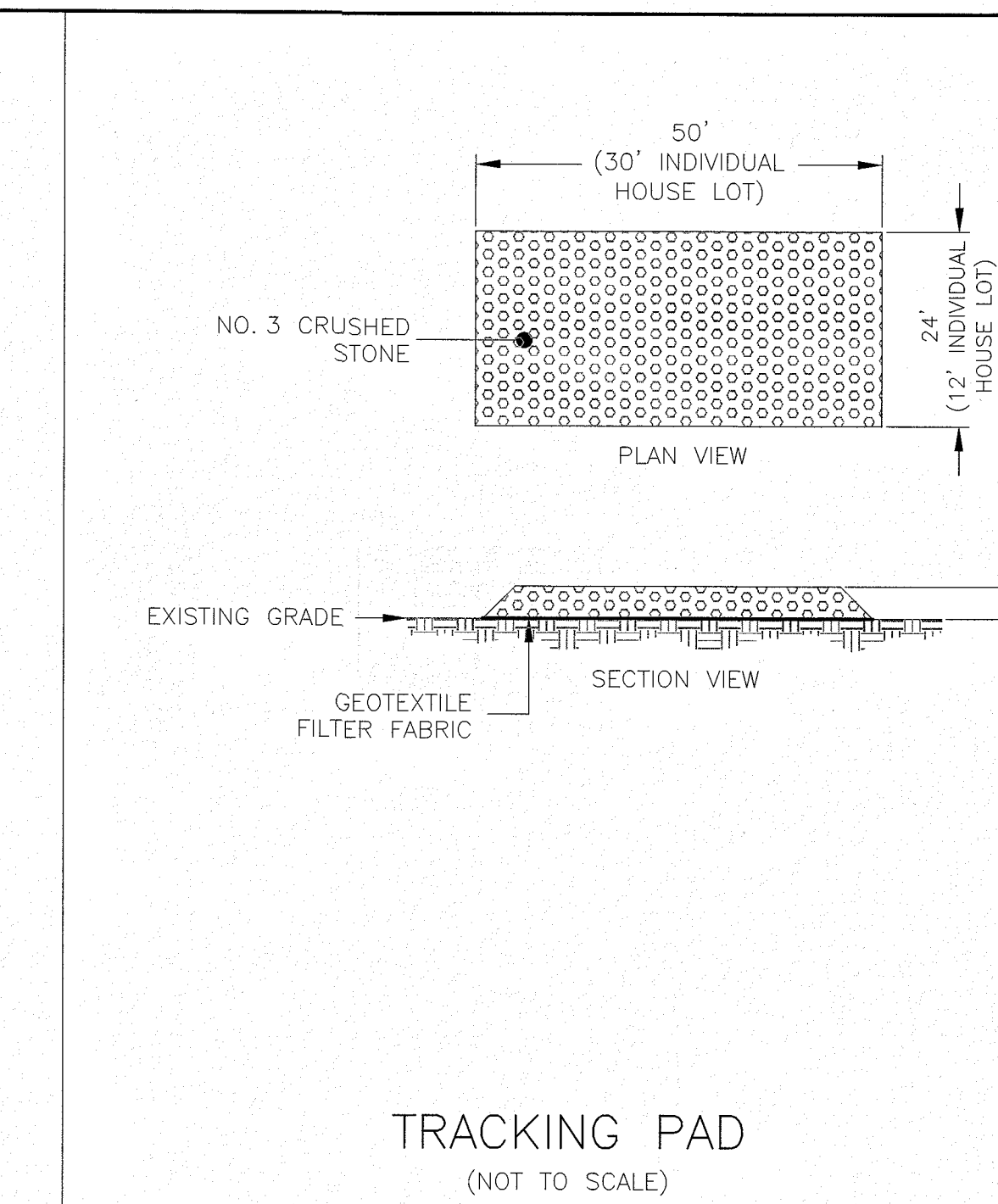
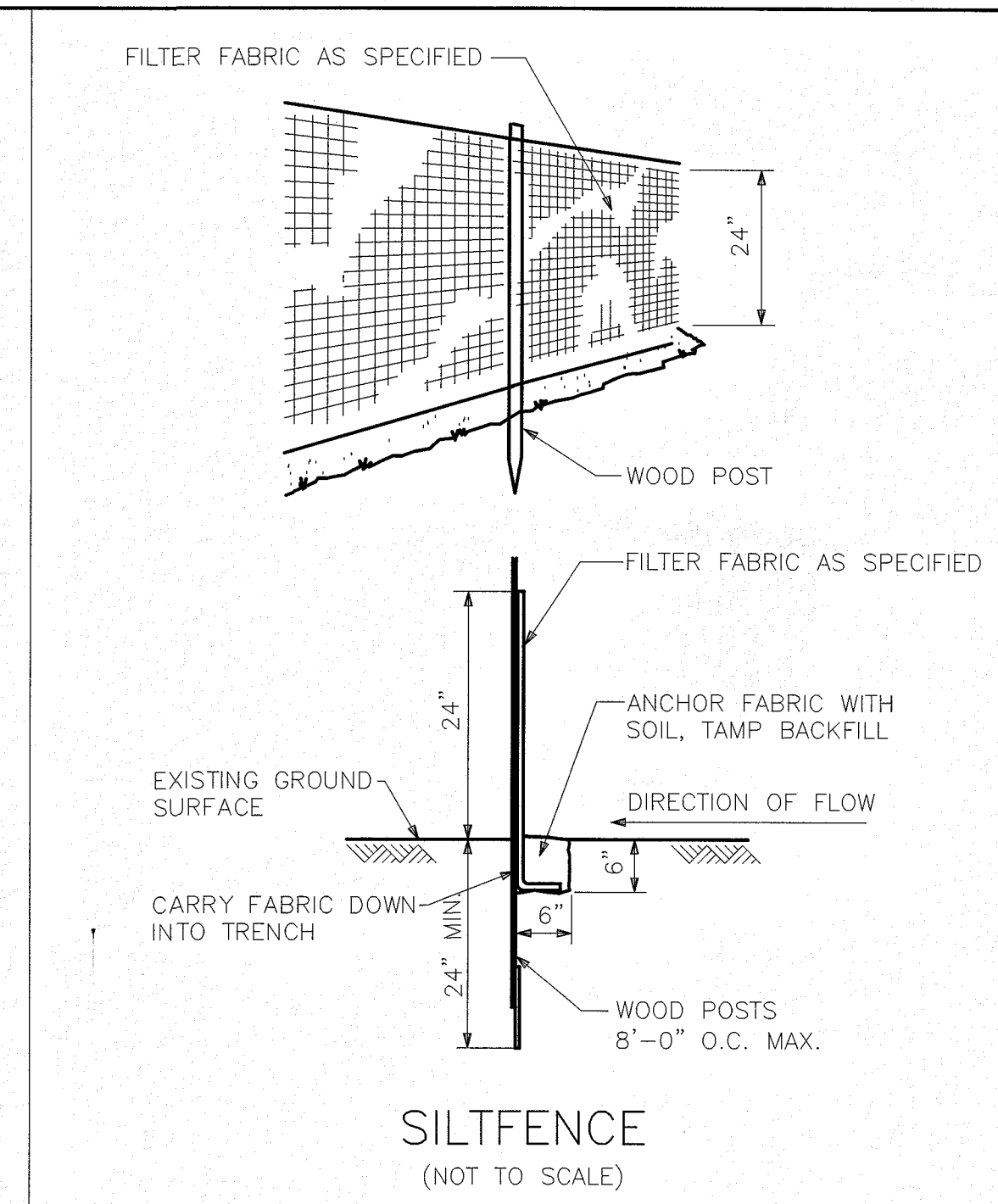
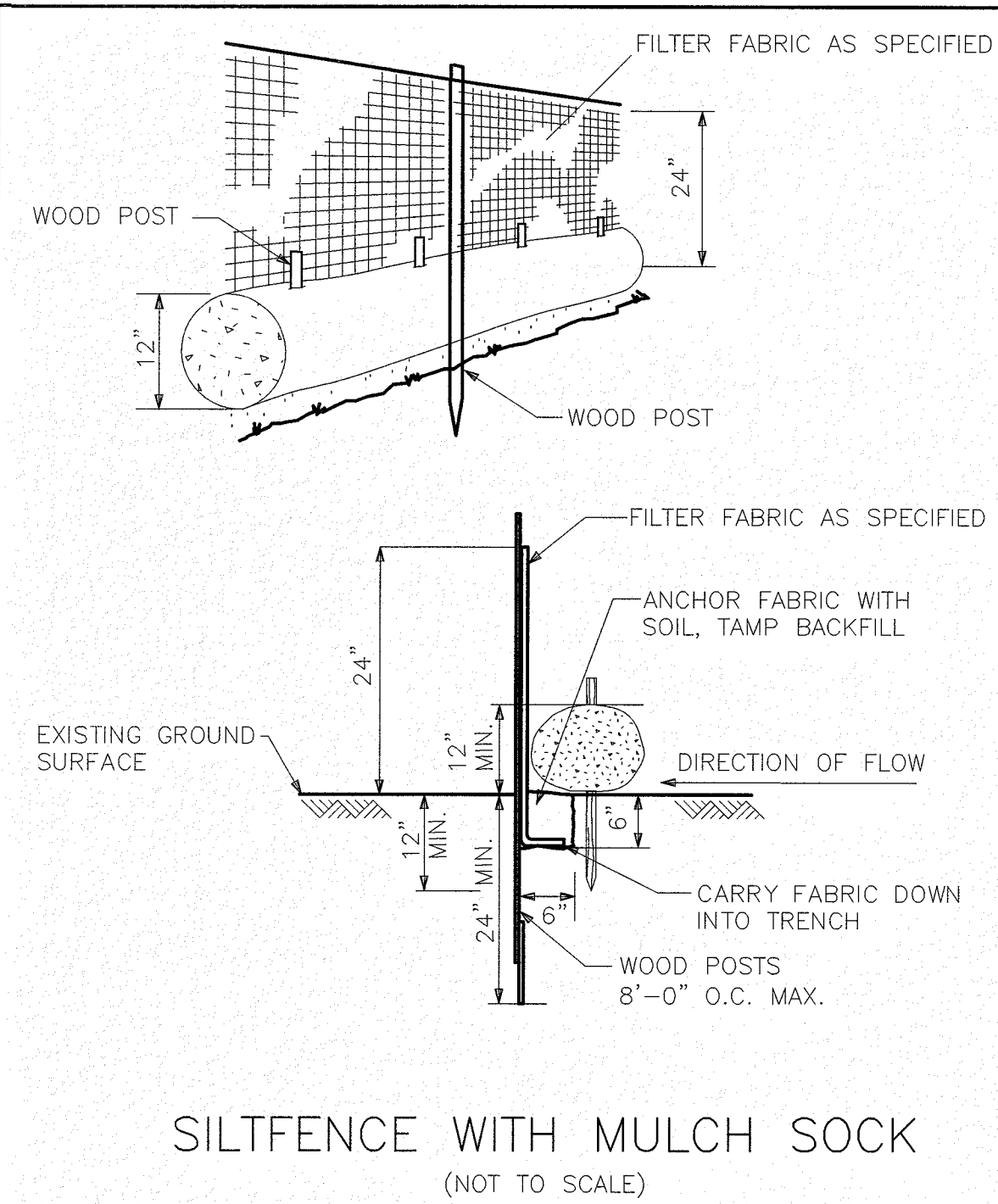
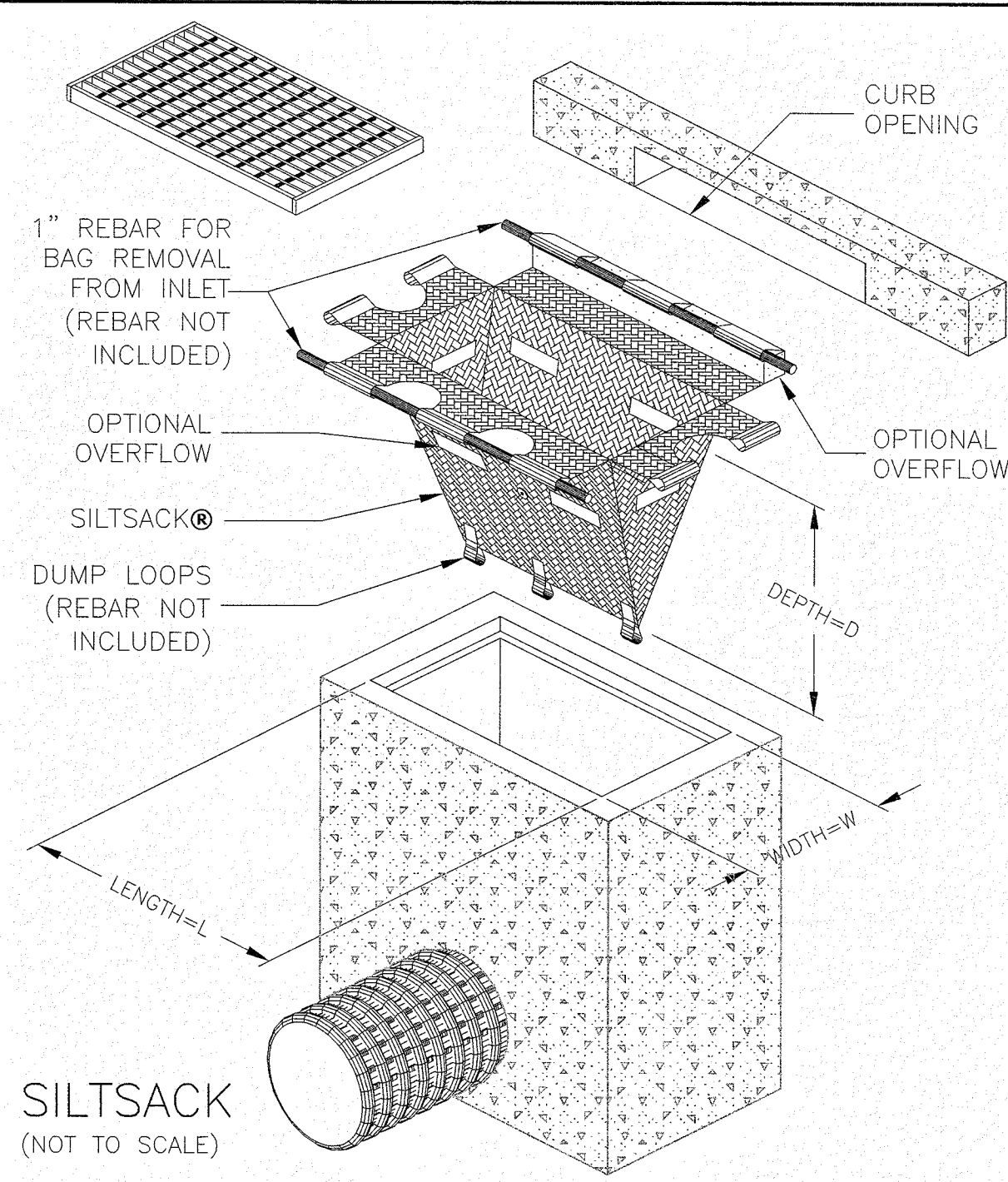

1. PREPARE SOIL BEFORE INSTALLING ROLLED EROSION CONTROL PRODUCTS (RECPS), INCLUDING ANY NECESSARY APPLICATION OF LIME, FERTILIZER, AND SEED.
2. BEGIN AT THE TOP OF THE SLOPE BY ANCHORING THE RECPS IN A 6" (15CM) DEEP X 6" (15CM) WIDE TRENCH WITH APPROXIMATELY 12" (30CM) OF RECPS EXTENDED BEYOND THE UP-SLOPE PORTION OF THE TRENCH. ANCHOR THE RECPS WITH A ROW OF STAPLES/STAKES APPROXIMATELY 12" (30CM) APART IN THE BOTTOM OF THE TRENCH. BACKFILL AND COMPACT THE TRENCH AFTER STAPLING. APPLY SEED TO THE COMPACTED SOIL AND FOLD THE REMAINING 12" (30CM) PORTION OF RECPS BACK OVER THE SEED AND COMPACTED SOIL. SECURE RECPS OVER COMPACTED SOIL WITH A ROW OF STAPLES/STAKES SPACED APPROXIMATELY 12" (30CM) APART ACROSS THE WIDTH OF THE RECPS.
3. ROLL THE RECPS (A) DOWN OR (B) HORIZONTALLY ACROSS THE SLOPE. RECPS WILL UNROLL WITH APPROPRIATE SIDE AGAINST THE SOIL SURFACE. ALL RECPS MUST BE SECURELY FASTENED TO SOIL SURFACE BY PLACING STAPLES/STAKES IN APPROPRIATE LOCATIONS AS SHOWN IN THE STAPLE PATTERN GUIDE.
4. THE EDGES OF PARALLEL RECPS MUST BE STAPLED WITH APPROXIMATELY 2" - 5" (5-12.5CM) OVERLAP DEPENDING ON THE RECPS TYPE.
5. CONSECUTIVE RECPS SPICED DOWN THE SLOPE MUST BE END OVER END (SHINGLE STYLE) WITH AN APPROXIMATE 3" (7.5CM) OVERLAP. STAPLE THROUGH OVERLAPPED AREA, APPROXIMATELY 12" (30CM) APART ACROSS ENTIRE RECPS WIDTH.
6. IN LOOSE SOIL CONDITIONS, THE USE OF STAPLE OR STAKE LENGTHS GREATER THAN 6" (15CM) MAY BE NECESSARY TO PROPERLY SECURE THE RECPS.

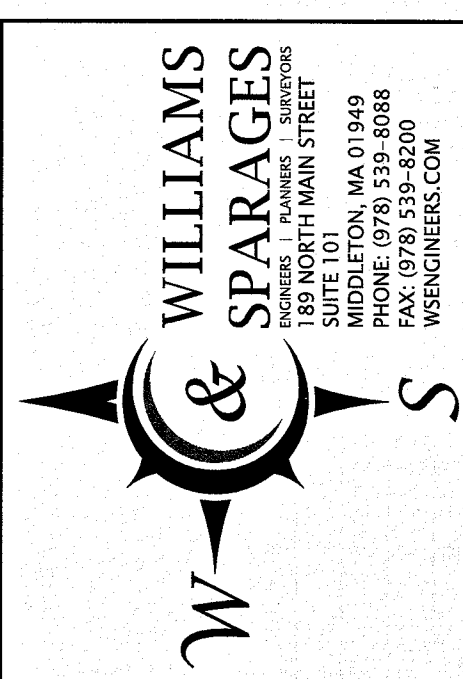
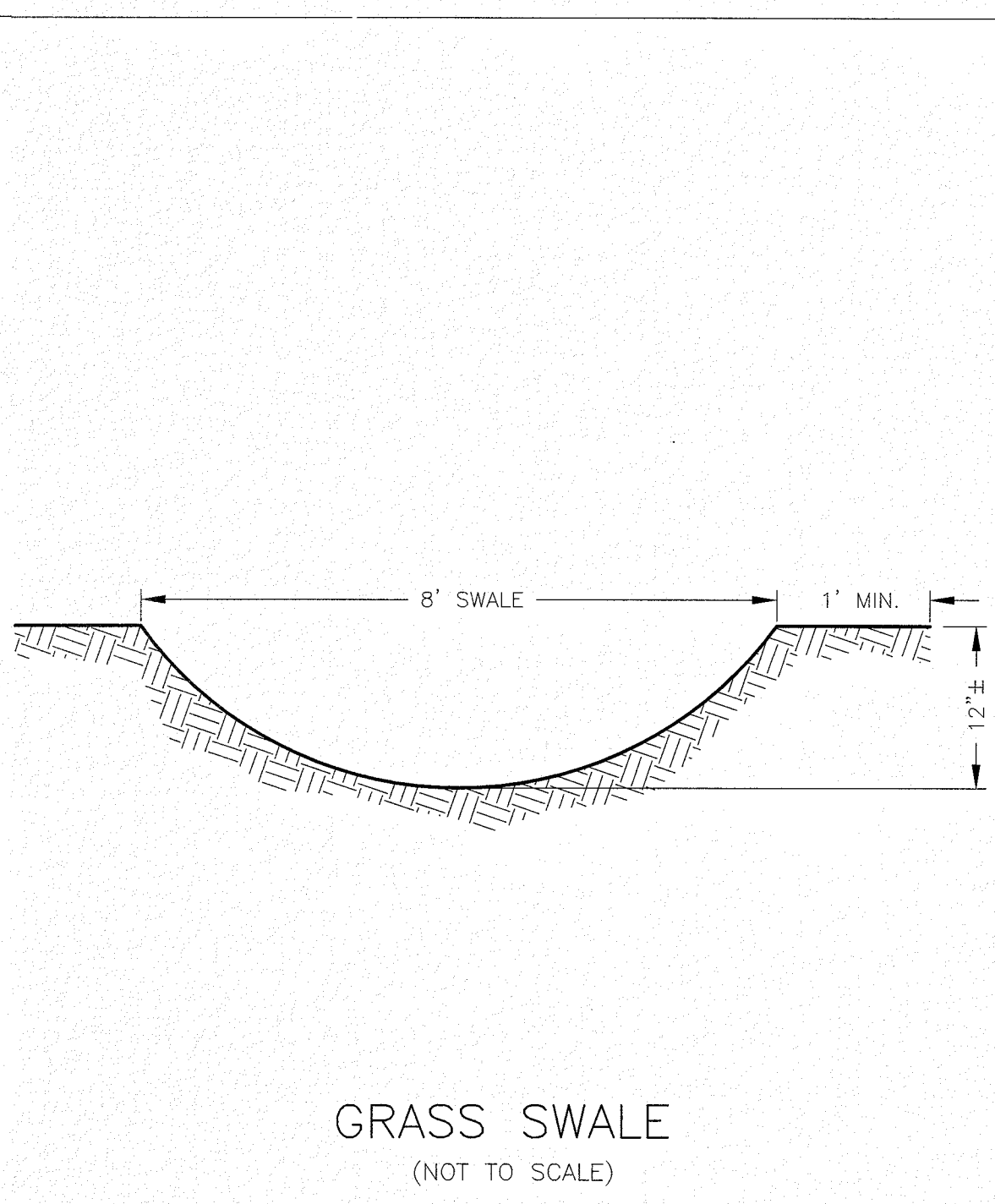
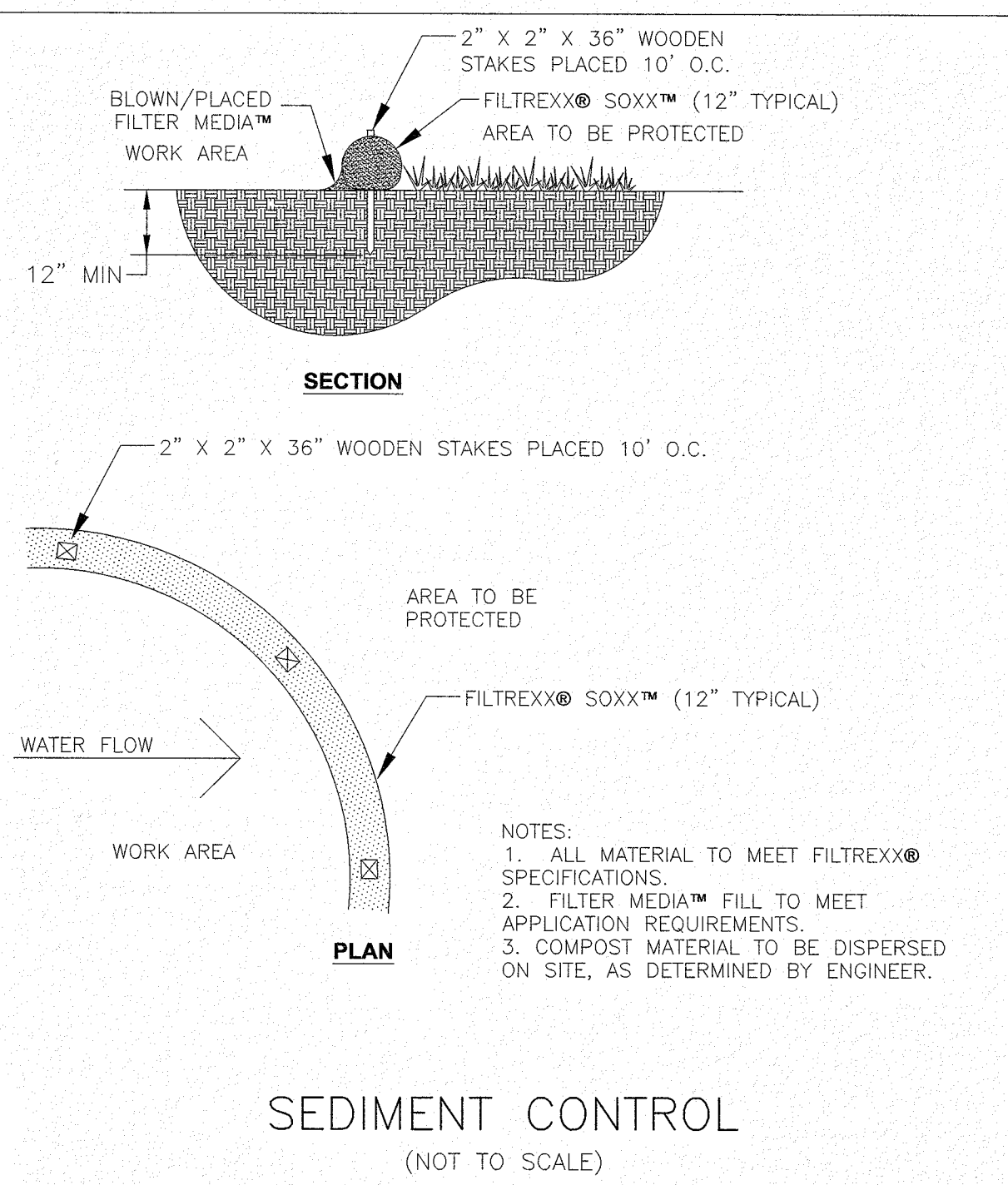
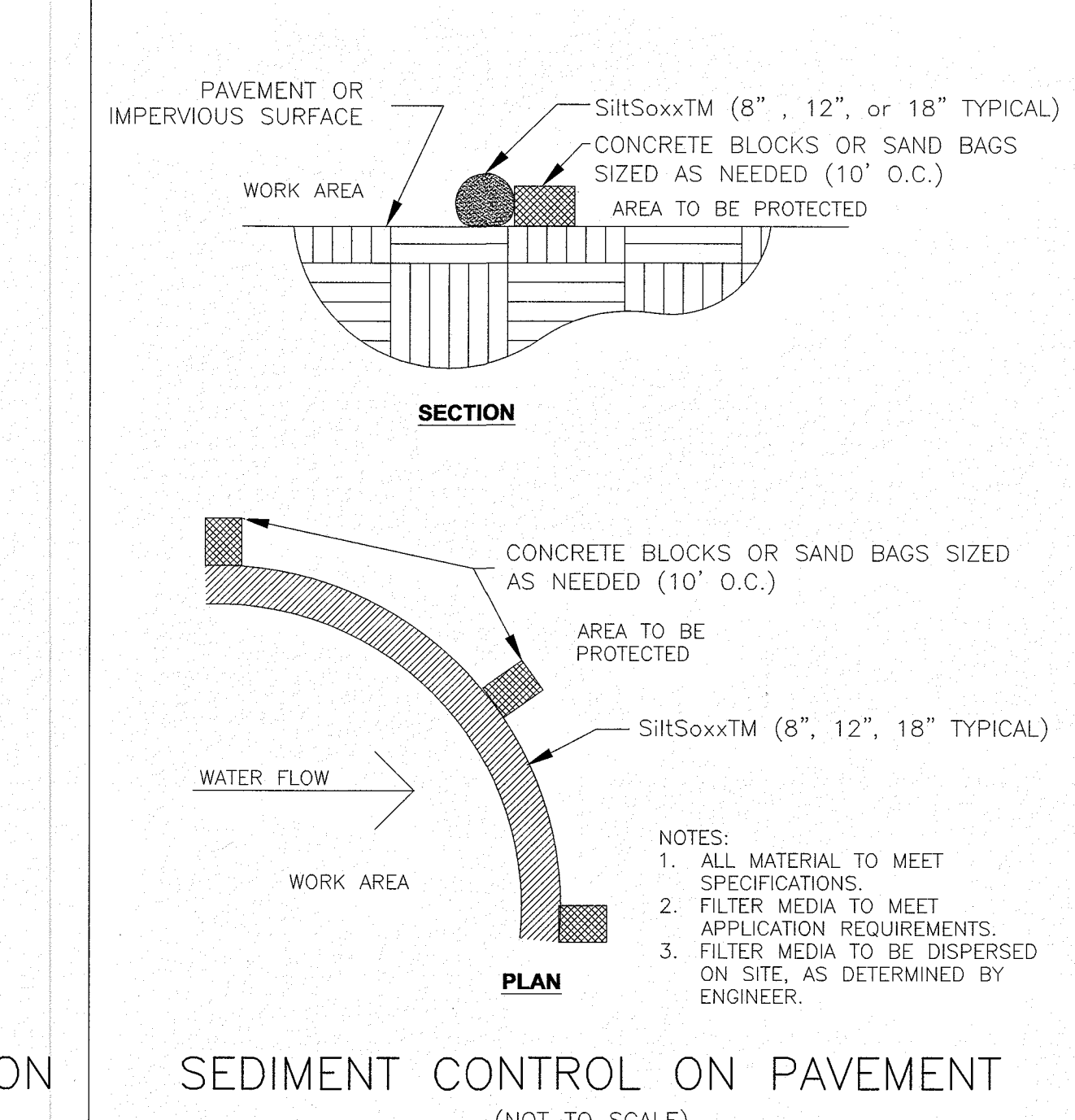
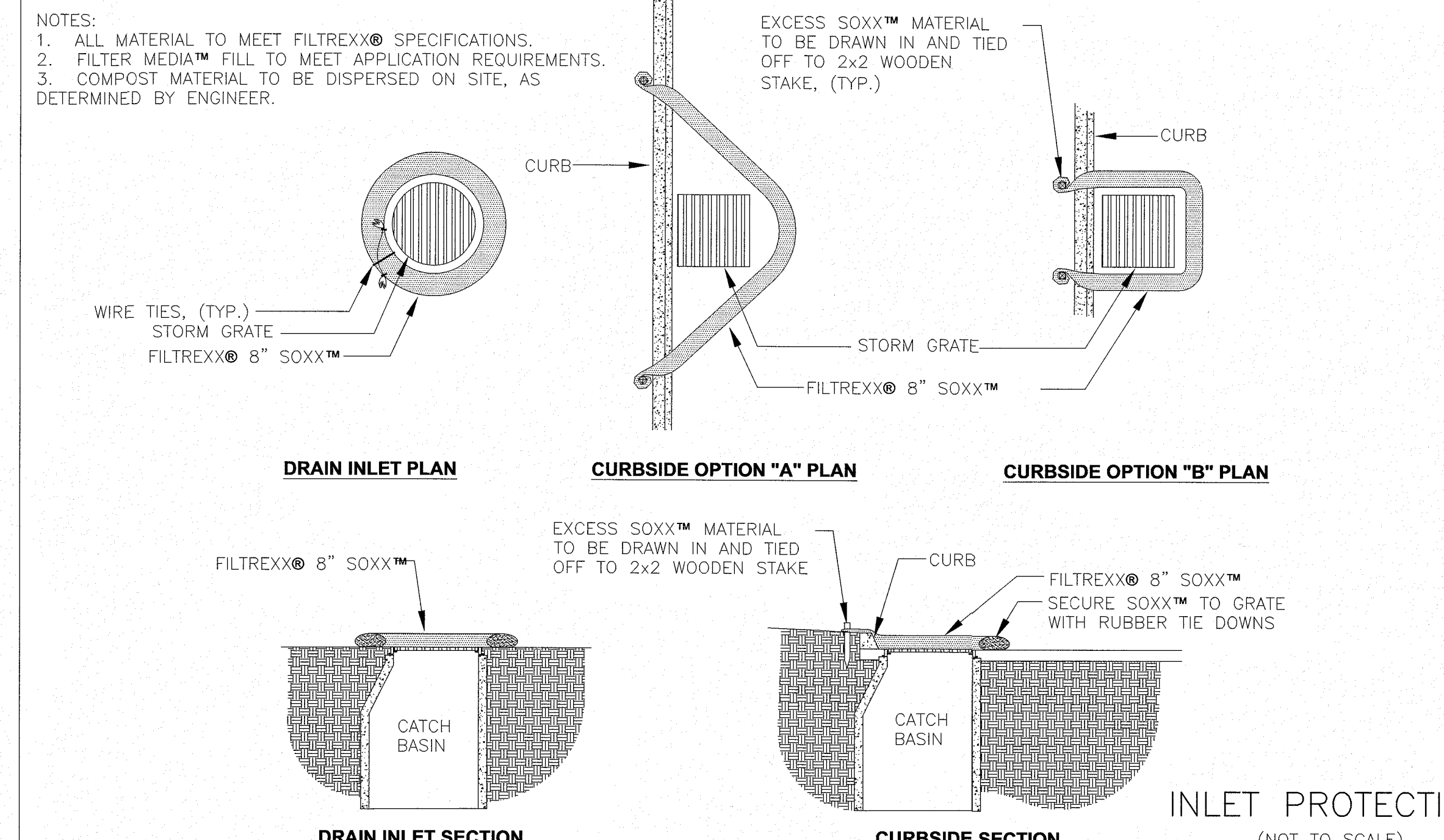

Owner:
See subdivision plan set

Applied:
HPI, LLC
23 Stiles Road, Suite 104
Salem, NH 03079

Designed By: MEM
Drawn By: MEM
Reviewed By: CPS
Project Manager: LYBF-0100
Job File Number: LYBF-0100
Drawing File Folder: LYNF100

Drawing issued for Review Only
 Drawing issued for Permit
 Drawing issued for Construction

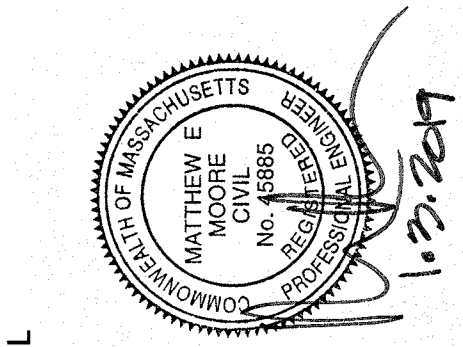

STORMWATER POLLUTION PREVENTION PLAN DETAILS
ROAD A
333, 339 & 349 SUMMER STREET, LYNNFIELD, MA

SCALE: NONE

NOVEMBER 21, 2018

DRAWING: ET.2

SHEET 2 OF 2