



2024 Street Opening Permit Application

Form# : DPWSOP2024(1/18/24)

Town of Lynnfield
Department of Public Works
55 Summer St Lynnfield, MA 01940
Phone: 781-334-9500 Fax: 781-334-9509

Permit #:	SOP-24-_____
Permit Fees	
<input type="checkbox"/> \$50.00 Fee Paid	
<input type="checkbox"/> Other Fee _____	

This permit application must be fully completed, including updated insurance certificates/bonds filed with DPW, prior to town review. No work is allowed to start until a signed permit is issued to the applicant. Fines and/or penalties may apply. **Include your email**

Date: _____ Dig-safe Number: _____

Address to be used for street opening: _____ **Lynnfield, MA**

Owner's Name: _____

Contractor's Name: _____

Contractor's Address: _____

Contractor's Point of Contact: _____ Cell: _____ **E-Mail:** _____

Proposed Work(explain): _____

- | | | |
|---|--|--|
| <input type="checkbox"/> Driveway- remove/repave/alter | <input type="checkbox"/> Underground Electrical Work | <input type="checkbox"/> Underground Telecom. Work |
| <input type="checkbox"/> Drain Connection (see DPW policy) | <input type="checkbox"/> New Water Service | <input type="checkbox"/> Emergency Water Leak Repair |
| <input type="checkbox"/> Emergency Gas Repair - Class _____ | <input type="checkbox"/> New Gas Service | <input type="checkbox"/> New/Relay Gas Main |
| <input type="checkbox"/> Other _____ | | |

Is the proposed work on Chestnut St., Essex St., Lowell St., Main St., or Summer St.(Scenic Roads)? _____

If so, does the proposed work require Planning Board approval under the Scenic Road Bylaw? _____

Start Date: _____ Expected Completion Date _____

Name of Insurer: _____ Policy Expiration: _____

Name of Surety: _____ Surety Expiration _____ Bond Amount: _____

By signing below, I acknowledge that I have read, understand and accept the Town of Lynnfield, Department of Public Works Right of Way Permit Manual, and that fines or penalties can be levied against the contractor and/or owner for failure to comply.

Signature : _____ Are You? Owner Contractor

Draw a sketch or furnish a detailed drawing showing the proposed work. Show the location and extent of the proposed work. Indicate the relationship to existing light poles, hydrants, trees, house numbers, traffic signs, etc.; show the relationship to the nearest intersection if within 50 ft. Show north arrow.

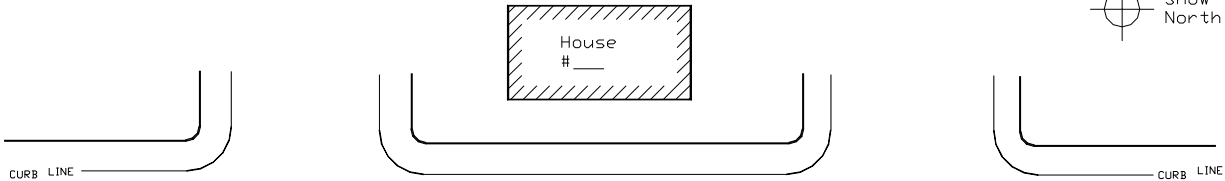

Street Name _____

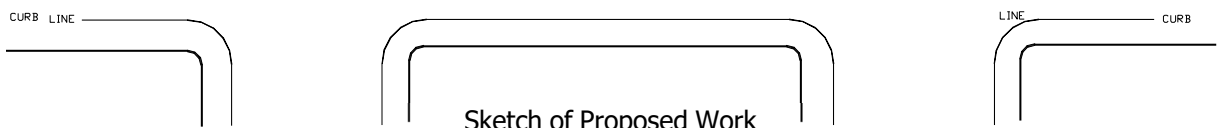

General Conditions:

Permit #: SOP-24-

Public Safety:

- No trenches shall be left open overnight.
- Sidewalks and roadways shall be kept passable at all times.
- No work is to be performed during snow emergencies and existing trenches should be secured for plowing 24 hours in advance of any snow prediction.
- Uniformed traffic officers shall be furnished as required.
- Dig-safe shall be properly notified before work proceeds.
- Properly lite barricades shall be used while work is being performed in the street

Protection of Property

- No tree roots or limbs shall be removed without further approval from the DPW Director/Tree Warden.
- Property markers such as bounds or iron pipes shall not be disturbed.
- No material or equipment is to be left on public property or within the right-of-way unless authorized.

Trench Restoration

- All work shall conform to the standards set forth in the Town of Lynnfield's Right of Way Permit Manual.
- All street cuts shall be saw cut in straight lines.
- Any bituminous curbing disturbed is to be cut out 5' on both sides of the disturbance and replaced with new bituminous curbing by machine and connected to existing curbing. New berm shall of the same style as berm installed adjacent to disturbed area.
- No bituminous paving will be permitted during actual or anticipated extreme cold and/or wet conditions.
- Any sidewalk disturbed by construction operations shall be restored over its entire width.
- All driveway aprons disturbed by longitudinal trenches shall be removed and replaced from the gutter line to the furthest limit of the excavation.
- Temporary pavement shall be placed daily and shall be brought flush with adjacent existing pavement.
- Trenches shall be permanently restored by cutting or grinding a straight clean edge 1' outside the limit of disturbance; grinding or removing the temporary pavement, scarring, or other damage that occurred during construction; and overlaying with emulsion and sand at the joints.
- Any roadway markings or street signs damaged during construction shall be restored.
- Roadway in the vicinity of the work area shall be swept daily by the contractor.

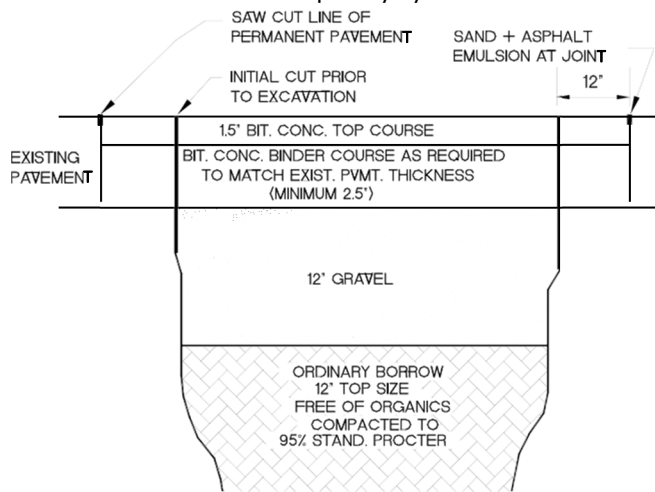

**** For Office Use Only ****

Special Conditions:

Infrared Patch by: _____ Notify DPW before Work Proceeds Inspection by DPW required before backfill

Grind and Inlay Patch by: _____ Other _____

Incomplete

Photo on File Yes Denied (see comments below)

Waive Insurance Approved for Issue

Waive Bond

Permit expires 30 days after approval unless noted below

Town Engineer Date

Permit Expires _____ _____
Field Inspector Date

Comments/Special Conditions: See attached conditions dated: _____